



User Guide

Includes:

Fitting Manual

Troubleshooter

Declaration of Conformity

Warranty Details

Service Record

Additional Information



Please keep in a safe place

Rev. 10.05.2017

TOOLS REQUIRED FOR INSTALLATION (Tools and fixings are not included)

**Philips Screwdriver and
Terminal Screwdriver**

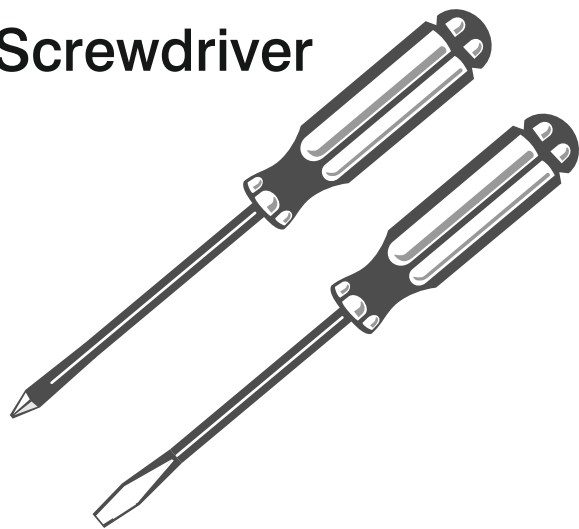

Hammer

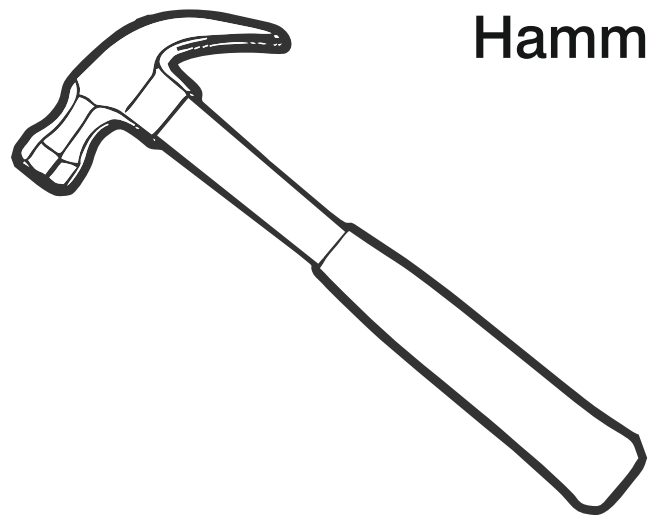

Drill

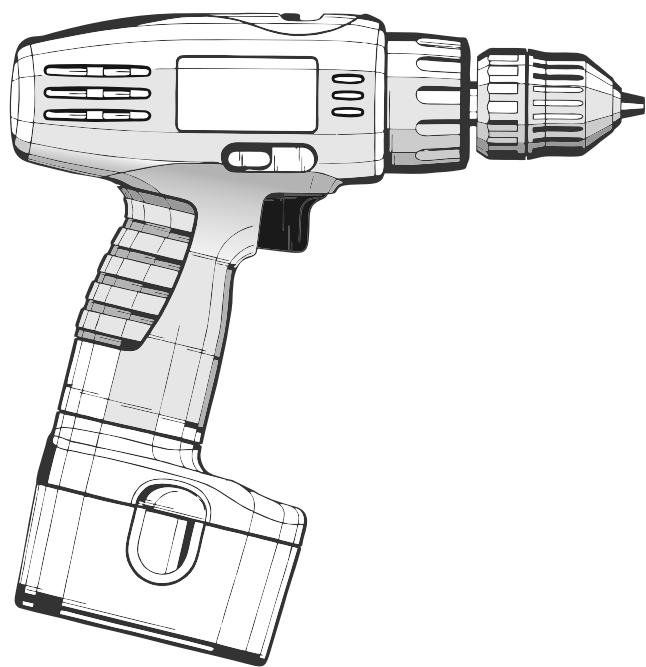

Steel Drill Bit - 5mm
Steel Drill Bit - 12,5mm
Masonry Drill Bit
(Size depends on fixings to be used)

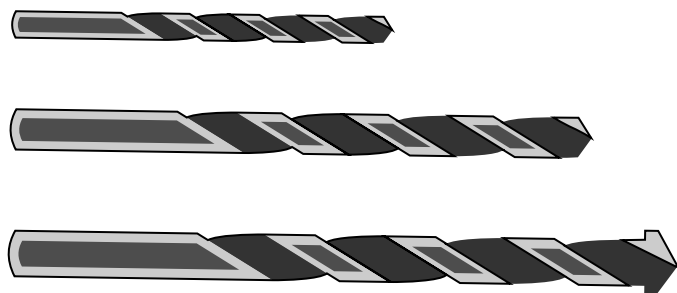

Spirit Level

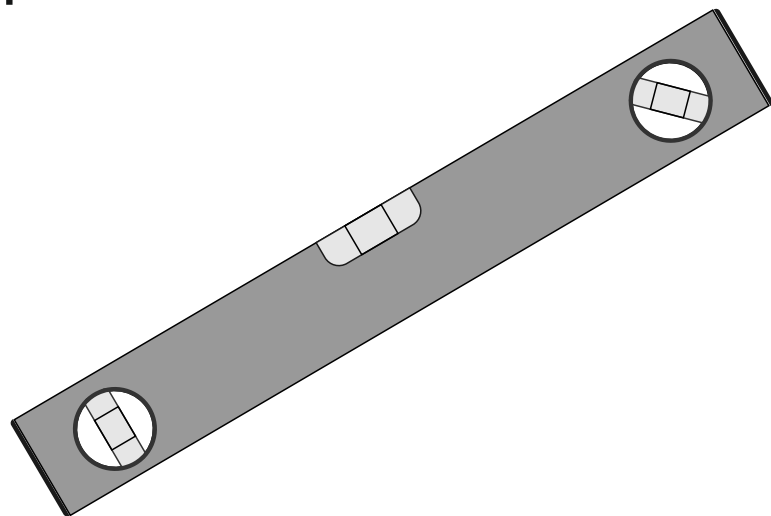

Fixings
(Depending on the material you are fixing to)

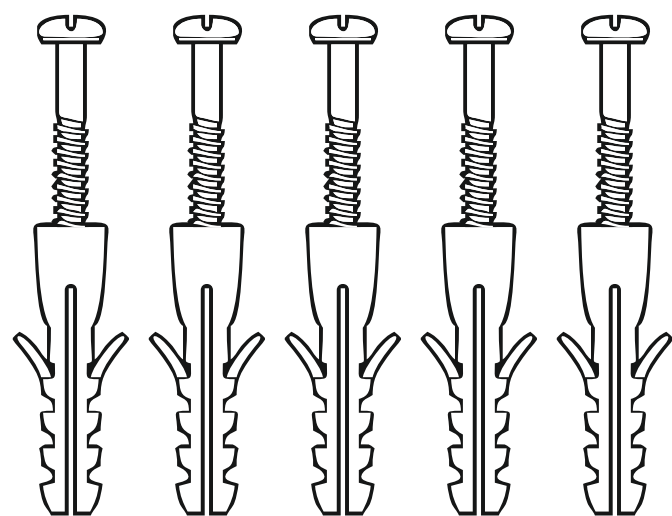

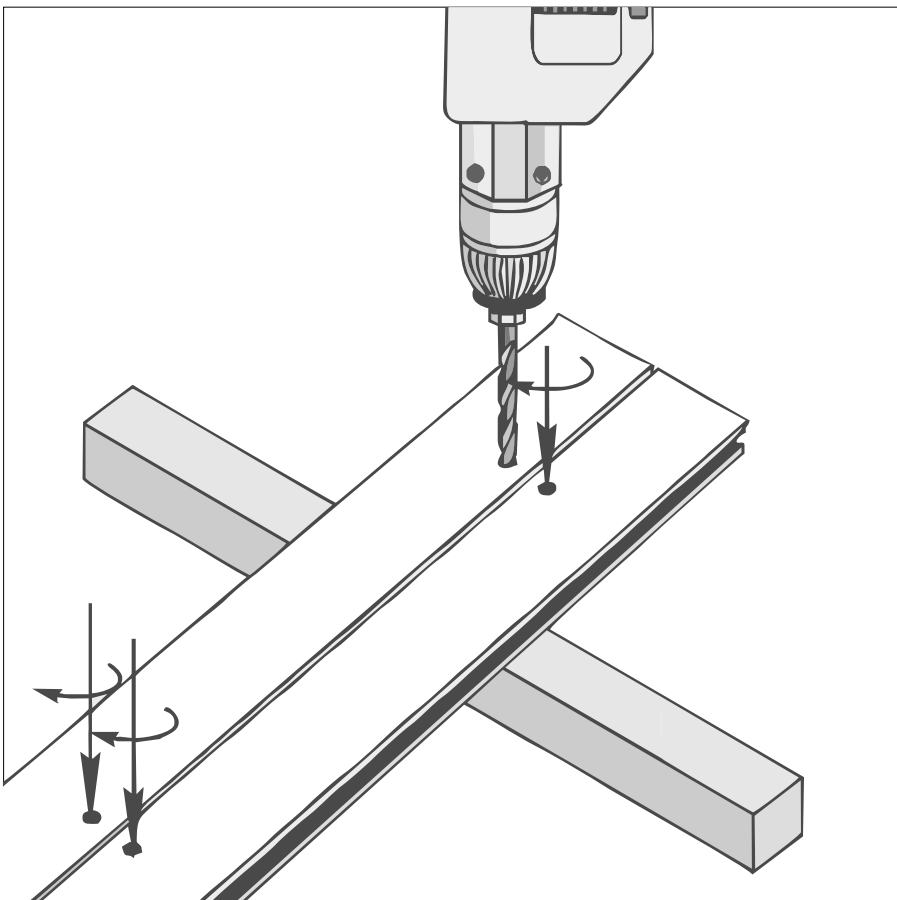

pic. 1

Pilot drill tracks with 5mm drill bit. All the way through
Ensure the brush strips are crimped in the top and bottom of each guide and cannot slide out.

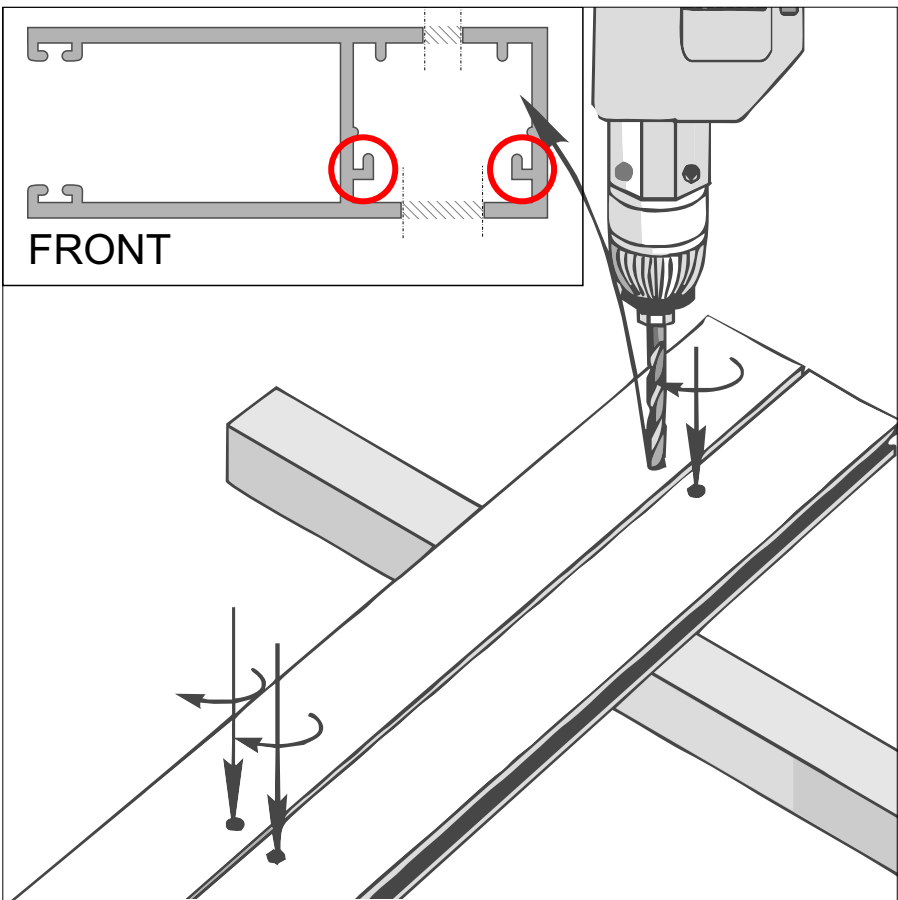

Drill face of track with 12.5mm drill bit.
WARNING! Do not drill all the way through.

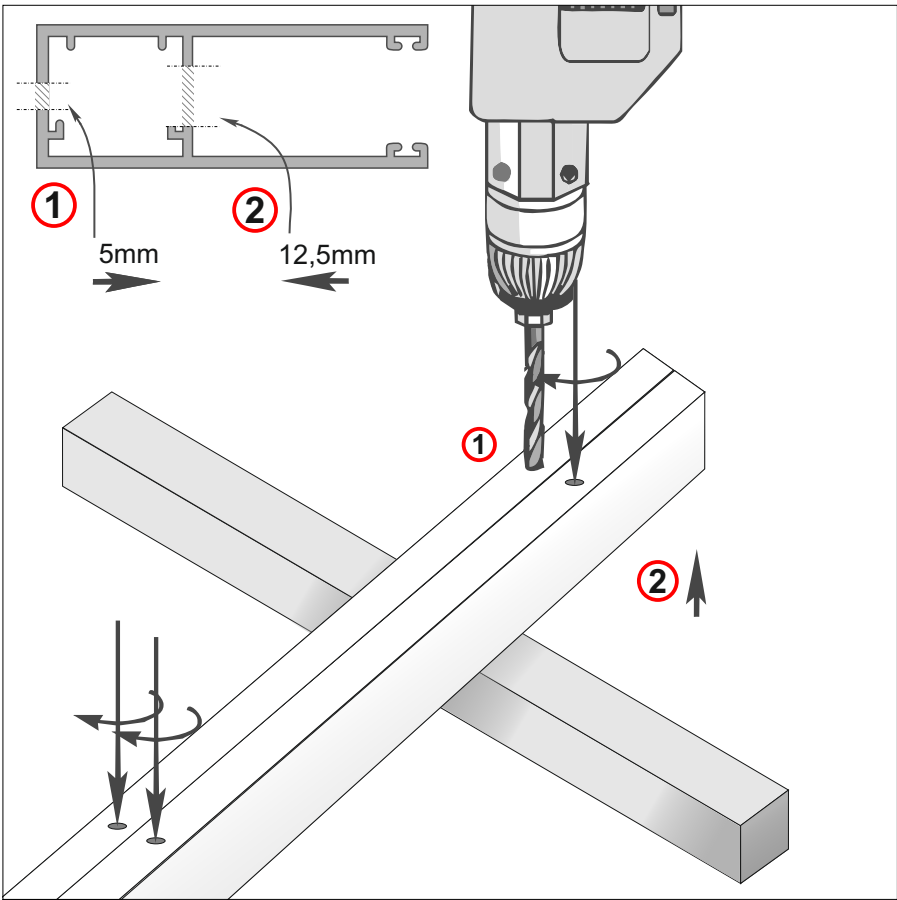

pic. 3

If in between fit drill 5 mm all way through
 5mm then 12,5 mm half way as shown.

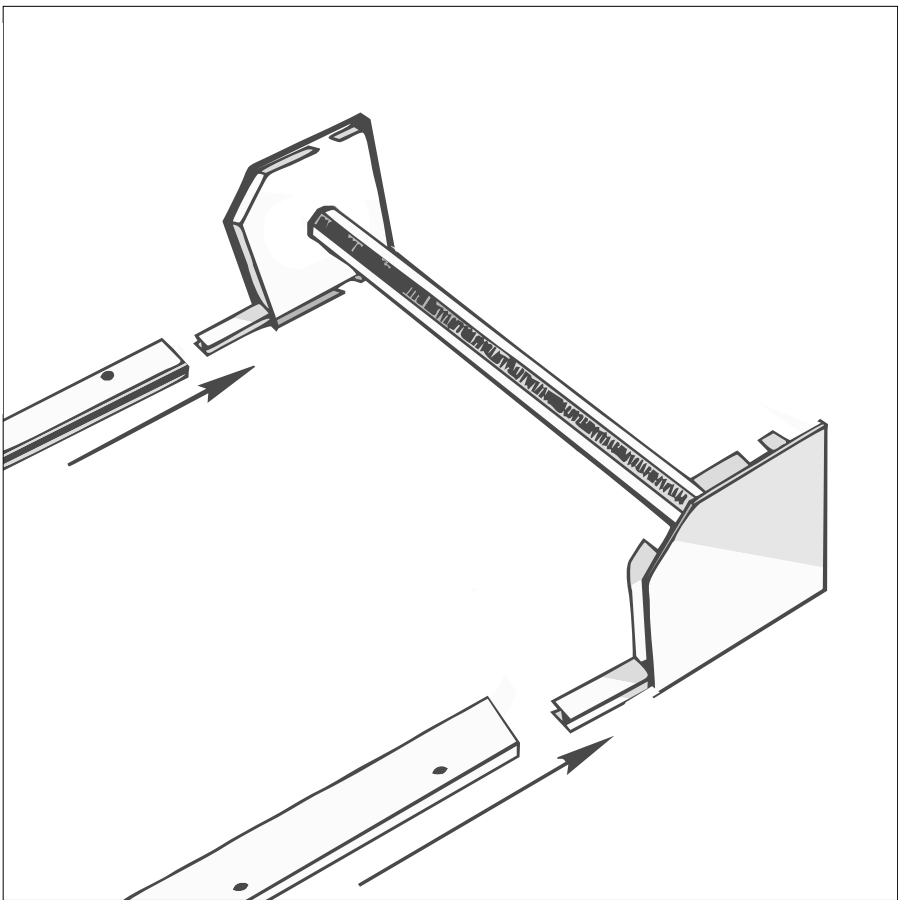

pic. 4

Slide guides onto the end plates as shown

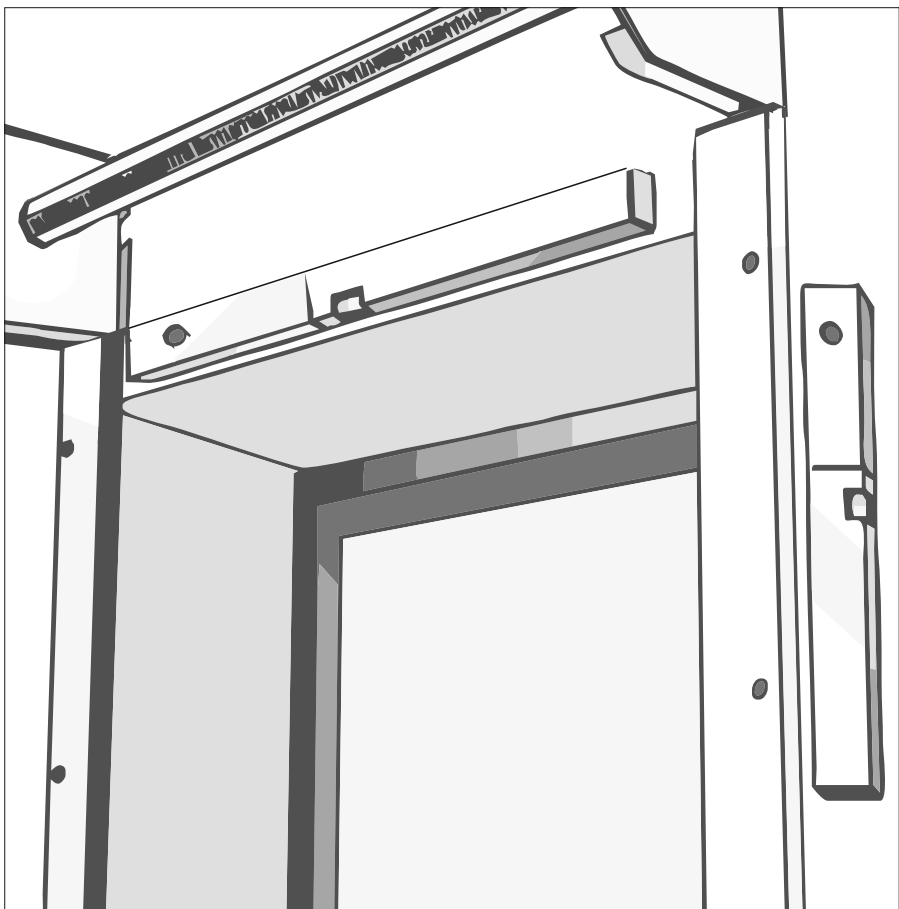

pic. 5

Mark out and position the guides. Plumb sides and top.

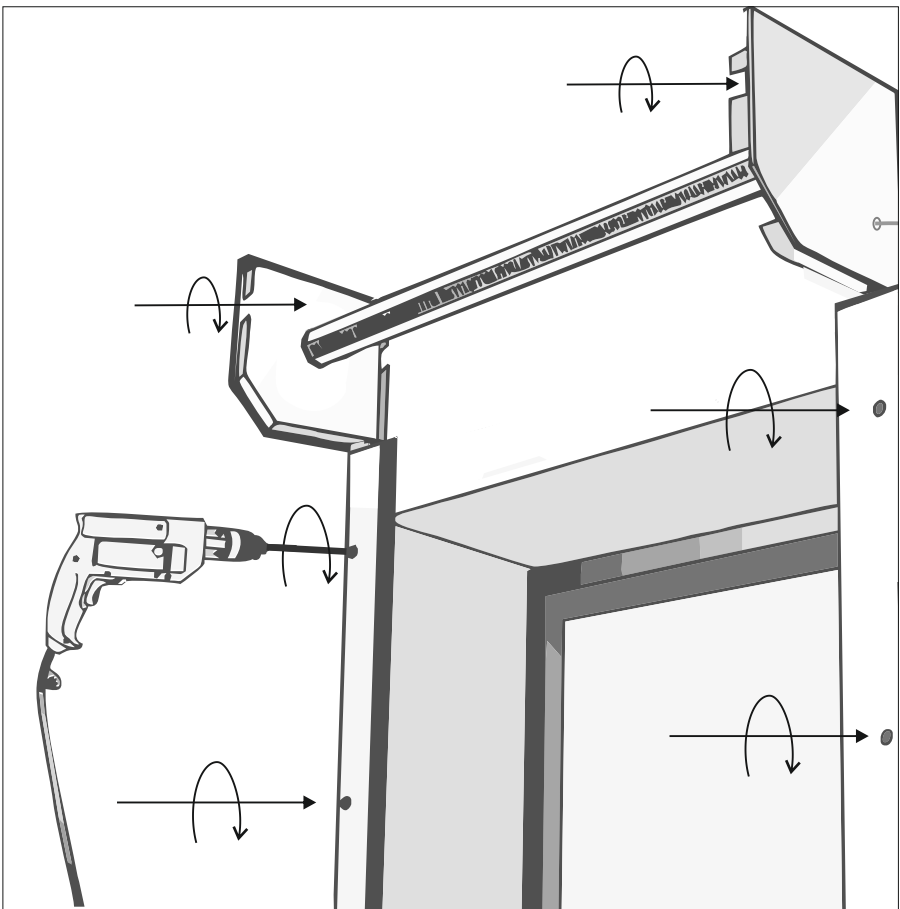

pic. 6

Fix the guides to the wall with appropriate fixings. Make sure a fixing point is made at the top of the end plates.

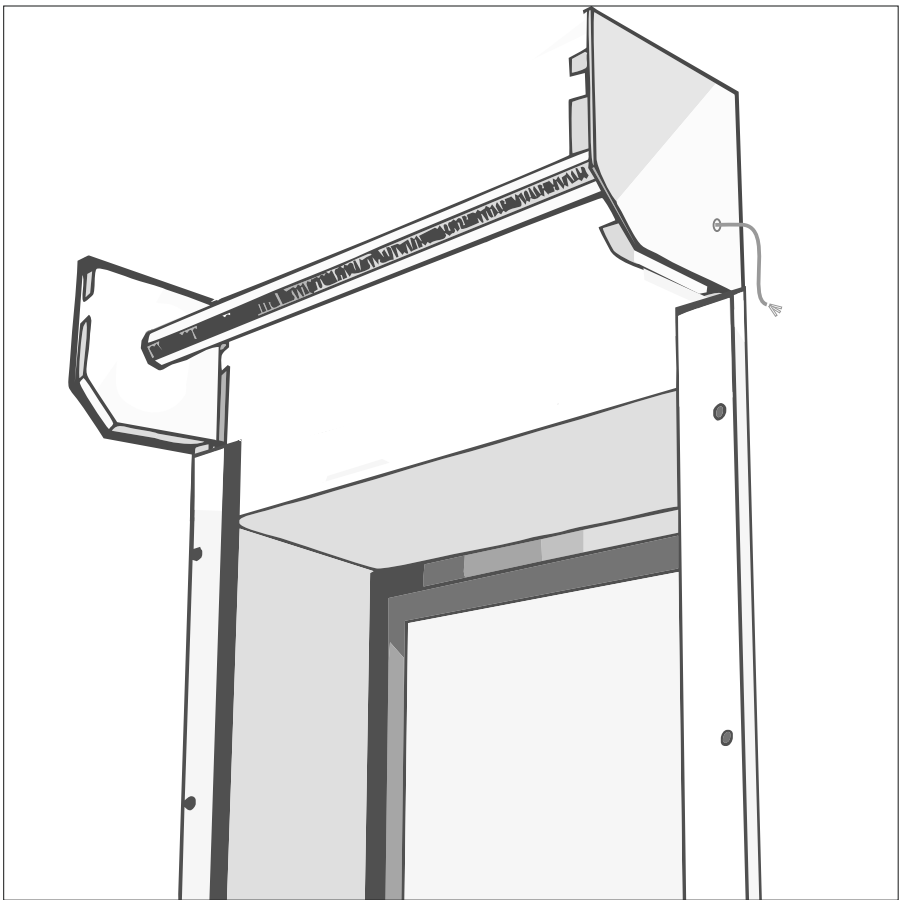

pic. 7

Fix the barrel to the end plates feed the motor cable through the grommet drilled out in the end plate.

(This diagram shows right hand side motor)

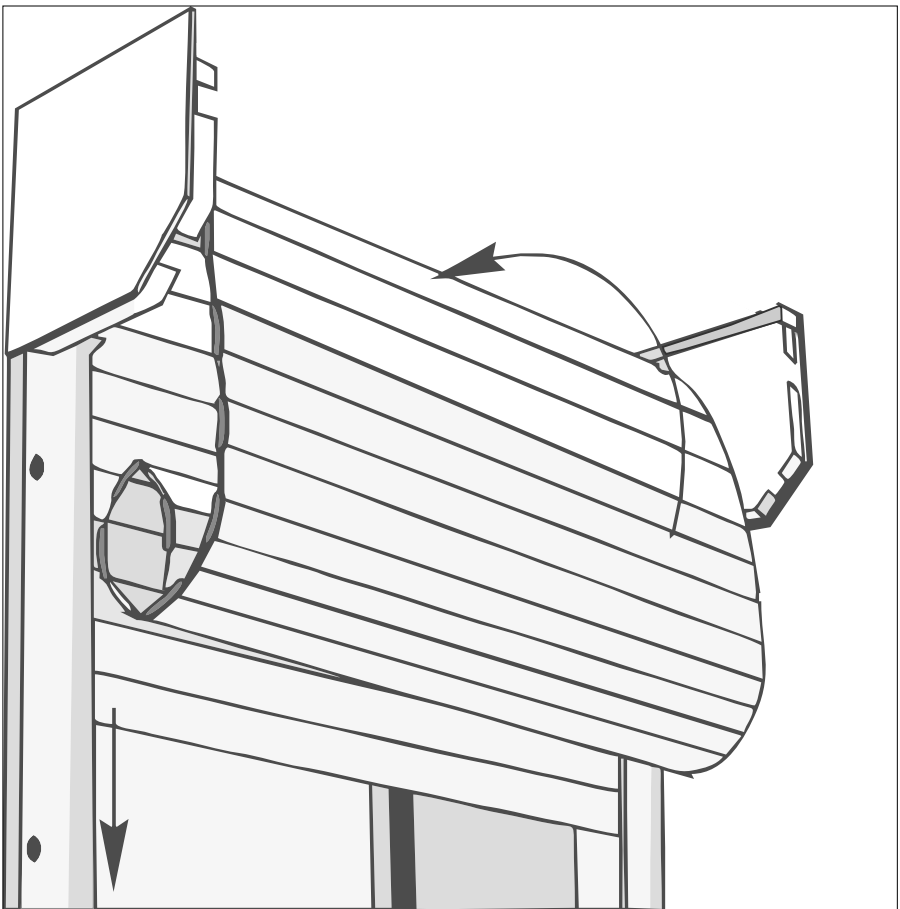

pic. 8

Carefully feed the curtain into the tracks. Over the top of the barrel.

WARNING! Risk of material damage. Use bubble wrap or similar around the barrel to protect the curtain.

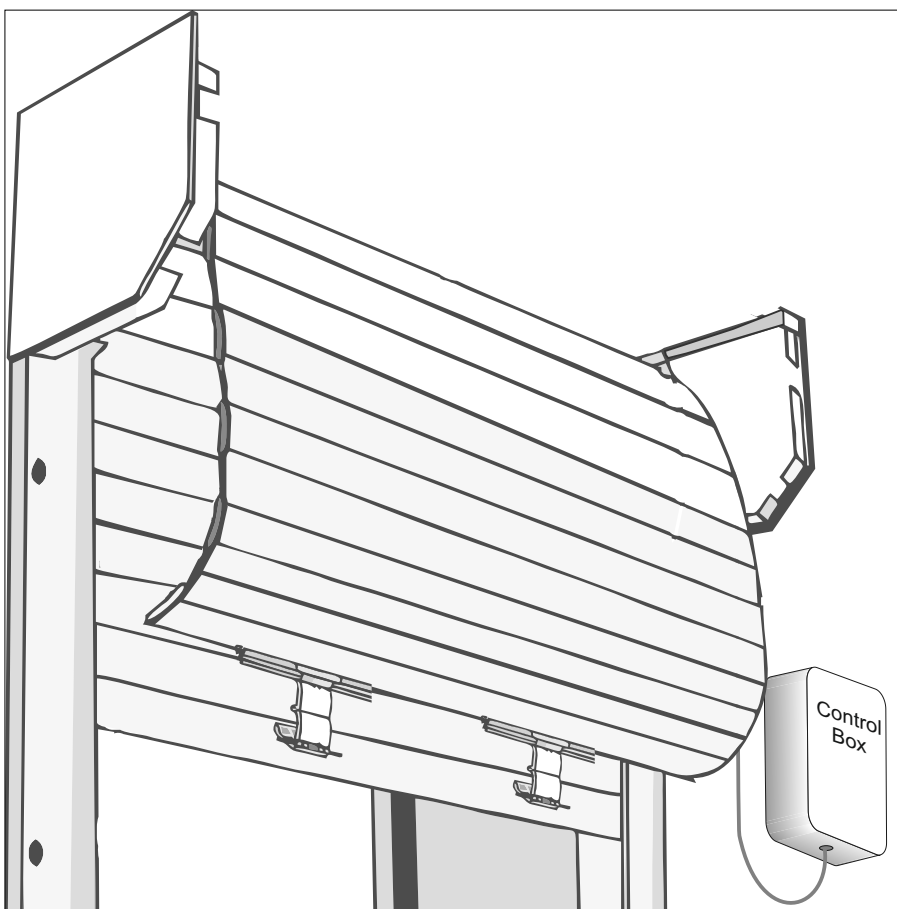

pic. 9

First wire the motor and control box.
For wiring see separate wiring diagrams.

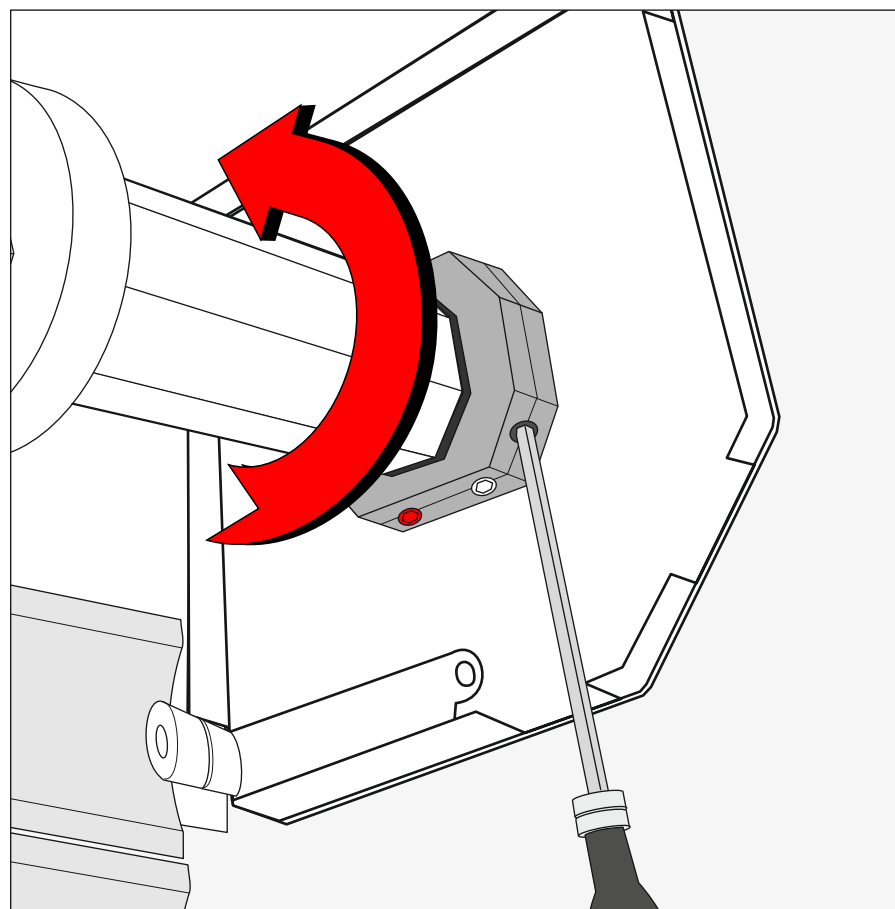

pic. 10

Before attaching the curtain you must tension the spring by using the motor. Send the motor down so the barrel rotates .
You may need to adjust the bottom limit to reach the correct number of turns.

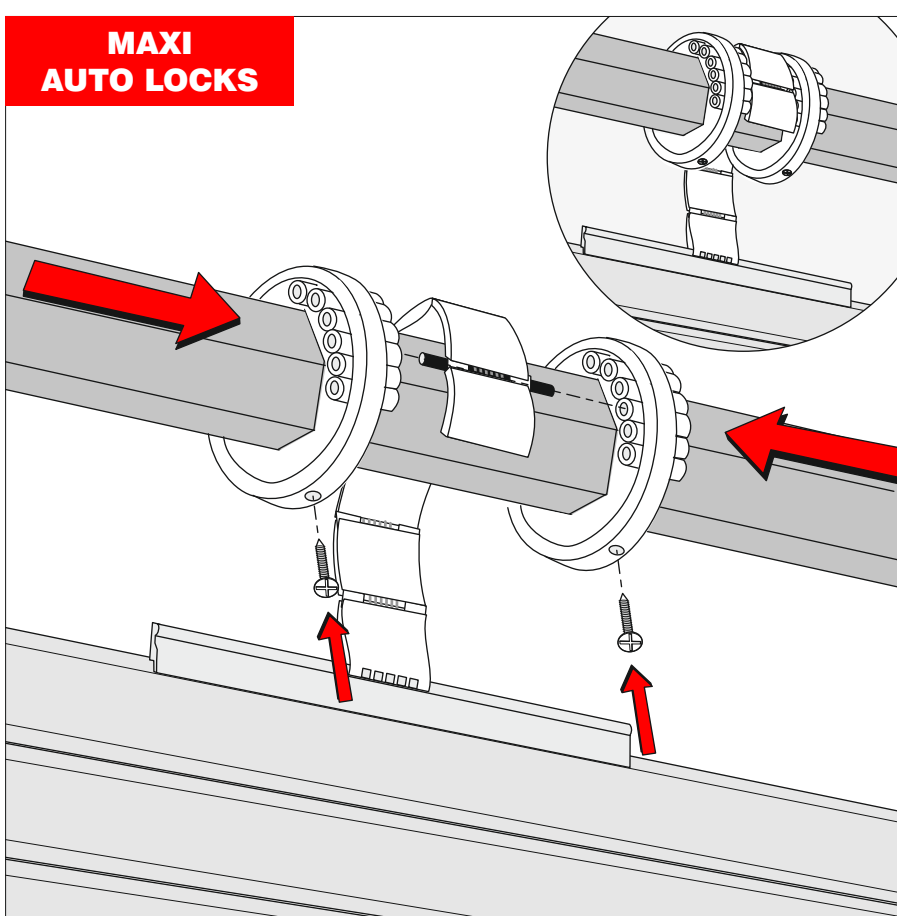

pic. 11

Use pre-drilled/punched holes in barrel.

Once the tension has been added you will have reached the bottom limit.
The curtain can now be attached (**see pic11**)

Slide the rings over the autolocks as shown.
When fixing the ring screws to the barrel, the screws should go through the pre-drilled 3mm holes to ensure no movement from the rings.
Failure to do this will result in the rings moving apart and the autolocks breaking. The top limit must now be set.

***Please note - The Classic Mini types will have the curtain already assembled in the shutter box. The Barrel will also be pre-tensioned.**

**** On some shutters, springs may not be fitted to assist the motor. Proceed straight to setting limits (page 6 pic.14)**

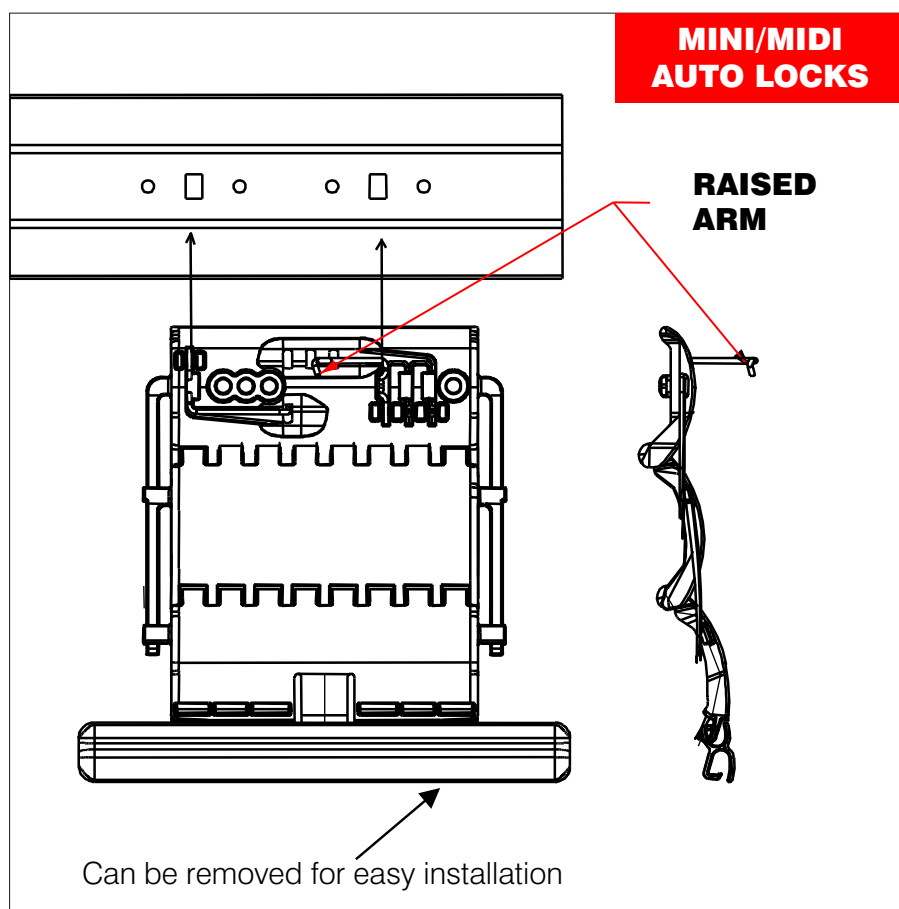

pic.12

- 1) Pull the metal arms on the front of the strap out towards you
- 2) Slide the strap along the top rail so that the metal lugs on the back of the strap line up with the square on the tube (see diagram)
- 3) Locate the metal lugs inside the square holes on the tube
- 4) Push the metal arms back so they are flat and clip into place
- 5) The metal lugs will now be hooked inside and secured to the tube

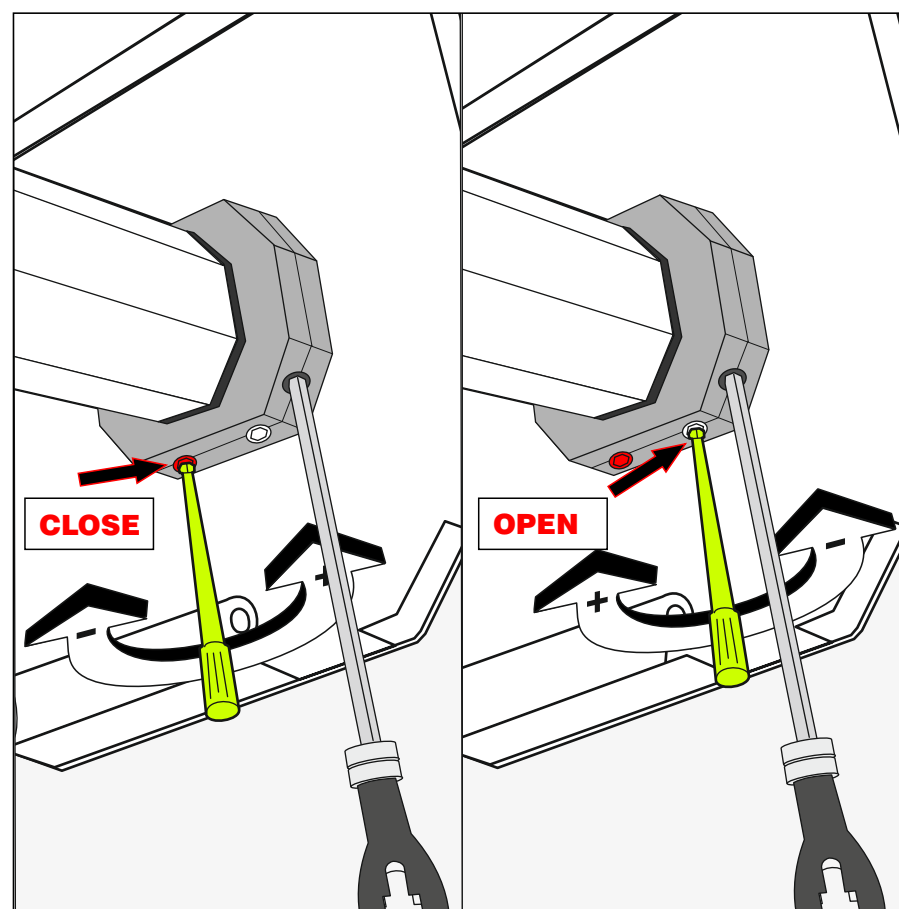

pic.13

PLEASE NOTE: For left hand motor, the limit switches will be the opposite way around. For reference the "+" direction increases the travel of the door and the "-" direction decreases the door travel.

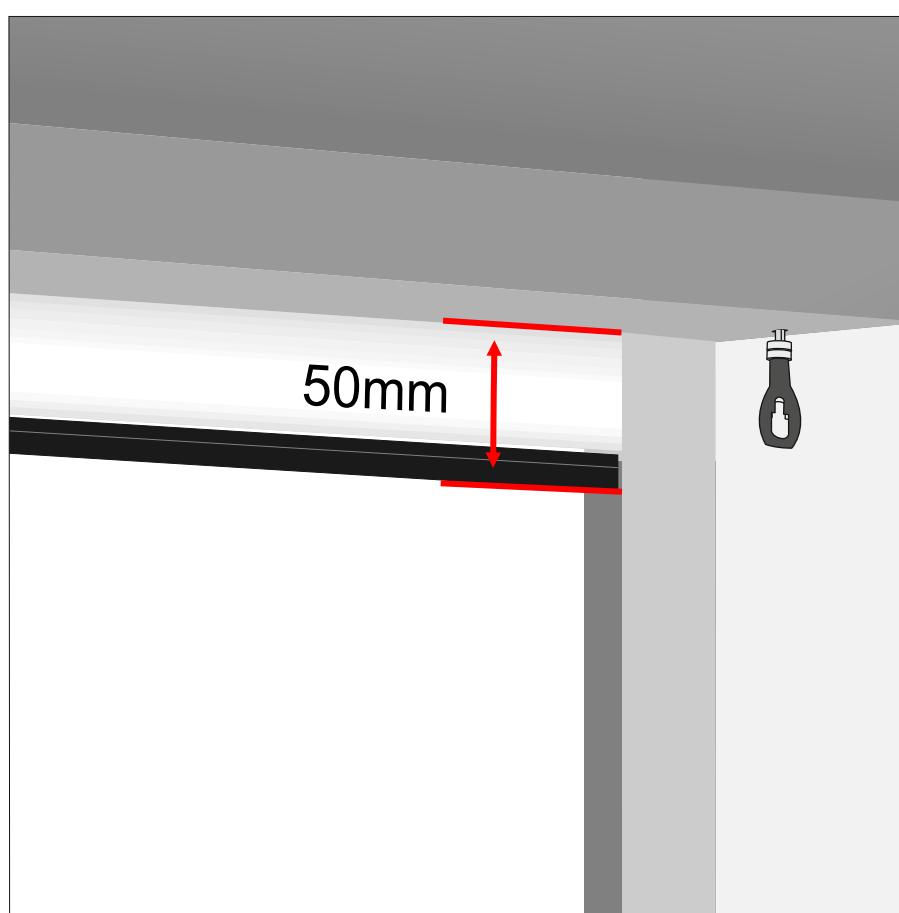

pic.14

Set the up limit so that the bottom rail is at least 50mm into the side guides.

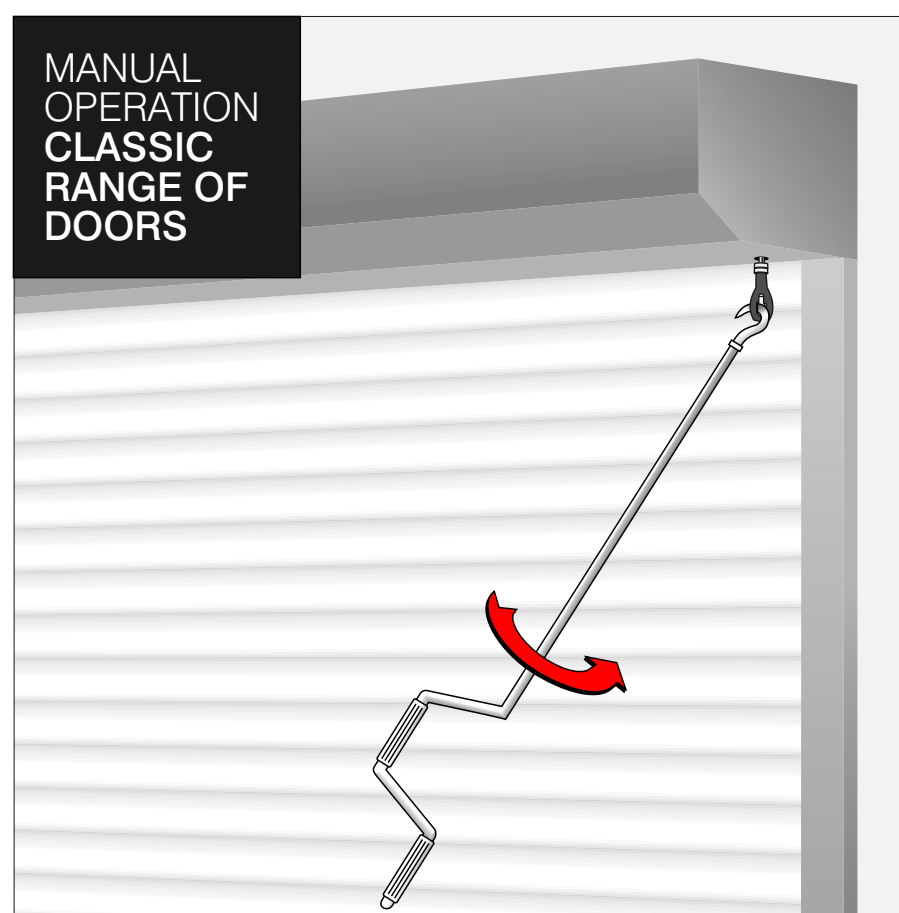

pic. 15

For use with traditional tube motor.

Wind the crank handle to open the door in event of a power cut.

**IF USING A DOOR MONITORING SYSTEM -
THE MOTOR MUST BE LEFT TO COOL FOR 15
MINUTES BEFORE SETTING UP.**

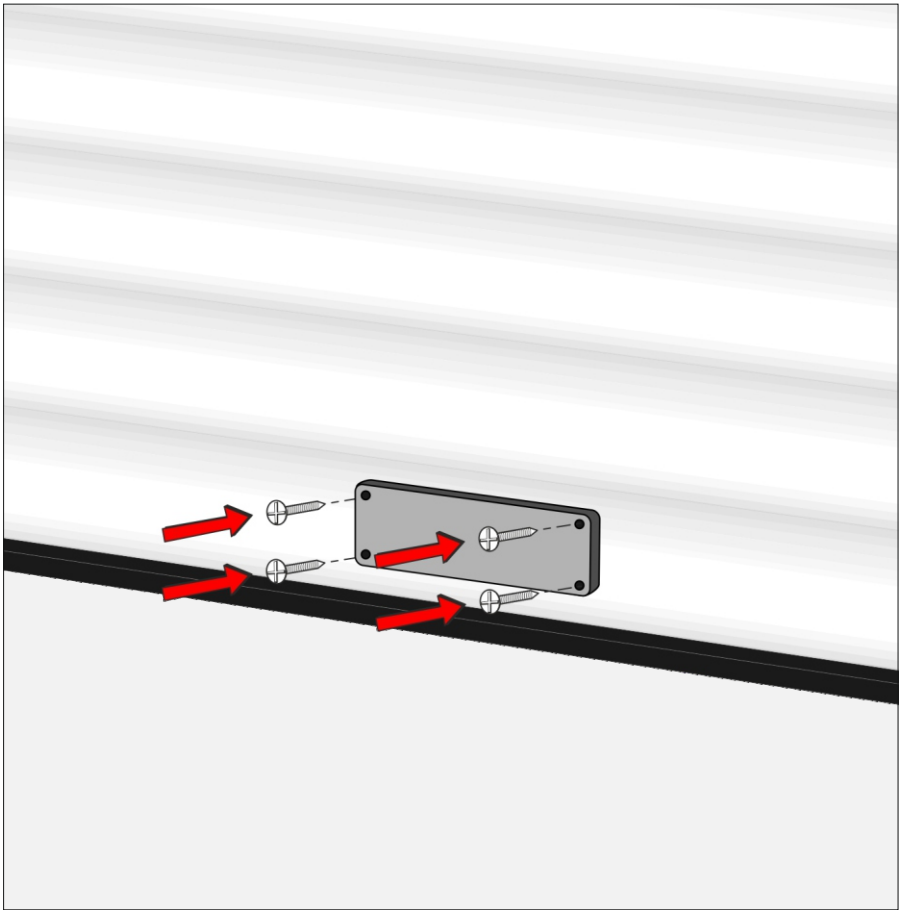

pic. 16

Now fit the Door Monitoring System sensor to the bottom of the door (bottom lath). Programme the control box - see page 8.
Installation of control unit - Please see separate diagram (inside box with control unit)

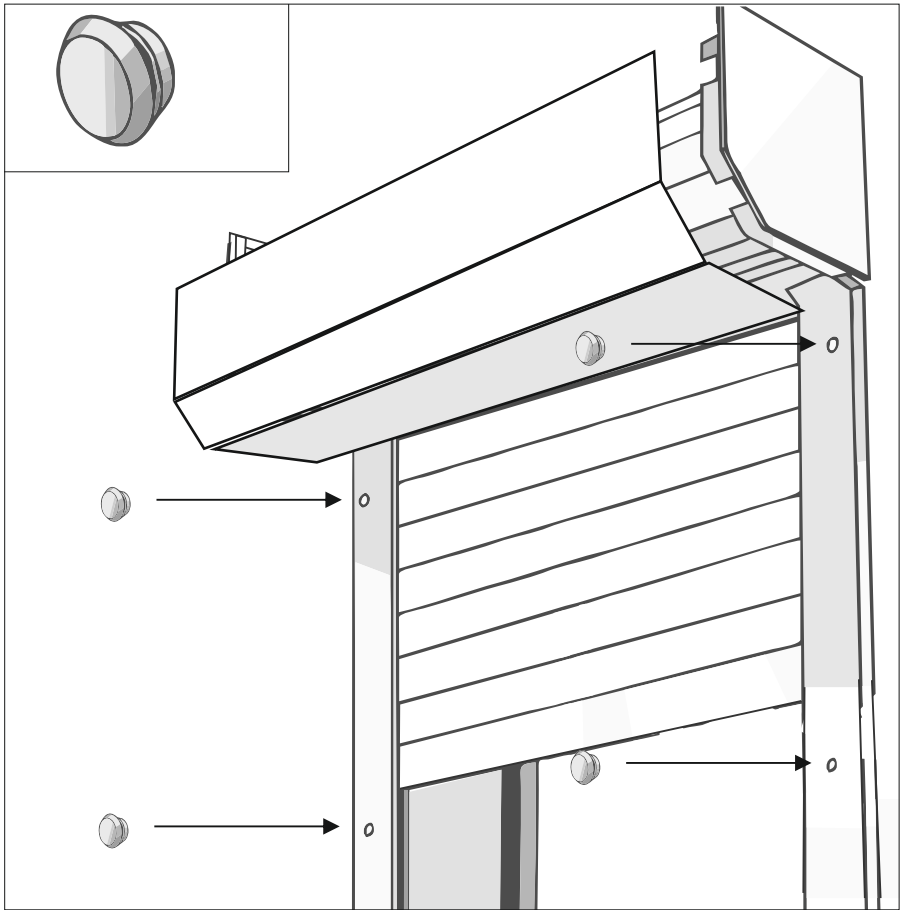

pic. 17

Fit the white bungs and fit the cover (optional - only with fully boxed option).

Please Note: to comply with CE regulations our Remote control roller door range must be set in mode "Deadman-Hold to Close" unless Door Monitor System fitted. Our doors are set to this by default and cannot be altered.

IMPORTANT TO THE OPERATION FOR BIRKDALE ROLLER SHUTTER CO. LTD PRODUCTS

WARNING

Repairs and adjustments should only be performed by Birkdale Manufacturing Group Ltd personnel

DO NOT REMOVE, PAINT OVER OR CONCEAL OVER THIS NOTE

Birkdale Manufacturing Group Ltd,
Unit 5, Eastgate Park, Arkwright Way, Queensway Industrial Estate Scunthorpe, North Lincolnshire, DN16 1AE, TEL: +44 (0)1724 282171, FAX: +44 (0)1724 282170
Year of manufacture 2017 En 13241-1:2003+A1:2011
POWER OPERATED DOOR EXCELSIOR

DANGEROUS SUBSTANCES	None
RESISTANCE TO WIND LOAD	2
SAFE OPENING	Pass
OPERATIONAL FORCES	Pass
MECHANICAL RESISTANCE AND STABILITY	Pass
DEFINITION OF GEOMETRY	Pass

Type testing conducted by Warrington APT 1104, Exova Warrington Fire, Key industrial Estate, Fernside Road, Willenhall, WV13 3YA

Serial No.

PLEASE READ THE LABELS ON THE BACK OF THE DOOR BEFORE OPERATING. THESE ARE COPIED HERE FOR FURTHER REFERENCE.

1. In the interest of your safety and others, this door must be operated by users familiar with its operation.
2. When operating the door do not place fingers near or in guides or another moving parts at any time.
3. The person operating the door must have it in sight at all times during this operation particularly if it is in automatic operation.
4. Do not permit children to play with the garage door or electrical controls.
5. Do not attach any objects to , or make any modifications to the doors as this may cause damage and/or physical injury.
6. Operate the door only when free from obstruction.
7. Should the door become difficult to operate or completely inoperable, call a Birkdale technician. Repairs and adjustments should only be undertaken by qualified person.
8. Every 6 months check and tighten any loose fixings.
9. Periodically clean your door with warm water, allow to dry naturally.
Do not use abrasive or caustic based cleaners. Bird droppings are caustic please remove upon detection.
10. Your new garage door needs an annual service by a competent person to maintain the CE mark.
11. Do not operate door in extreme cold temperatures. Make sure door is free of ice before operating.

pic. 18

IMPORTANT INSTRUCTIONS FOR SETTING UP THE NEW 'KEYROLL' TYPE CONTROL UNIT

*** PLEASE ENSURE THE LIMITS ON THE MOTOR ARE SET CORRECTLY AND THE DOOR IS RUNNING SMOOTHLY**
*** LEAVE THE MOTOR TO COOL FOR AT LEAST 15 MINUTES AFTER SETTING THE LIMITS BEFORE PROGRAMMING THE DOOR MONITORING SYSTEM OR RISK THE MOTOR CUTTING OUT ON THE THERMAL OVERLOAD**

IMPORTANT INSTRUCTIONS DURING SET-UP

1. Set limits to required final position before any programming of the safety edge - dip switch '1' for dead man mode to assist
2. Ensure door is in good working order. Check guide rollers are in correct position and fixed tight
3. Fix the safety edge transmitter to the bottom rail using the pre-drilled holes
4. Adjust sensitivity in the safety edge transmitter to number '3' - this is done on the small dial (0-9). Remove the plastic protection from the batteries.
5. Ensure door is in the fully closed position
6. Turn off 'dead man mode' (dip switch '1')
7. Programme the transmitter to the receiver - press and hold the Red button in the control unit until you here '1' "beep" then press the prog button on the bottom rail transmitter until you here '1' beep. Wait until you hear '2' "beeps", pairing is now complete.
8. Start the setup process - Press and hold the Red button in the control unit until you hear '1' beep and let go.
9. Press ⬆ button on the front of the control. The door will now start a set-up process going up and down automatically.
10. The door will go up a few inches then stop and go back down, it will then go all the way to the top and stop. The door will now close, then return to the top, then start to close for the final time. When the door is around 50mm off the floor you will need to press the ⬆ button once more (do not hold). **The set-up is complete. Please see section at the bottom of the page marked '*'**.
11. When the red 'led' goes out the setup is complete

WIRING INSTRUCTIONS

Mains Power:

N - Neutral/Blue

L - Live/Brown

Earth - connect together with earth from motor in plastic connector

Motor:

U - up/down or black/brown

V - up/down or black/brown

W[c] - Neutral/Blue

Earth - connect together with earth from mains power in plastic connector

PROGRAMMING HANDSETS

1. Press and hold the Ⓢ button on the front of the control unit it beeps once, then let go.
2. Press transmitter button to be used until you here '1' beep
3. Press the Ⓢ button on the front of the control unit once more and it will beep twice. Pairing is now complete.
4. Repeat process for extra handsets.

Adjusting sensitivity - If the door monitoring system is not sensitive enough, this can be adjusted using the small dial in the transmitter. '0' being the most sensitive and '9' being the least sensitive. Alter the dial and repeat step '7' to adjust the sensitivity.

'*' Switching off the door monitoring at a certain point - When a door has a spring assisted barrel, this can cause the door to 'jump' on the way down, this is because the spring is tensioning as the door is operating. The largest 'jumping' effect of the door will be from around 50mm off the floor as this is when the tension is at it's greatest, this can cause the door monitoring system to activate thus stopping the door and returning it to the open position. On the final cycle of the setup process (as the door is returning to the bottom for the final time) press the 'start' button once when the door is 50mm of the floor, this will switch off the door monitoring from this point on each operation of the door.

Fault finding.

The control unit is beeping '4 times' - The batteries need replacing in the transmitter which is fitted to the back of the bottom rail. 2 x 'AA' batteries will be required.

When the motor is installed correctly and when testing nothing works - please check the electrical supply to the control unit.

If the limits cannot be found ensure you have been adjusting the limits in the correct direction of the arrows adjacent to the adjuster screws.

If the motor is running in the wrong direction - This can be reversed by changing the position of the brown and black Wires.

After short time door does not work - After a short time the door will not operate in either direction. The motor must be allowed to cool as the thermal overload has tripped. The door will operate after about 20 mins. The average operating time for the motors is 4 mins, this means that the motor can be run continuously for 4 mins in every 10mins.

The motor only moves in one direction - This could be that the direction limit switch is made, back off this limit and the motor will run.

Door will not close or keeps reversing to the top

Check the batteries inside the door monitoring system transmitter (fixed on the back of the bottom rail)

Check the photocell is correctly aligned with the reflector

Door will not operate from the handset

Check battery inside the handset

The door not will not operate and there are no lights on the control unit

Check the power supply to the control unit

There are 4 beeps coming from the control unit

The batteries need replacing in the door monitoring system transmitter (fixed on the back of the bottom rail)

Door closes to the bottom but immediately re-opens

Sweep the floor and check there are no obstructions - see step II '*' section

**CE DECLARATION OF CONFORMITY
(ELECTRICALLY OPERATED DOOR - SUPPLY ONLY)**

DOOR TYPE: Birkdale

DESIGNED, MANUFACTURED & SUPPLIED BY:

Birkdale Manufacturing Group Ltd
Unit 5, Eastgate Park, Arkwright Way
Queensway Industrial Estate
Scunthorpe
North Lincolnshire
DN16 1AE

The above product has been designed and manufactured in accordance with the component supplier's instructions. The design and manufacture were undertaken at the Birkdale Manufacturing Group Ltd, address shown above. All relevant documents, specifications, test reports and certificates are included in the manufacturer's technical construction file.

The above product is in conformity with the essential Health and Safety requirements of The Supply of Machinery (Safety) Regulations 2008 (SMR). The Construction Products Regulation 2011 – EU No. 305/2011 (CPR).

As appropriate, the transposed Harmonised Standard and National Standards used in the design of the above are as follows: -
BS EN 13241-1:2003 + A1:2011

The CE marking is consistent with the Directive 93/68/EC.

DECLARATION MADE BY:

Managing Director M. Shrimpton

DATE:01/06/2011

ON BEHALF OF: BIRKDALE MANUFACTURING GROUP LTD
UNIT 5, EASTGATE PARK, ARKWRIGHT WAY
QUEENSWAY INDUSTRIAL ESTATE
SCUNTHORPE
NORTH LINCOLNSHIRE
DN16 1AE

EC DECLARATION OF CONFORMITY
(To be completed by installer)

Product (please tick): ☐ Excelsior, ☐ Classic, ☐ Roller Shutter

Model Type (please tick): ☐ Mini, ☐ Midi, ☐ Maxi, ☐

Other (please state): _____

Unique Serial No. (on back of door) _____

Door Size: _____

Manufactured By BIRKDALE _____

☐ Remote Control in Deadman, ☐ Single Pulse, ☐ Monitored

The above product and/or operator have been assembled, installed, connected and tested in accordance with the manufacturers installation instructions at the following site address and accordingly is in conformity with the provisions of the EC Machinery-Directive 2006/42/EC, EC Construction Product Directive 89/106/EEC, EC Low-Voltage Directive 2006/95 EEC. EC Directive on Electromagnetic Compatibility 2004/108 EEC.

Site Address: _____

Declaration made by (Signature) _____

(Print Name) _____ On (Date) _____

On behalf of M. Shrimpton

(Company Address) _____

Declaration Received By: _____ Date _____

Print Name: _____

YOUR WARRANTY

All products are independently tested to the highest standards and are certified to the high safety requirements and performance characteristics of European Standard 13241-1. You can, therefore, be confident that your purchase of a Birkdale product is a safe investment. Guarantee Birkdale offers the following warranty for garage door and garage door automation products:

1. Summary (subject to the terms and conditions outlined in sections 2-7 below):

- Free One Year Parts and Labour Guarantee
- Thereafter Parts only Guarantee
- All functional parts are guaranteed for a minimum of 1 year. We only ask that these are fitted by our engineers. During the first year, our engineer's time and labour are free. The guarantee does not include items which are consumable such as Batteries, fuses or light bulbs.
- 5 years Safe and reliable operation (for use up to 5 open and closing cycles per day)
- 5 years Integrity of the door panel(s) / curtain
- 5 years Panel corrosion (inside and out)
- 5 years All immoveable frame parts
- 7 years Motor and mechanical parts
- 2 years Operator control unit (5 years if Door Monitor System is used)
- 2 years All mechanical elements of the doors, including rollers and springs (5 years if Door Monitor System is used)
- 2 years All remote control parts (5 years if Door Monitor System is used) (excluding batteries, bulbs and fuses)
- 2 years All remote control Accessories
- 1 year Warranty on all commercial applications unless otherwise agreed (maintenance agreement).

2. REQUIREMENTS

The warranty only covers damage to the purchased garage door or garage door operator. The fully completed warranty card/service record (to be updated annually), together with receipt of purchase, correspondingly substantiates your right to claim under warranty. Warranty claims are only accepted in the country where the garage door/operator was purchased. The product must have been purchased through our authorised distribution channels. If installed by a dealer/contractor not of Birkdale direct employment then consequential costs for installation and de-installation, inspection of parts, transport and postage costs will not be accepted by Birkdale. Replacement parts are chargeable and credited on return of proven faulty goods.

3. PERFORMANCE

During the warranty period we undertake to rectify any and all defects to the Birkdale product which can be proved to be attributed to a material or manufacturing fault. We promise, at our discretion, to either exchange the defective merchandise, repair or allow a reduction in price. Replacement parts remain our property.

4. THIS WARRANTY DOES NOT COVER DAMAGE CAUSED BY

- Improper installation and negligent care and maintenance, however if Birkdale carry out any installation work Birkdale offer a 3 months warranty on installation workmanship. Birkdale do not warranty installations carried out by other parties.
- Improper initial and subsequent operation
- Negligent or wanton destruction
- External influences, such as: fire, water, salts, alkaline solutions, acids and any abnormal environmental influences
- Mechanical damage, through improper transport and fitting, or through falling or hitting objects
- Improper use of surface protection treatments
- Repair by non-qualified persons
- Using non-Birkdale parts without the written approval of the manufacturer
- Removal of the product number, or making it unidentifiable
- Application of additional, non approved weights or infills
- Failure to remove the protective film or packaging provided with the product, where applicable This warranty applies to all goods sold on or after 1 May 2016, until further notice.

The finish of white powder coated doors is guaranteed for a period of 5 years. In the case of textured woodgrain finished doors, the exterior finish is guaranteed to provide an effective weatherproof membrane which will resist perforation of the Birkdale door from the weather-side due to corrosion for 15 years. Furthermore, colour change or fade to the exterior surface will be limited and uniform for the full 15 year period.

5. SEA SALT CORROSION

Doors fitted within coastal area's can be susceptible to corrosion from the salt air. Salt air deposits will settle on the door and can eventually cause corrosion to the aluminium. Cleaning the door regularly with warm soapy water once a month will slow this process down and prolong the life of the aluminium significantly. Doors fitted within 5 miles of the sea are NOT covered by the standard Birkdale warranties. The warranty for aluminium against corrosion in coastal area's is 18 months. This applies to powder-coated aluminium and steel sections, if laminated finish then standard warranty applies.

5.1 SECTIONAL GARAGE DOOR AND SHUTTER AUTOMATION

Birkdale electric motors are guaranteed against any form of manufacturing defect for a period of 5 years for mechanical elements, motors and transformers. The motor control unit is guaranteed for 2 years. Remote control accessories and parts are guaranteed for a period of 2 years. No warranty claims will be accepted for wear and tear parts and consumable parts (e.g. light bulbs and batteries)

6. BIRKDALE MANUFACTURER'S GUARANTEE REGISTRATION

6.1 Your purchase of a Product has the benefit of a manufacturer's guarantee ("Guarantee"), which covers your product for 12 months from date of purchase. Provided you register the product online or using the postcard given to you on delivery. Please refer to the certificate of Guarantee contained within the box of your purchase for more information. Our Guarantee is in addition to your statutory rights. To register your product please visit the following website address: www.birkdale.co.uk/warranty-register then follow the instructions on screen.

7. SPARE PARTS MANUFACTURE GUARANTEE

7.1 Your Spare Part has the benefit of our manufacturer's guarantee ("Guarantee"), which covers your Spare Part if, within twelve months from purchase your Spare Part is proven to be faulty or damaged because of either workmanship or material. Our Guarantee is in addition to your statutory rights.

7.2 If you received a faulty or damaged Spare Part(s) within twelve months from the date of purchase you may elect to make a claim pursuant to this Guarantee by contacting our Spare Parts Department on 01724282171. We will attend site and replace or repair where necessary at our cost after the twelve months parts and labour warranty expires we will either for an annual fixed cost of £97 if the product is registered or £150 if not done within 28 days of delivery date, extend the labour warranty up to a maximum of 5 years. Alternatively we will arrange a returns authorisation and either a replacement part or full refund including the cost of sending the item to you once the Spare Part(s) has been received and inspected. We will not send any parts out without applying for a returns authorisation.

7.3 Please note it takes 2 to 5 business days to process returns once they arrive at our warehouse.

7.4 A full refund will be issued in the same form of payment originally used for the purchase within 3 to 5 business days of us receiving your return. Please allow up to 28 days for funds to appear in your bank account.

7.5 OUR GUARANTEE IS SUBJECT TO THE FOLLOWING CONDITIONS

- a) Documentary proof of original purchase date is provided.
- b) Cosmetic damage must be reported within 14 days from the date of purchase.
- c) The Spare Part has been fitted by a suitable qualified or competent person in accordance with our operating and maintenance instructions.
- d) The Spare Part is used in the country of purchase.

7.6 OUR GUARANTEE DOES NOT COVER

- a) Damage resulting from transportation, improper use, neglect or interference or as a result of improper installation.
- b) Accidental damage, this includes but is not limited to, damage which occurs as a result of an external action.

7.7 WE MANUFACTURE SPARE PARTS FOR DOMESTIC USE ONLY.

We understand that in some cases our Spare Parts are used in commercial and/or non domestic situations. We still provide a full 12 months Guarantee subject to the above conditions and that the Spare Part has not been subject to overuse, which is to be determined by us taking into account actual usage versus usage that is expected of a domestically situated appliance.

7.8 COLOURFAST TERMS FOR LAMINATE FINISH

The assessment of any colour change is made according to ISO 105-A02 (grey scale) [Fourth Edition 1993-09-01]. Weather fastness, with respect to colour change, is deemed to exist according to RENOLIT Technical Terms and Conditions of Delivery TL-RENOLIT EXOFOL MX, TL-RENOLIT EXOFOL PX & TL-RENOLIT EXOFOL FX if no grade below grade 3 of the grey scale is attained according to the above mentioned Technical Terms and Conditions of Delivery under test conditions. Due to the variety of climatic conditions and environmental influences in the course of natural weathering and to ensure reproducible results, resistance to weather fastness is assessed according to EN 513 by a Xeno test according to ISO 4892-2. A defect is deemed to exist if, within the Warranty periods specified in the Annex, colour changes occur due to natural weathering which exceed grade 3 of the grey scale of ISO 105-A02. Weather fastness (according to the Technical Terms and Conditions of Delivery) is considered to exist with a view to other (non-colour-related) substantial impairments of the visual appearance when the human eye cannot detect delamination, stains, blisters, streaks, cracks or other impairments in a microscopic evaluation at 20 x magnification. Weather fastness Colour change ≤ grayscale 3 (ISO 105-A02) after samples have received (EN 513, process 1) 20 GJ/m2 of radiant energy according to the requirements of RAL-GZ 716.

SERVICE MAINTENANCE CARD

DATE	ENGINEER	COMMENTS

**NOT MAINTAINING YOUR GARAGE DOOR CORRECTLY MAY INVALIDATE YOUR WARRANTY
IT IS STRONGLY RECOMMEND THAT AN ANNUAL SERVICE IS CARRIED OUT**

ADDITIONAL INFORMATION FOR POWER-OPERATED DOOR SYSTEMS

- Only correct fitting and maintenance carried out by a competent/specialist company or a competent person/expert in accordance with the instructions can ensure that an installed door system works safely and as intended.
- The userguide must be made available to the end user.
- When carrying out installation, the applicable regulations on occupational safety and the respective national guidelines must be observed.
- The fitting materials supplied must be inspected by the fitter to establish their suitability for use at the intended installation site.
- Inspection and maintenance may only be carried out by an expert. In this regard, please contact your supplier.
- A visual check may be made by the operator of the door system. With regard to any necessary repairs, please contact your supplier.
- We shall grant no warranty for repairs which have been performed incorrectly or incompetently.
- With regard to the correct care and operation of the door system, please refer to the information in our Fitting, Operating and Maintenance Instructions.
- Please take note of all our safety instructions and cautions which are specifically identified as such. Door systems located in the public sector and which have only one safety device, e.g. force limit, may only be operated under supervision.



Birkdale Manufacturing Group Ltd
Unit 5, Eastgate Park, Arkwright Way
Queensway Industrial Estate
Scunthorpe
North Lincolnshire
DN16 1AE

TEL: 01724 282171
FAX: 01724 282170
EMAIL: sales@birkdale.co.uk
WEBSITE: www.bikrdale.co.uk