

**Marantec**

**bi·linked**

**Radio Accessories**

# Impressions transmitters



# Impressions wall controls



**Simple encoding**  
(e. g. Multi-Bit)



**Complex encoding**  
(e. g. bi·linked)



## uni-directional



## bi-directional

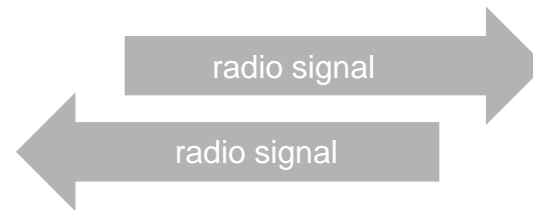

### Hand transmitter bi-directional

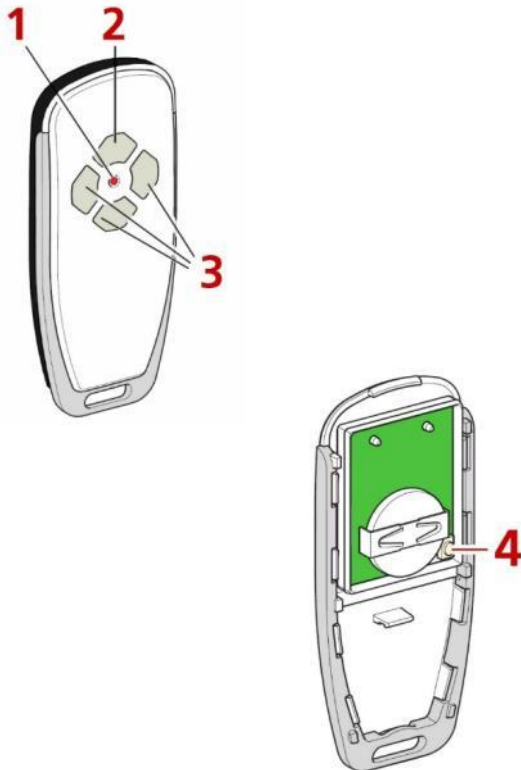

### Functions (3-channel transmitter)

- › Impulse
- › Direction orders
- › Door position request
- › Travel direction signalling
- › Button lock

### Caption

- 1 LED indicator
- 2 Status button
- 3 Function buttons
- 4 Programming button

### Hand transmitter uni-directional

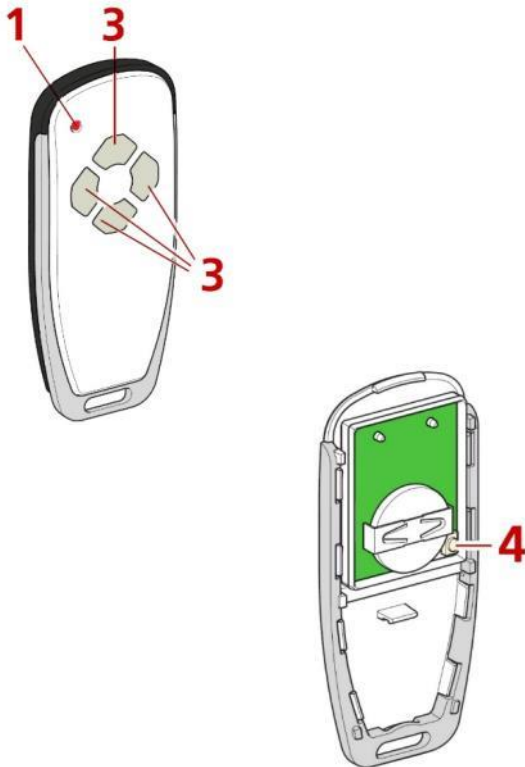

### Functions (4-channel transmitter)

- > Impulse
- > Direction orders
- > Button lock

### Caption

- 1 LED indicator
- 3 Function buttons
- 4 Programming button

## Radio push button with status request bi-directional

### Functions

- › Impulse
- › Direction orders
- › Door position request
- › Travel direction signalling
- › Holiday mode
- › Conventional cabling external push button (both channels)

### Caption

- 1 LED indicator
- 2 Status button
- 3/4 Function buttons
- 7 Holiday button
- 8 Programming button

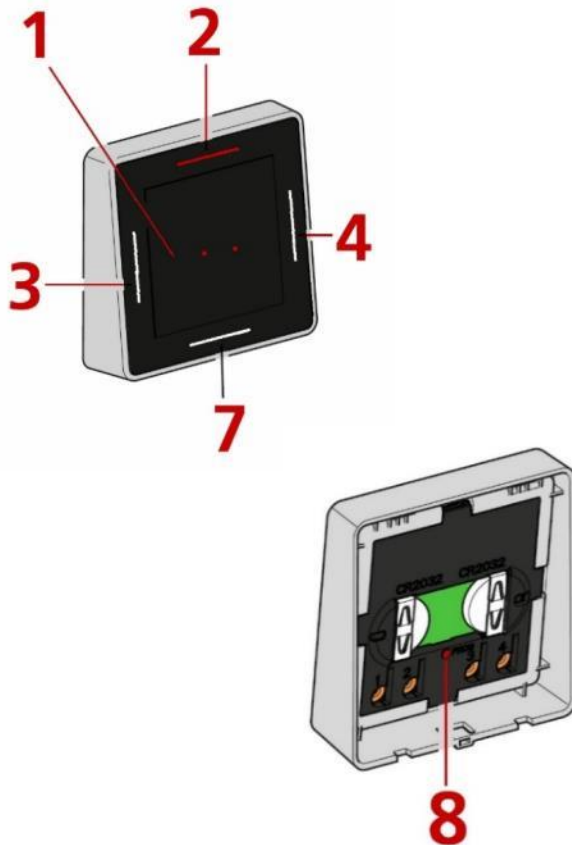



## Radio push button with motion detector bi-directional

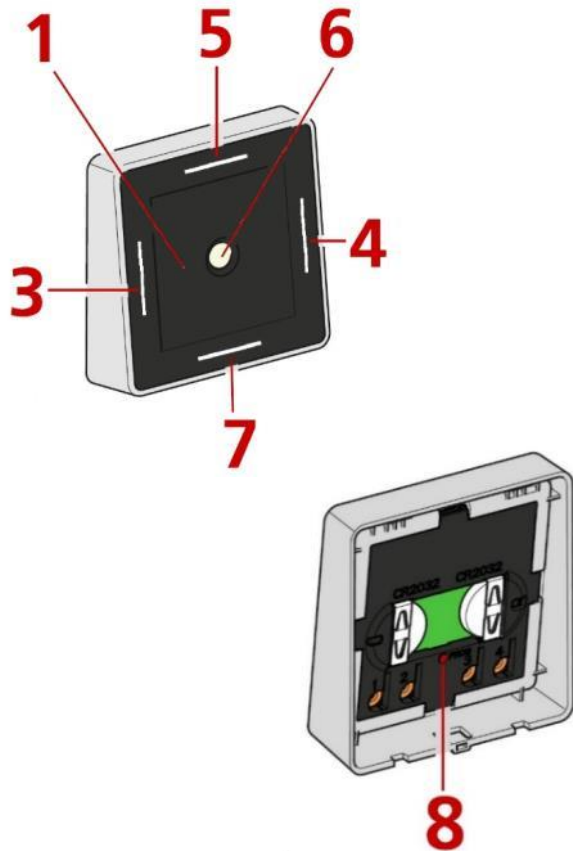

### Functions

- › Impulse
- › Direction orders
- › Light switching by motion detector
- › Holiday mode
- › Conventional cabling external push button (both channels)

### Caption

- 1 LED indicators
- 3/4 Function buttons
- 5 Light button
- 6 Motion detector
- 7 Holiday button
- 8 Programming button

## Radio code keypad uni-directional

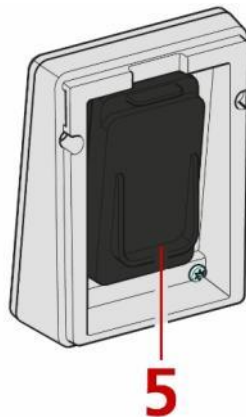
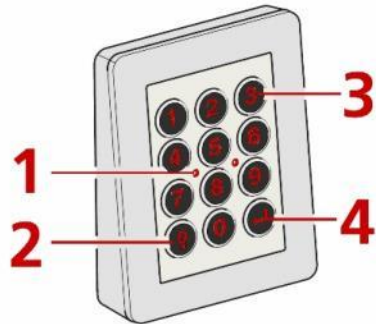

### Functions

- › Impulse
- › 3 user codes
- › 1 master code
- › Temporary code (3 times usable)
- › Light control
- › Reset function

### Caption

- 1 LED indicators
- 2 Light button
- 3 Digit buttons
- 4 Enter button
- 5 Battery compartment cover

### Radio fingerprint reader uni-directional



### Functions

- › 20 user fingers for operation
- › 2 channels
- › Deleting of single or all user fingers
- › Reset

## Radio fingerprint reader uni-directional

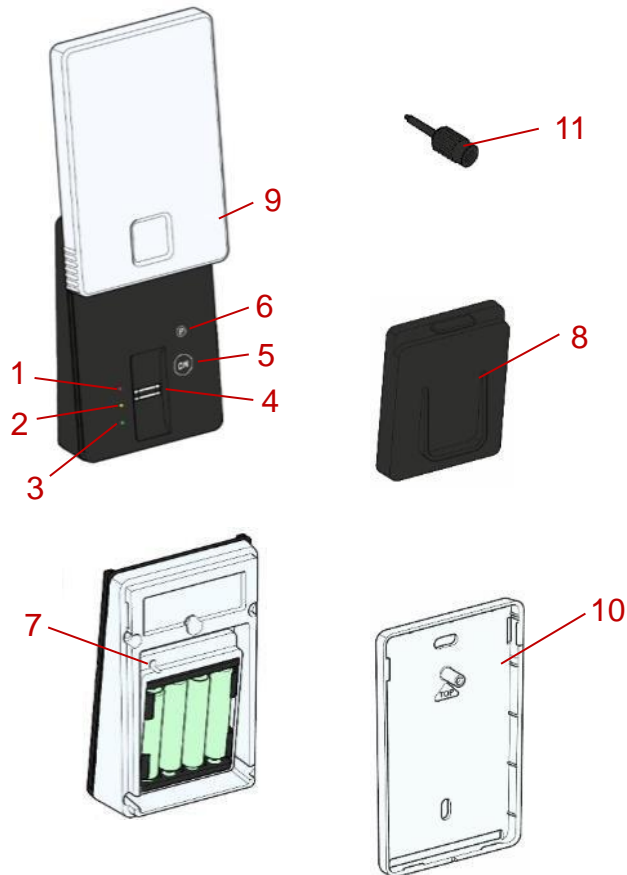

### Caption

- 1 LED indicator red
- 2 LED indicator yellow
- 3 LED indicator green
- 4 Reader module
- 5 Power button (ON)
- 6 Front programming button
- 7 Rear programming button
- 8 Battery compartment cover
- 9 Sliding cover
- 10 Wall mounting
- 11 Programming pin for the rear programming button

# Programming & Operation

Radio programming

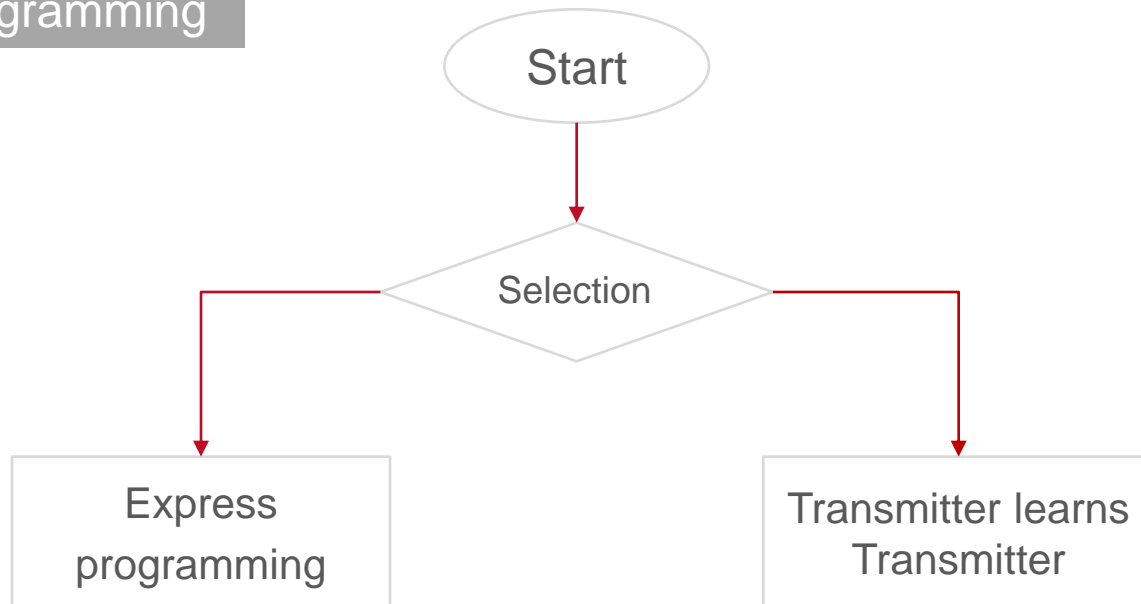

Radio | Express programming

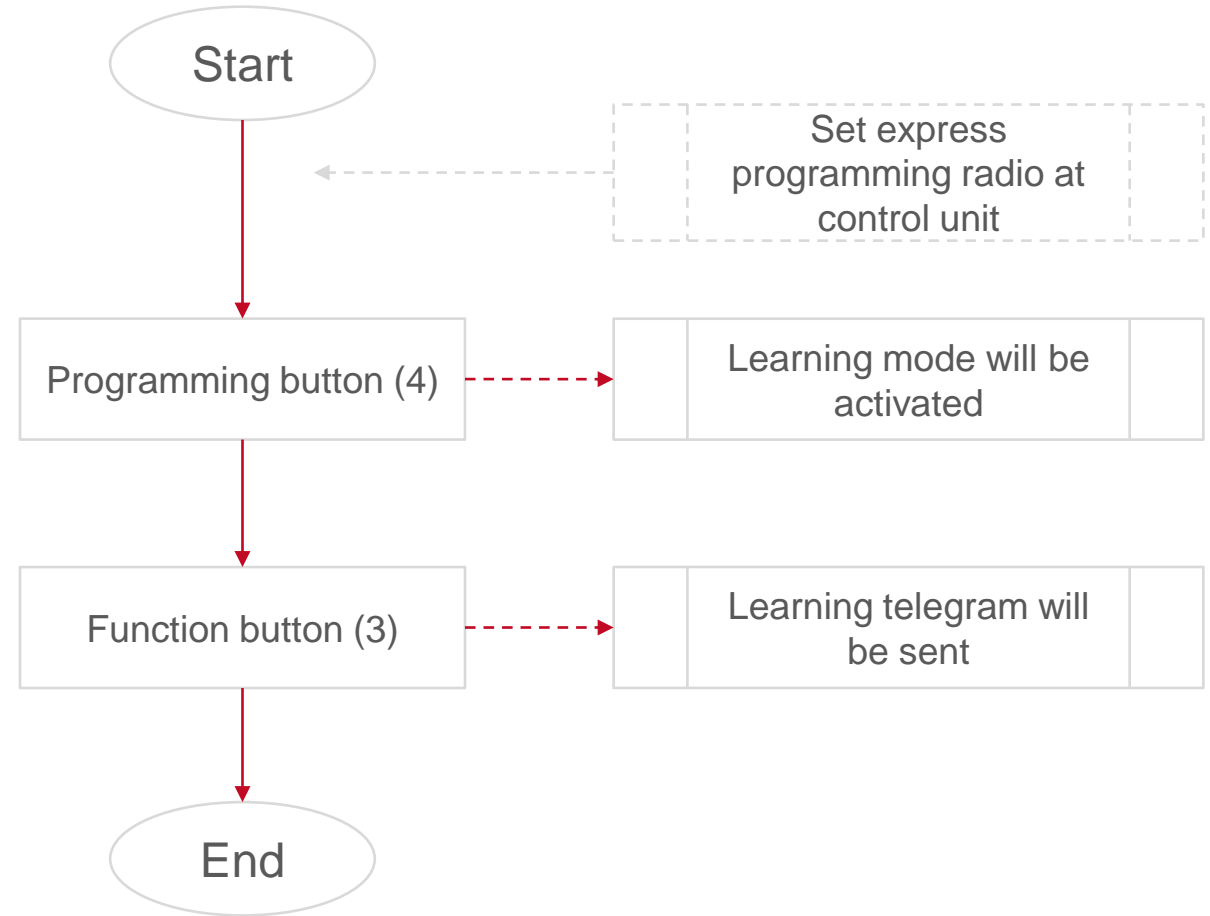
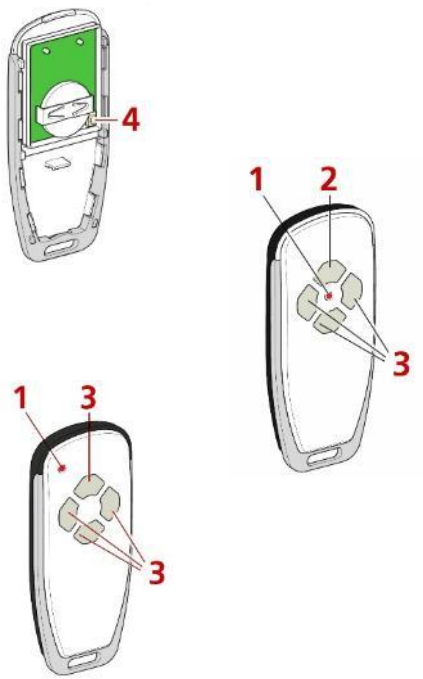

Radio | Transmitter learns  
Transmitter

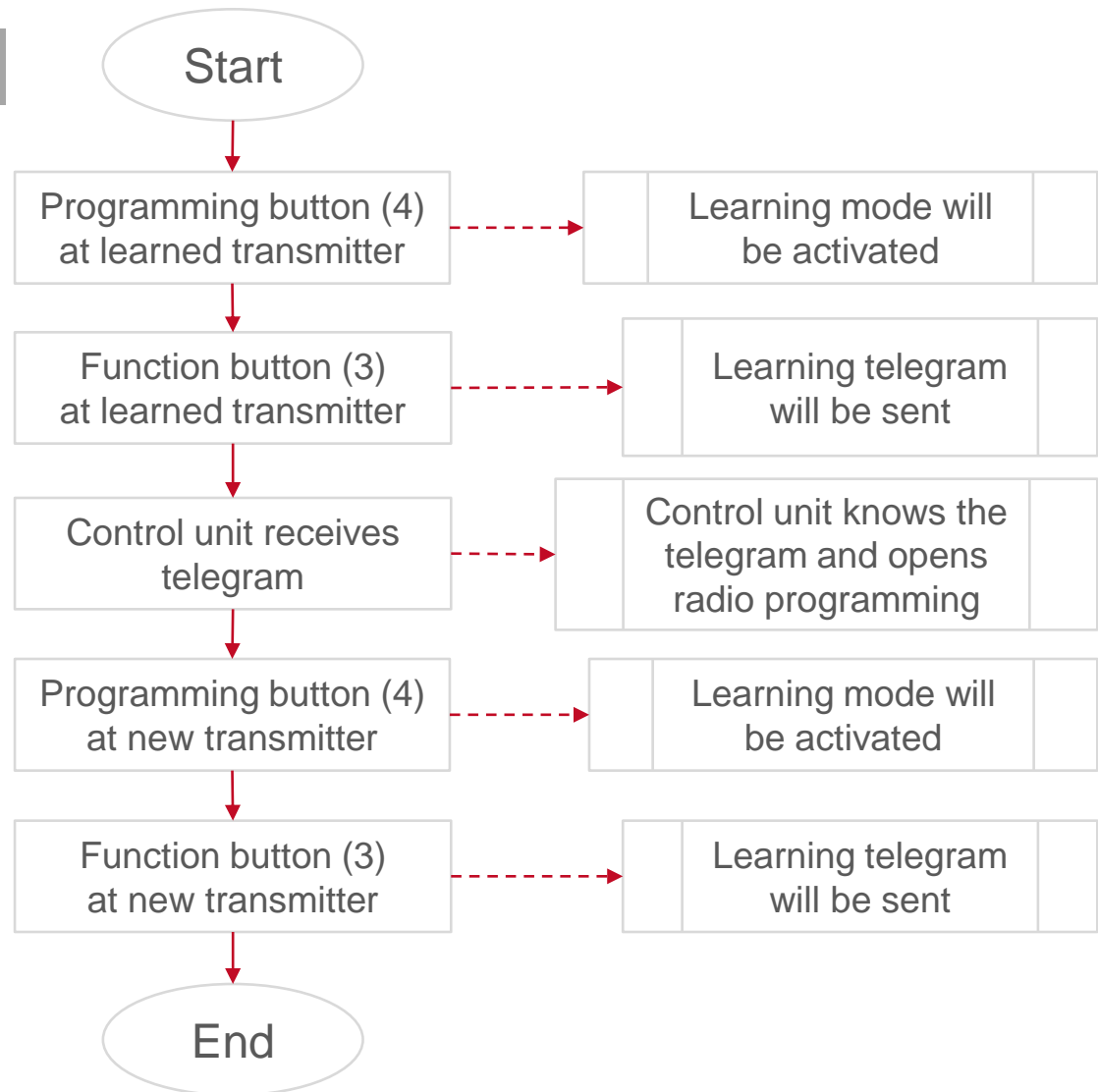



Door position request

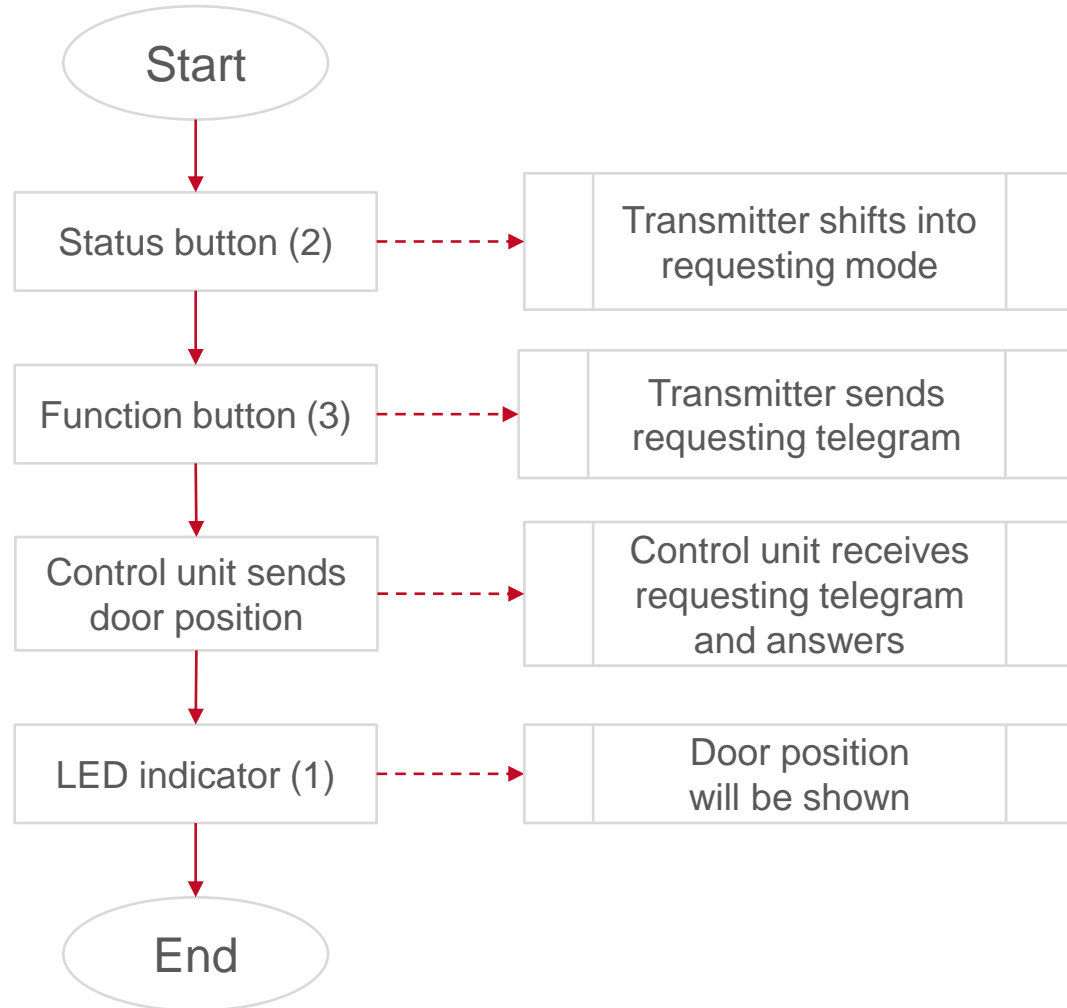
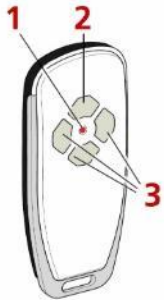

## Door position request | LED indication

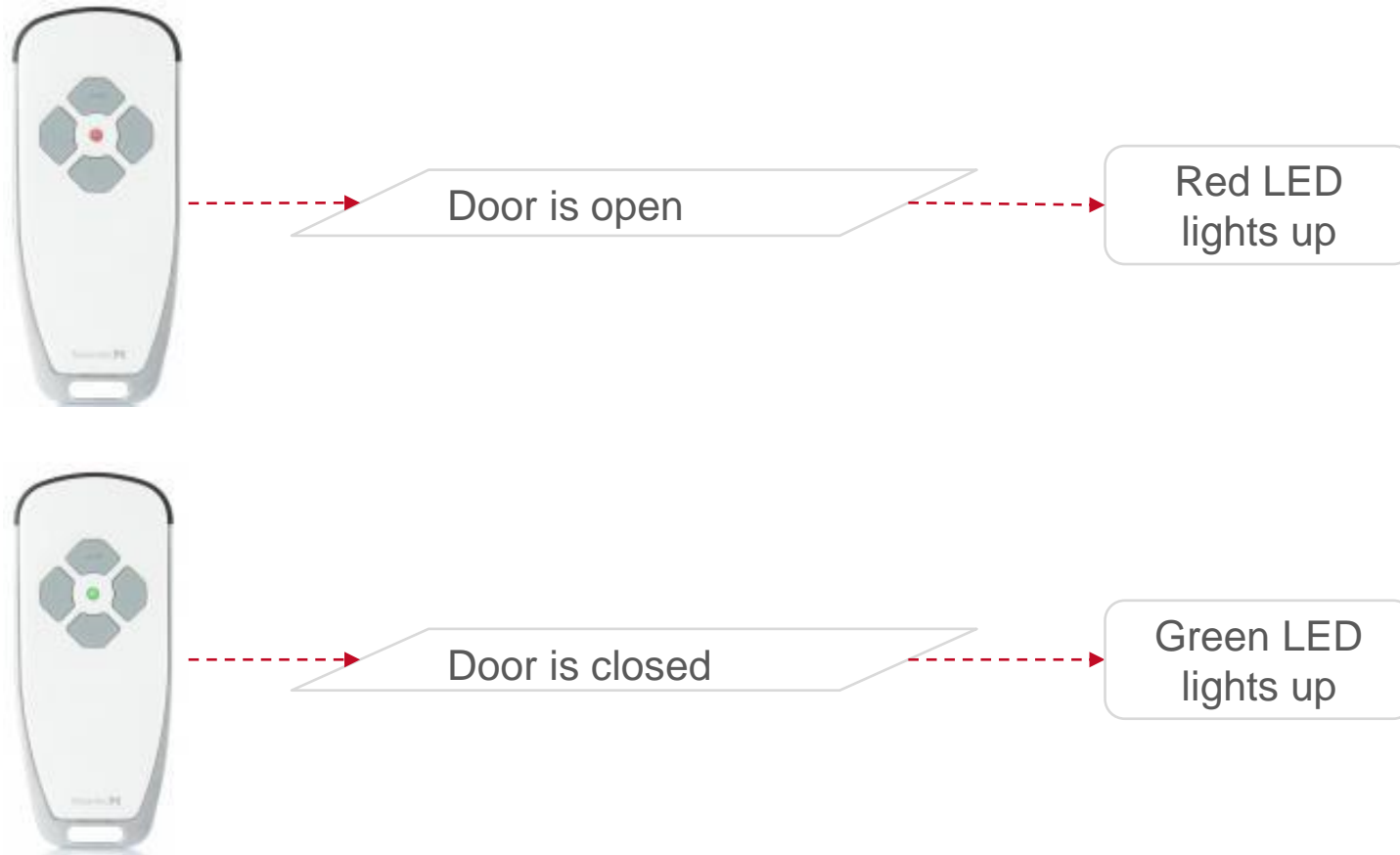

## Door position request | LED indication

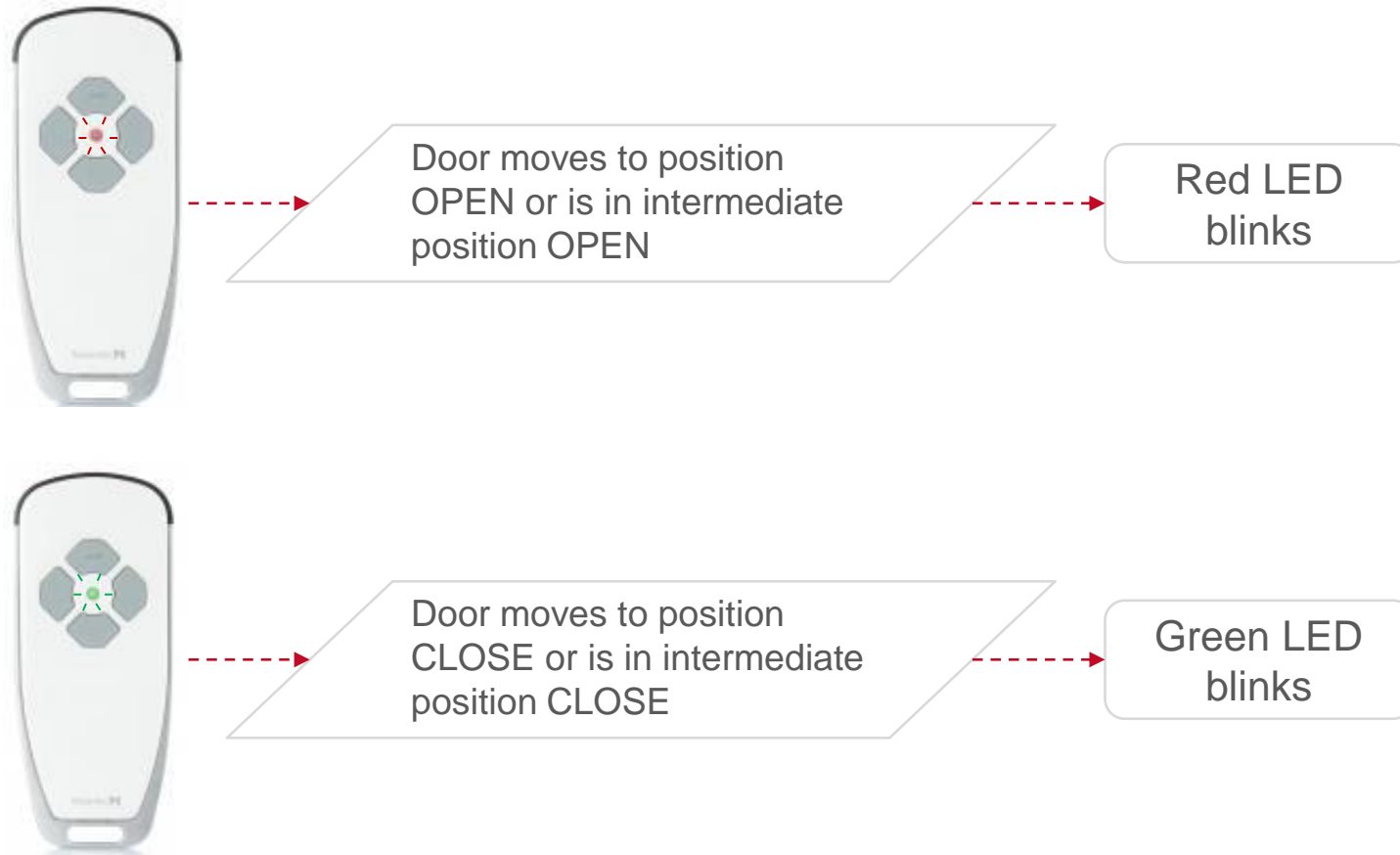

Radio programming

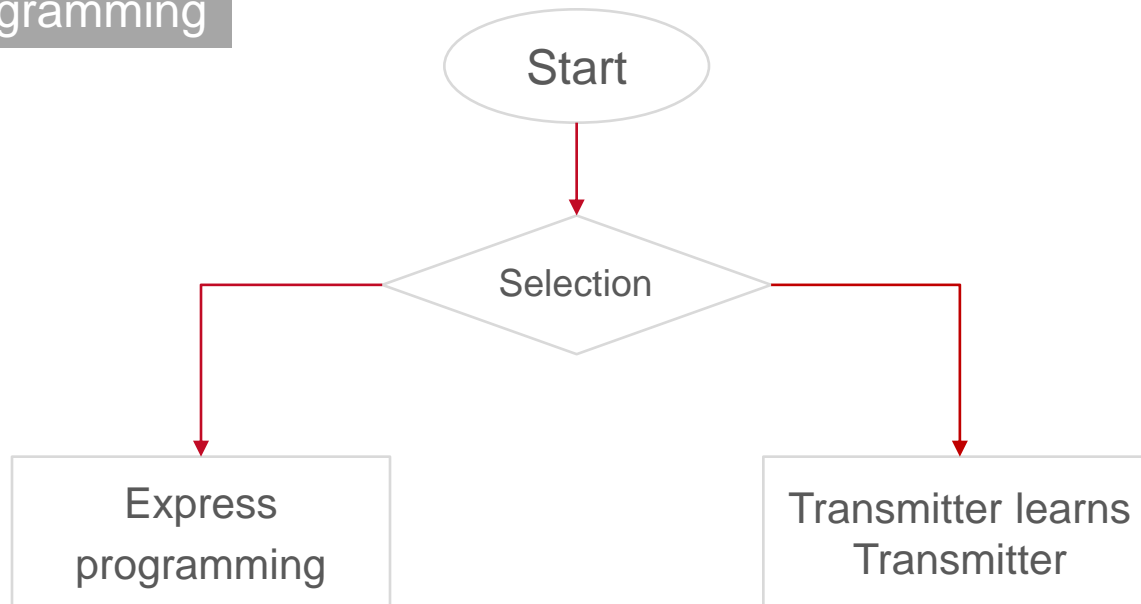

Radio | Express programming

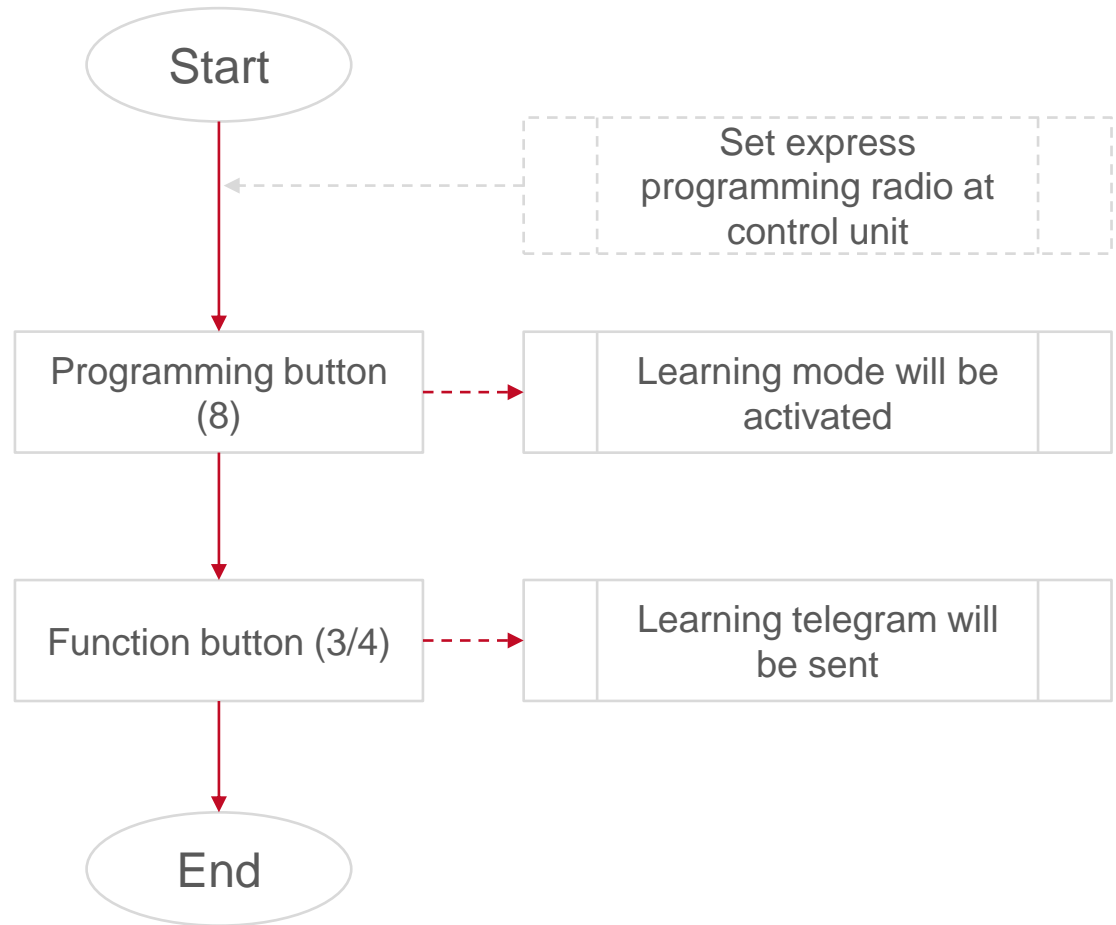
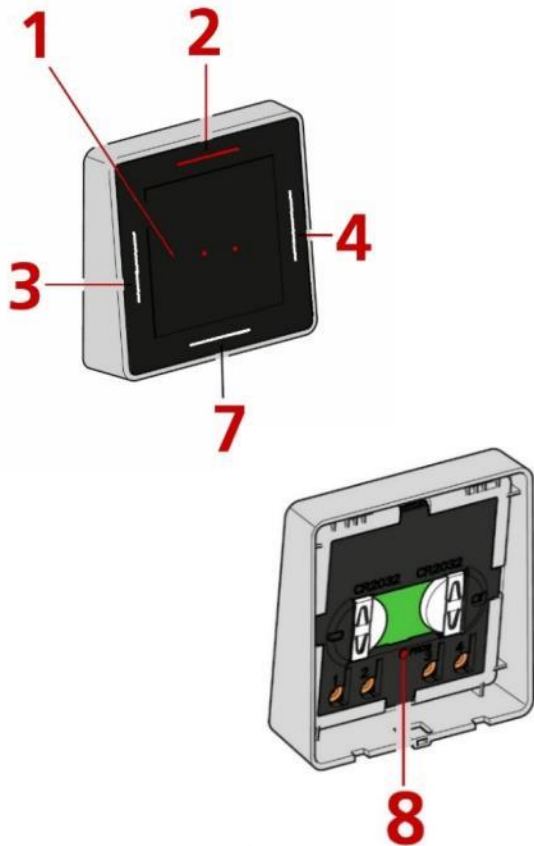

Radio | Transmitter learns  
Transmitter

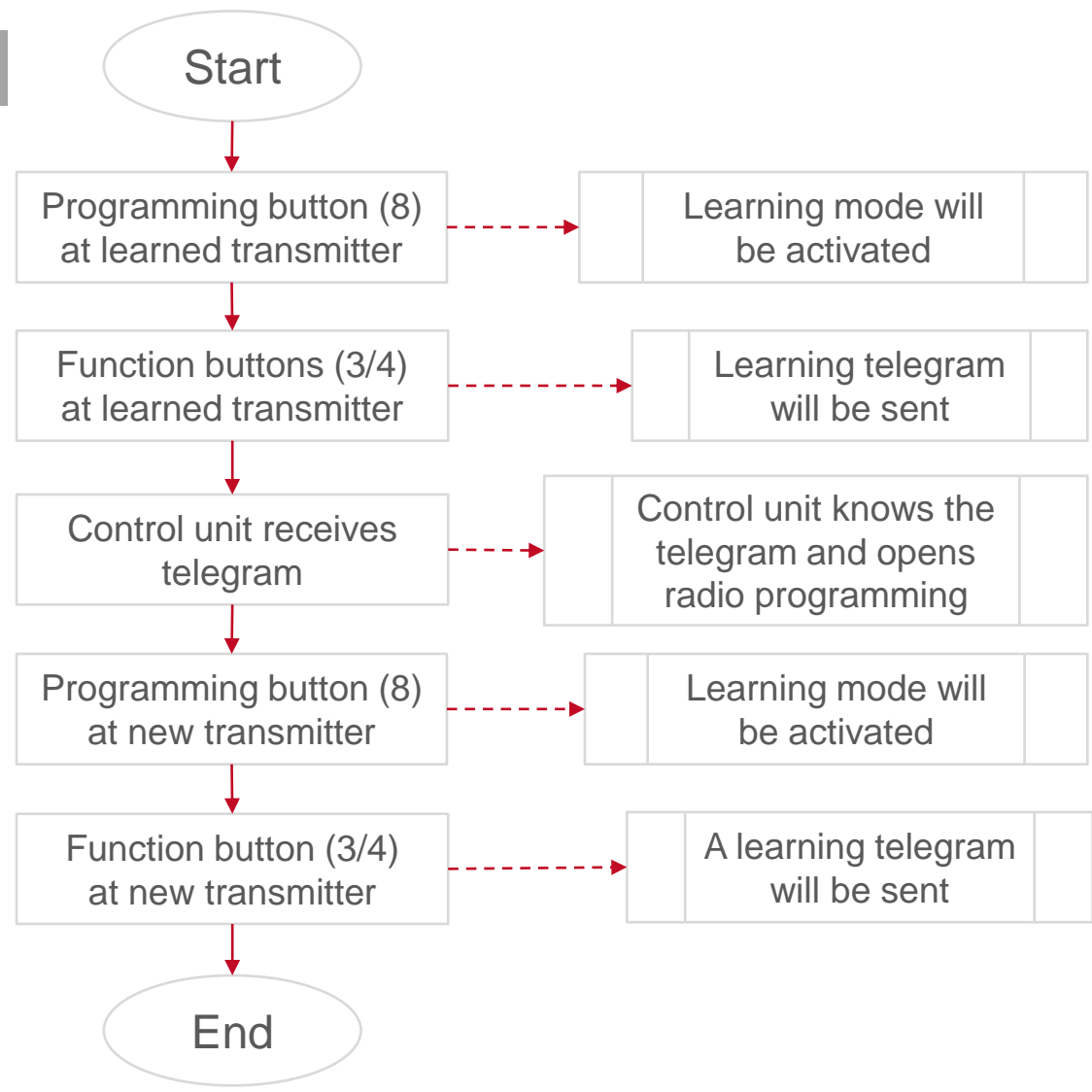

## Holiday mode

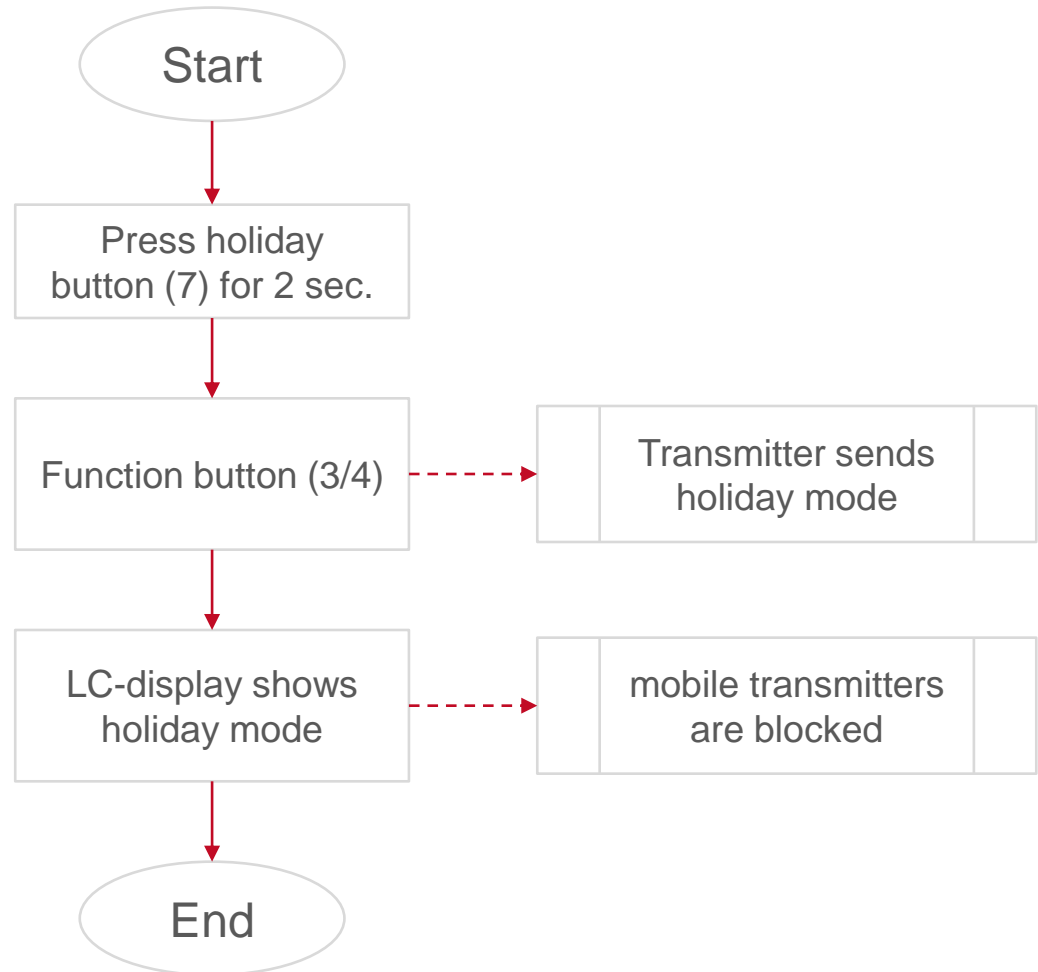
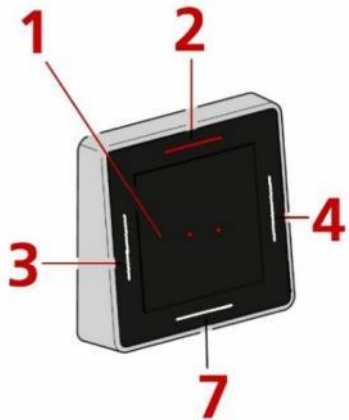

## Door position request (Digital 644)

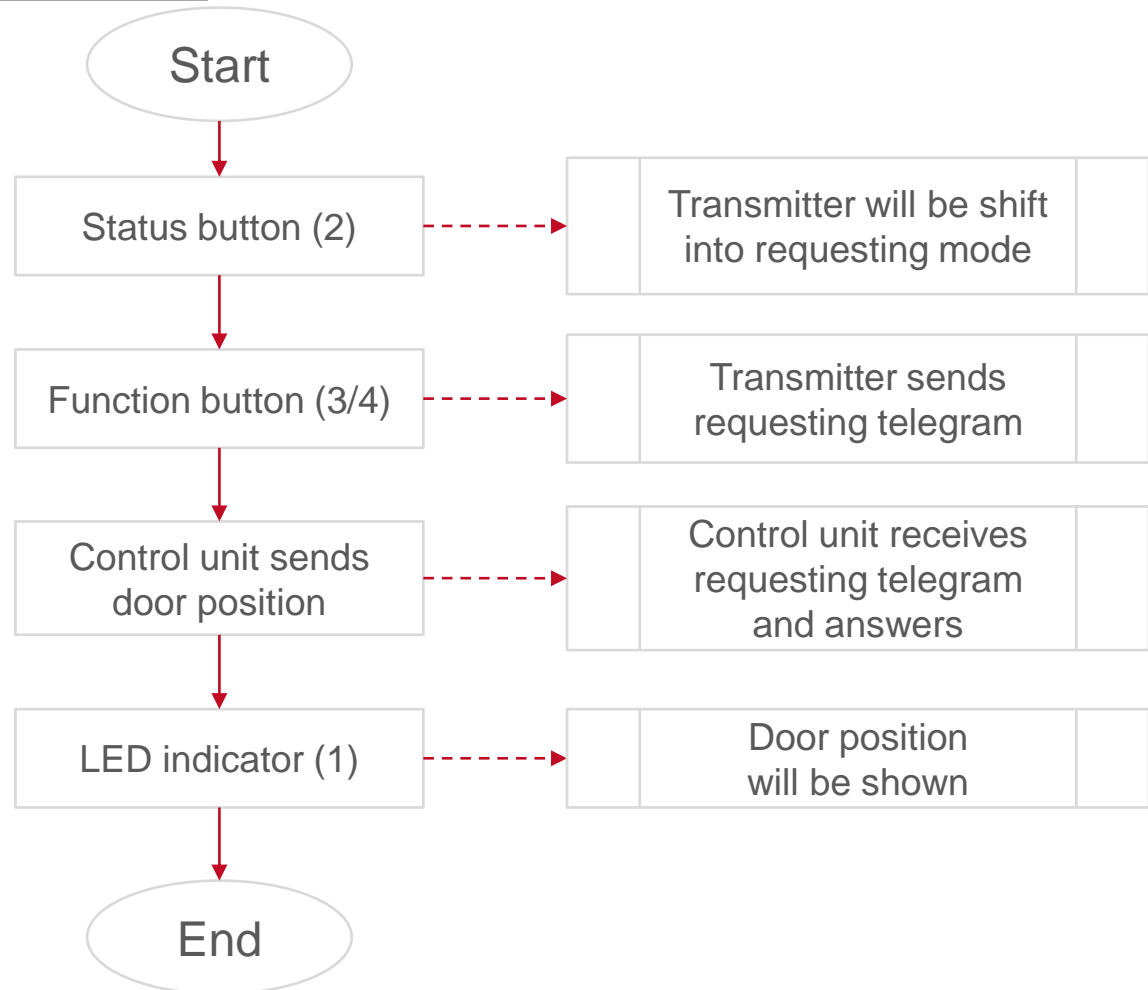
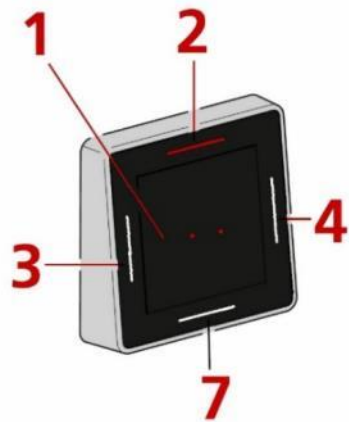



## Door position request (Digital 644) | LED indication

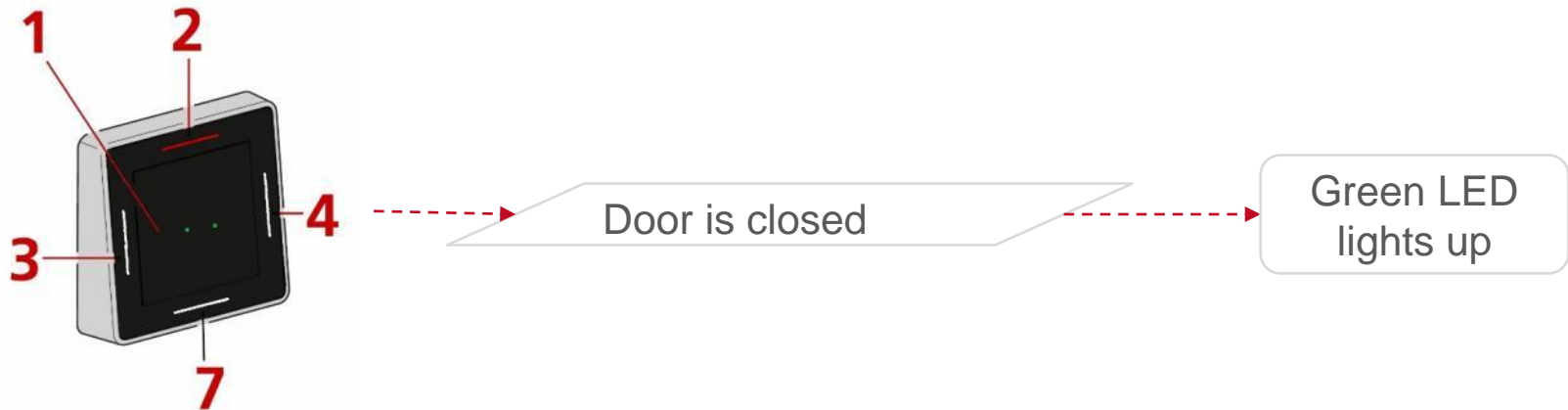
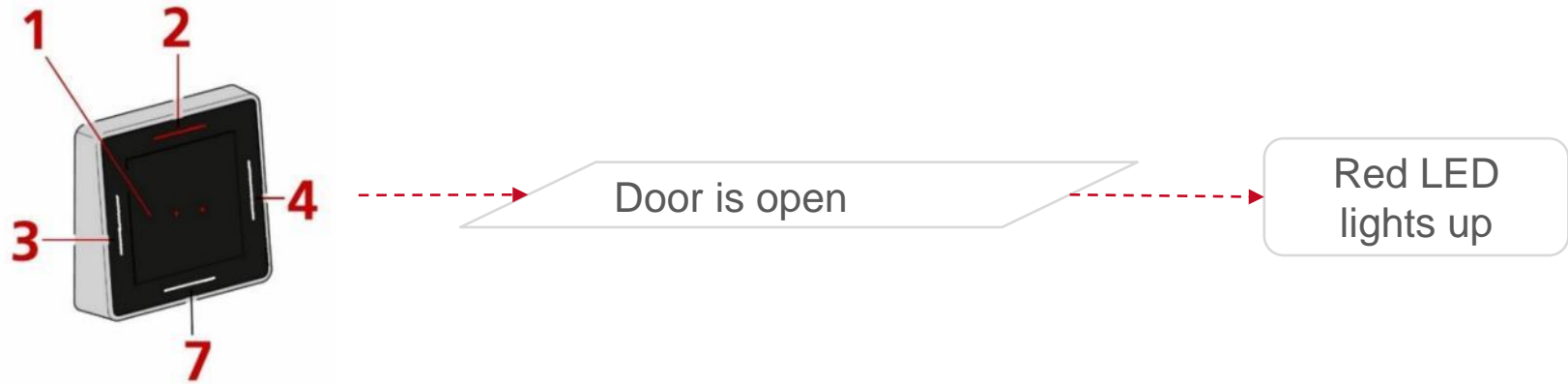

## Door position request (Digital 644) | LED indication

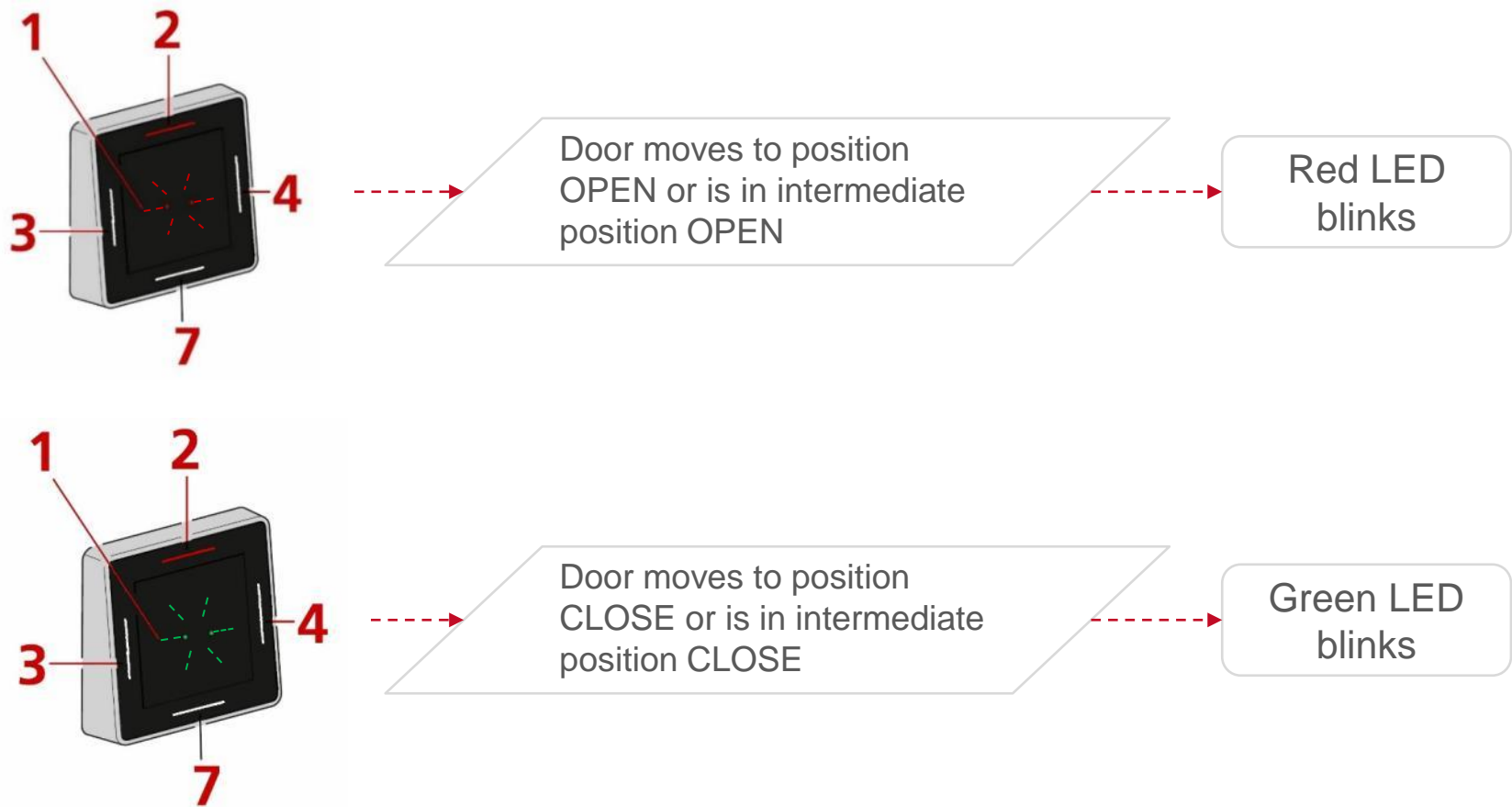

### Programming lighting function (Digital 645)

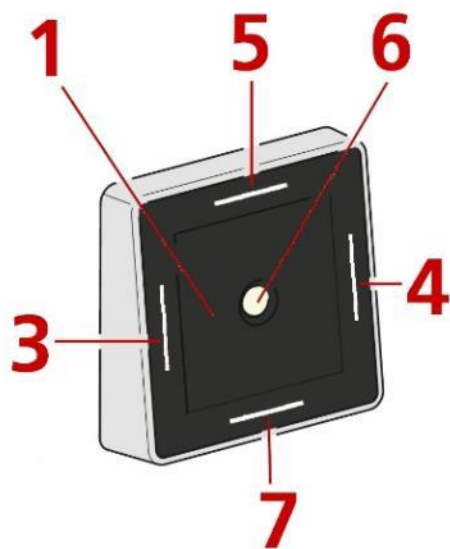

- › The wall control Digital 645 has got a motion detector, which activates the opener lighting
- › At delivery the opener lighting is set to 180 seconds
- › The motion detector is programmed on the left function button (3) at delivery
- › After triggering the motion detector, it is inactive for 180 seconds (energy-saving)
- › Notice: the opener lighting should not be set to a value shorter than 180 seconds

## Light button (Digital 645)

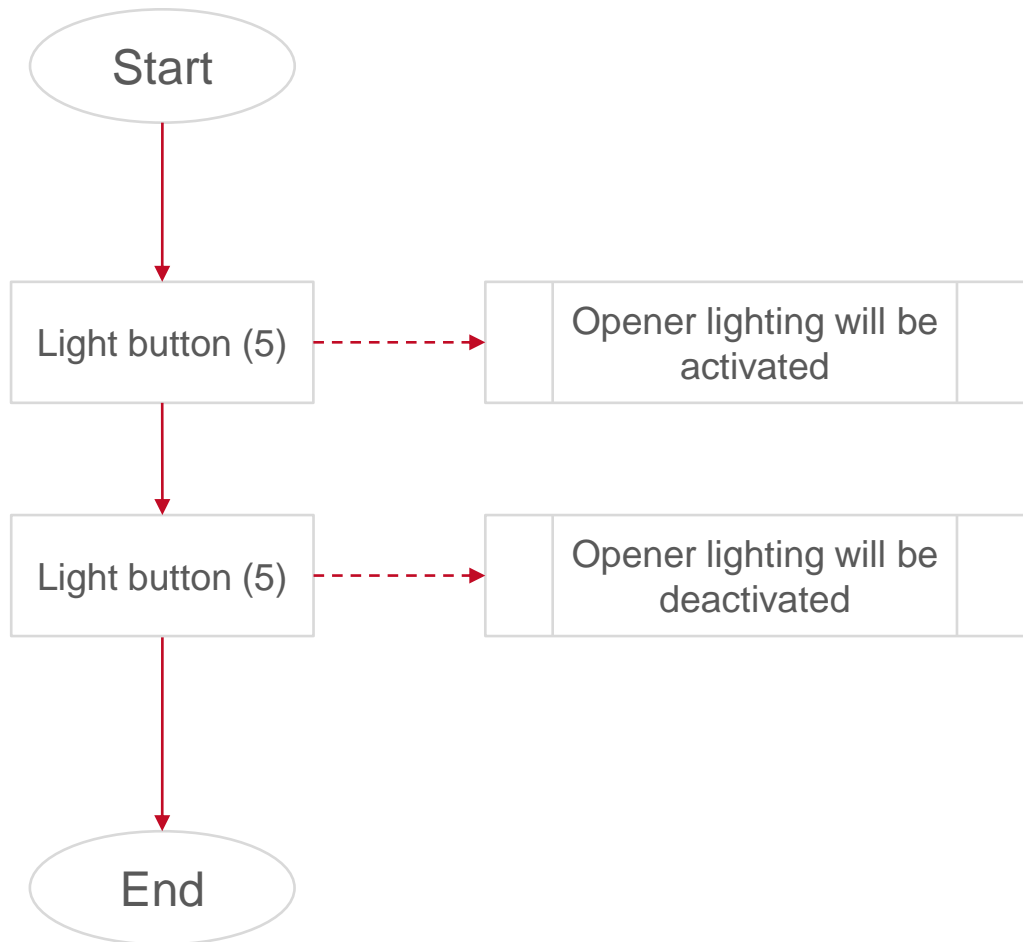
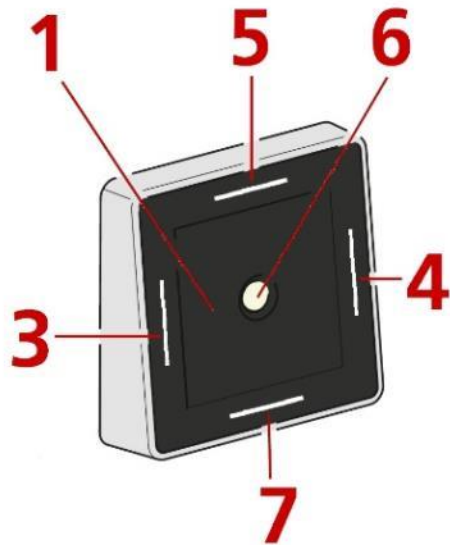

## Conventional cabling external push buttons

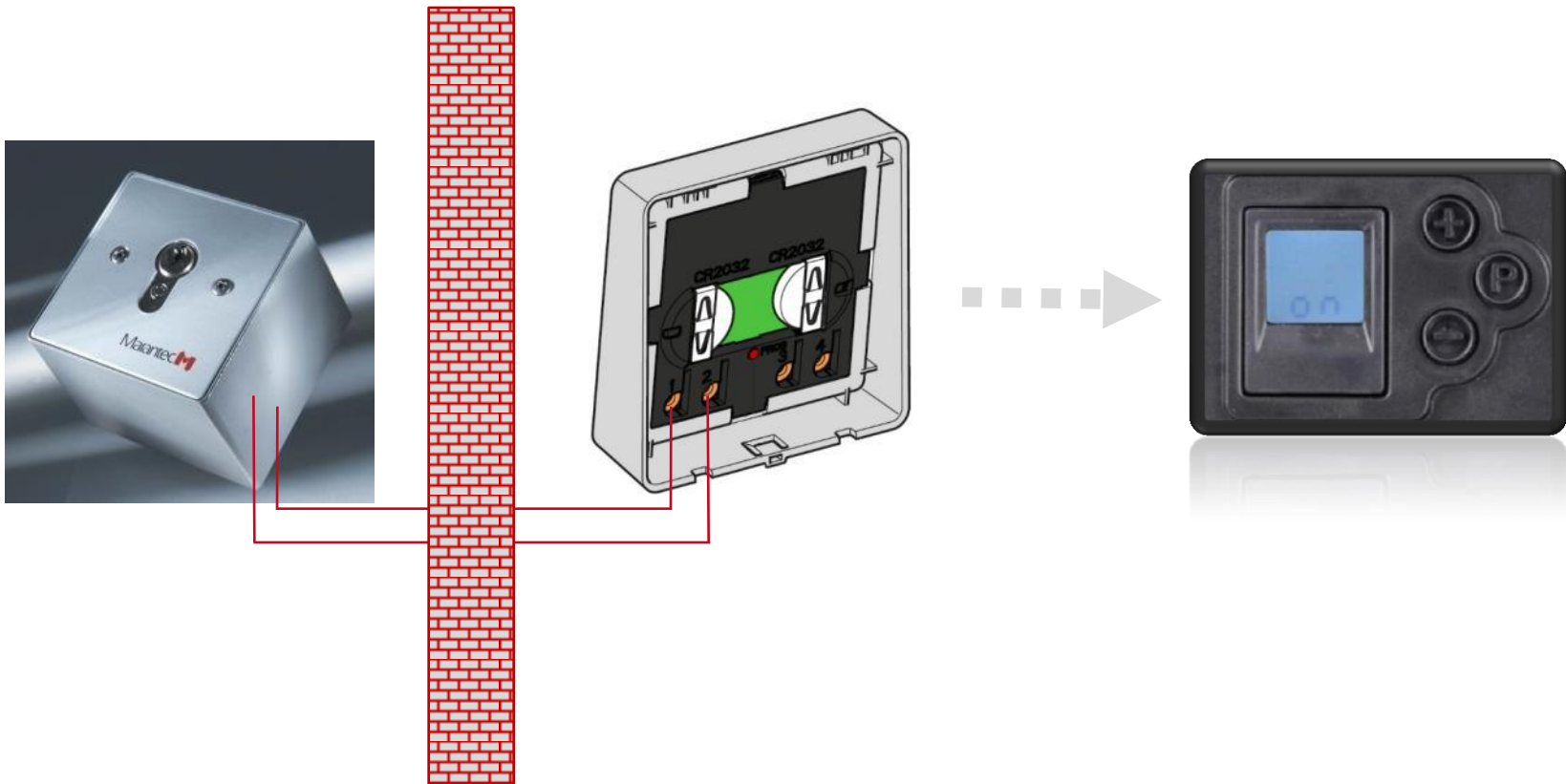

Function overview radio code keypad

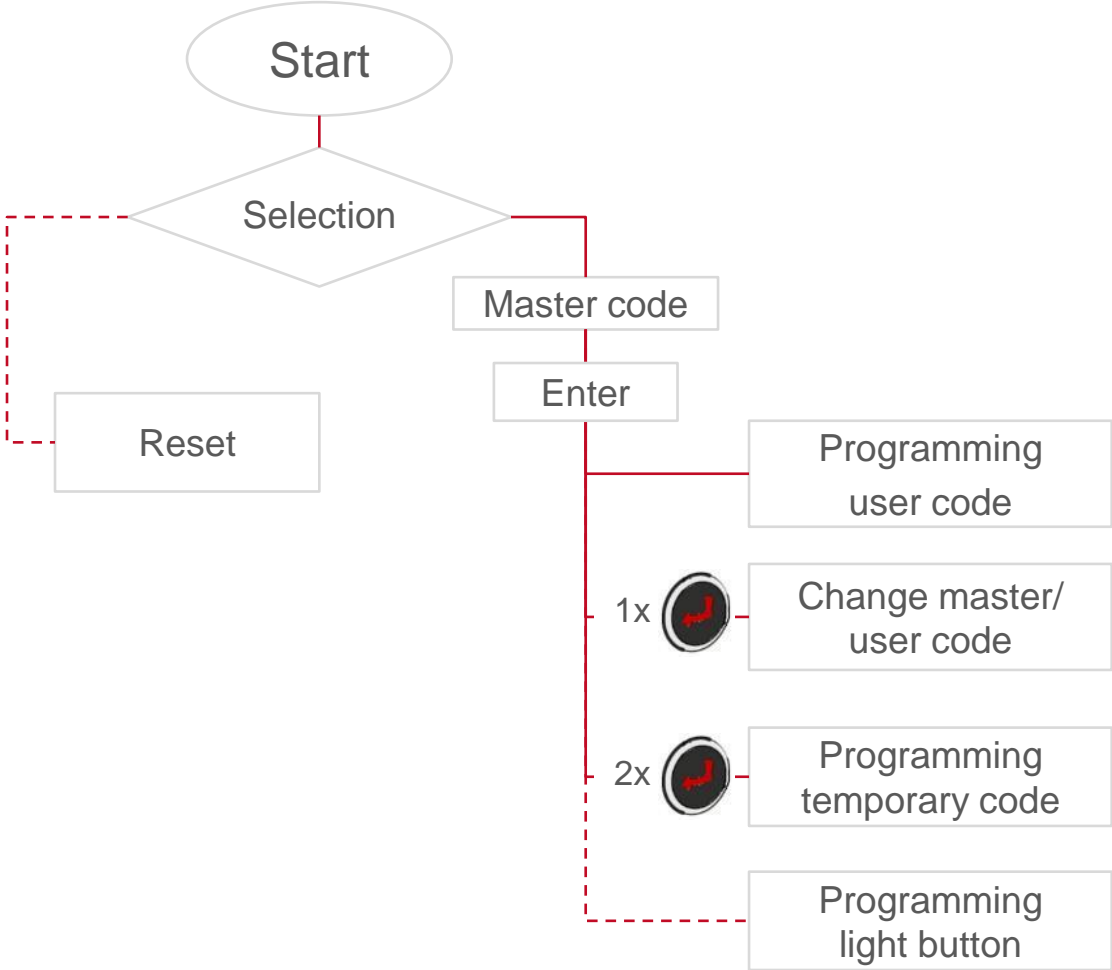
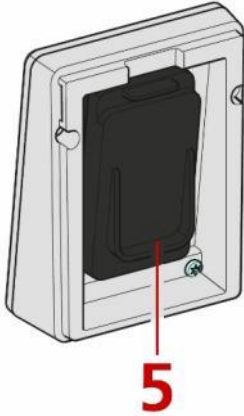
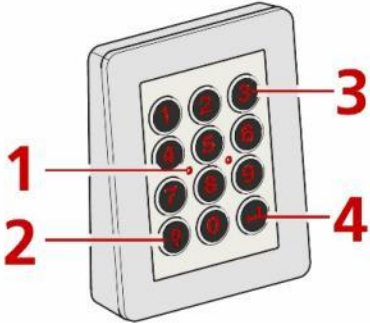

## Programming user code

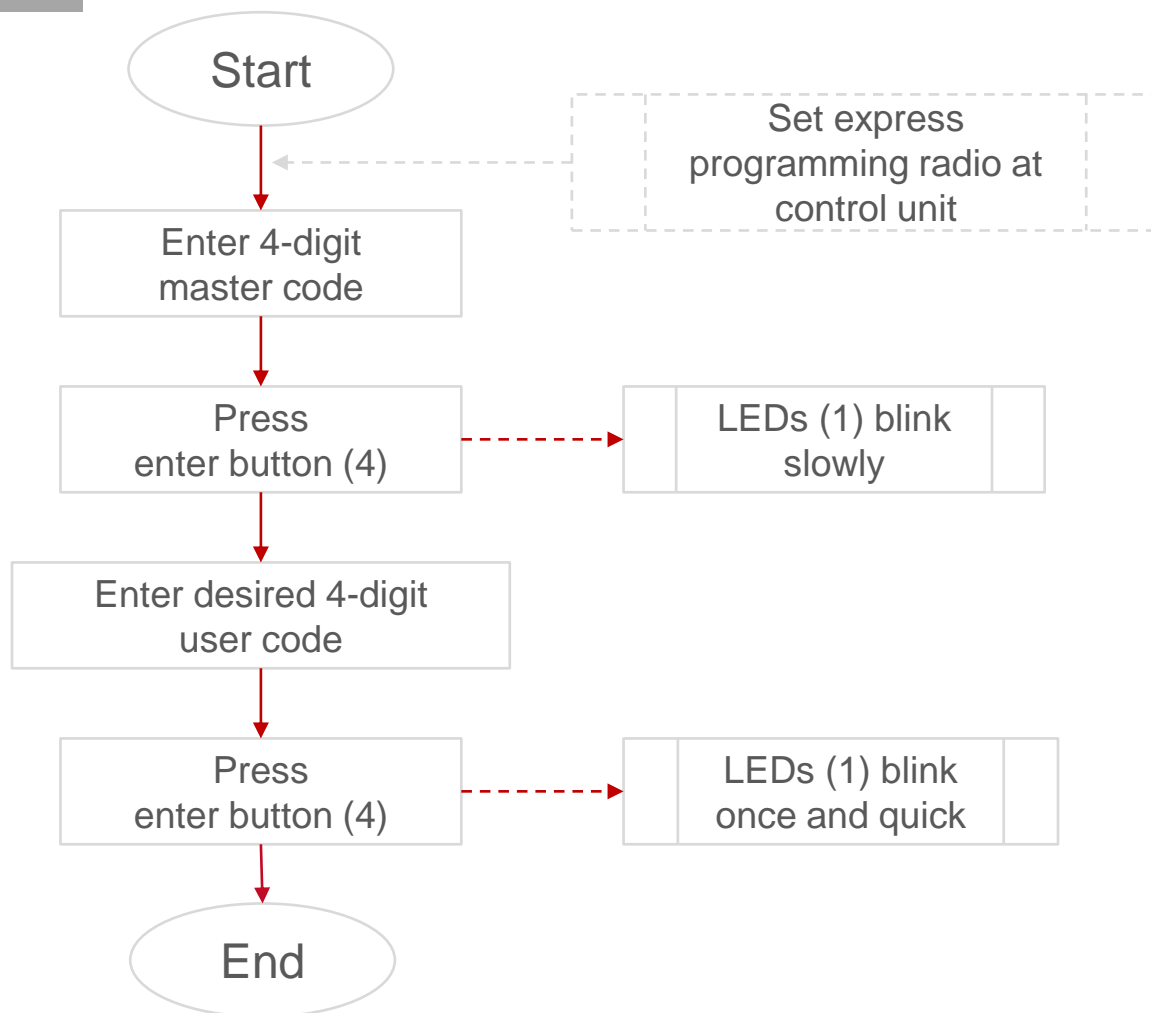
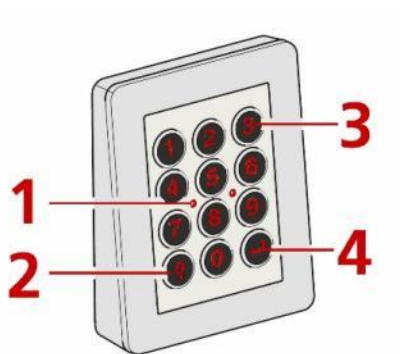

## Changing master / user code

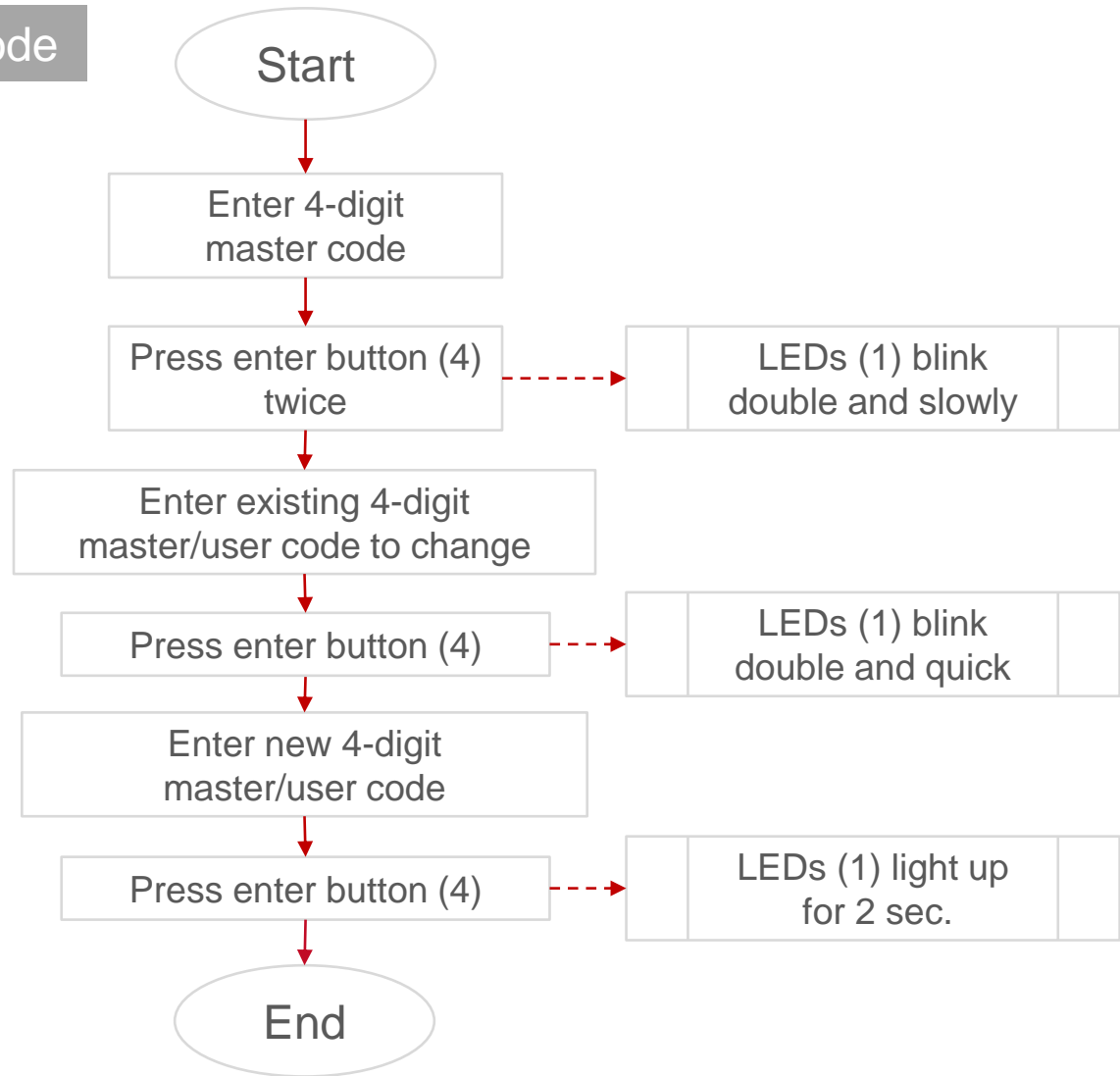
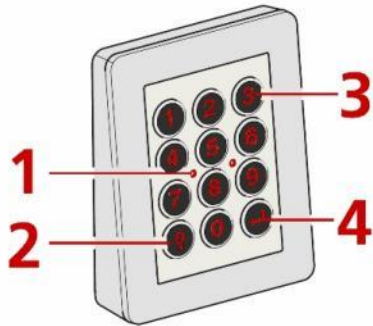



## Programming temporary code

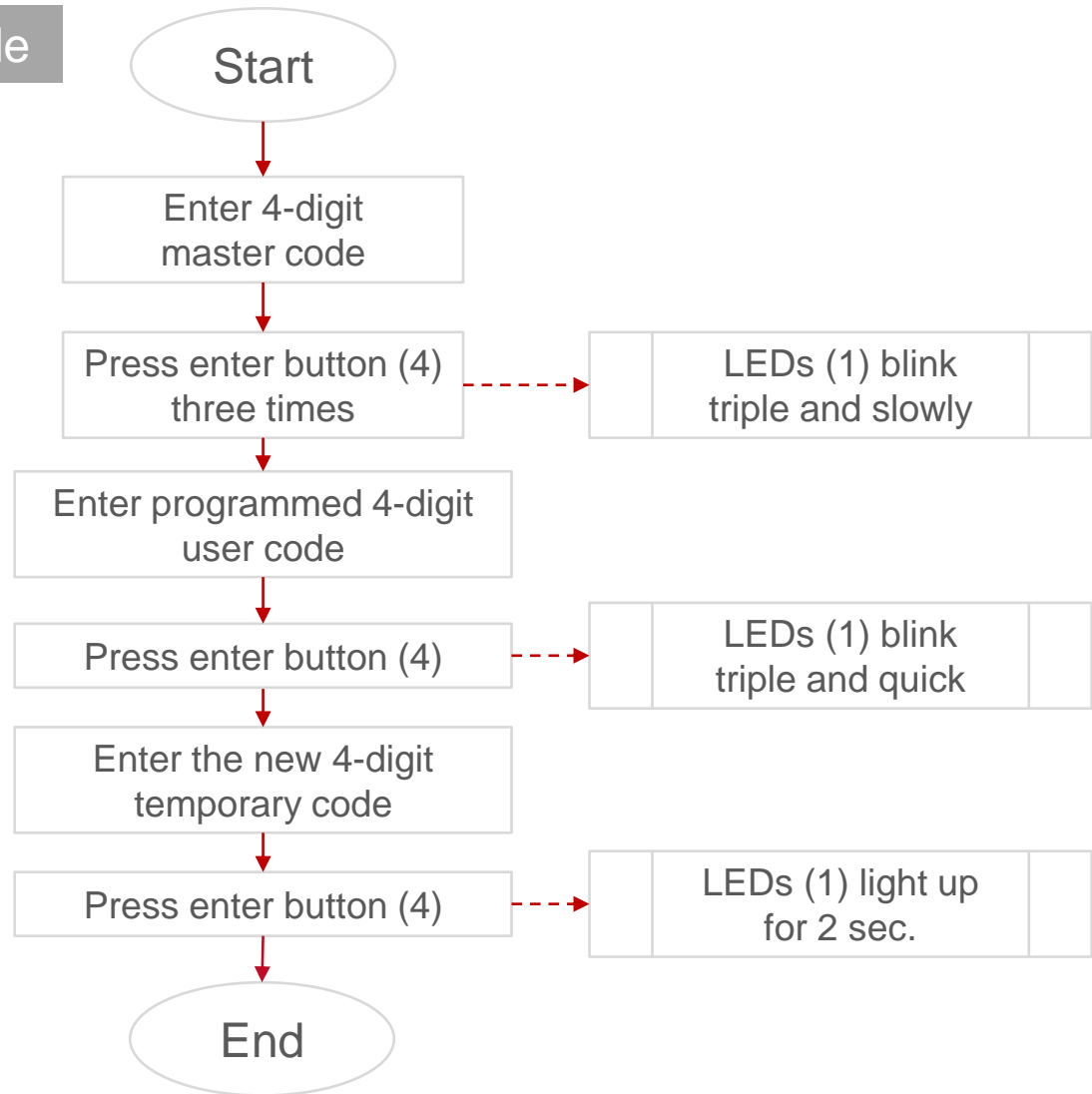
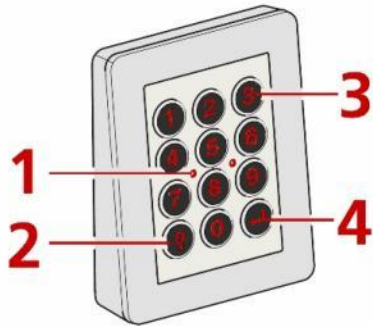

## Programming light function

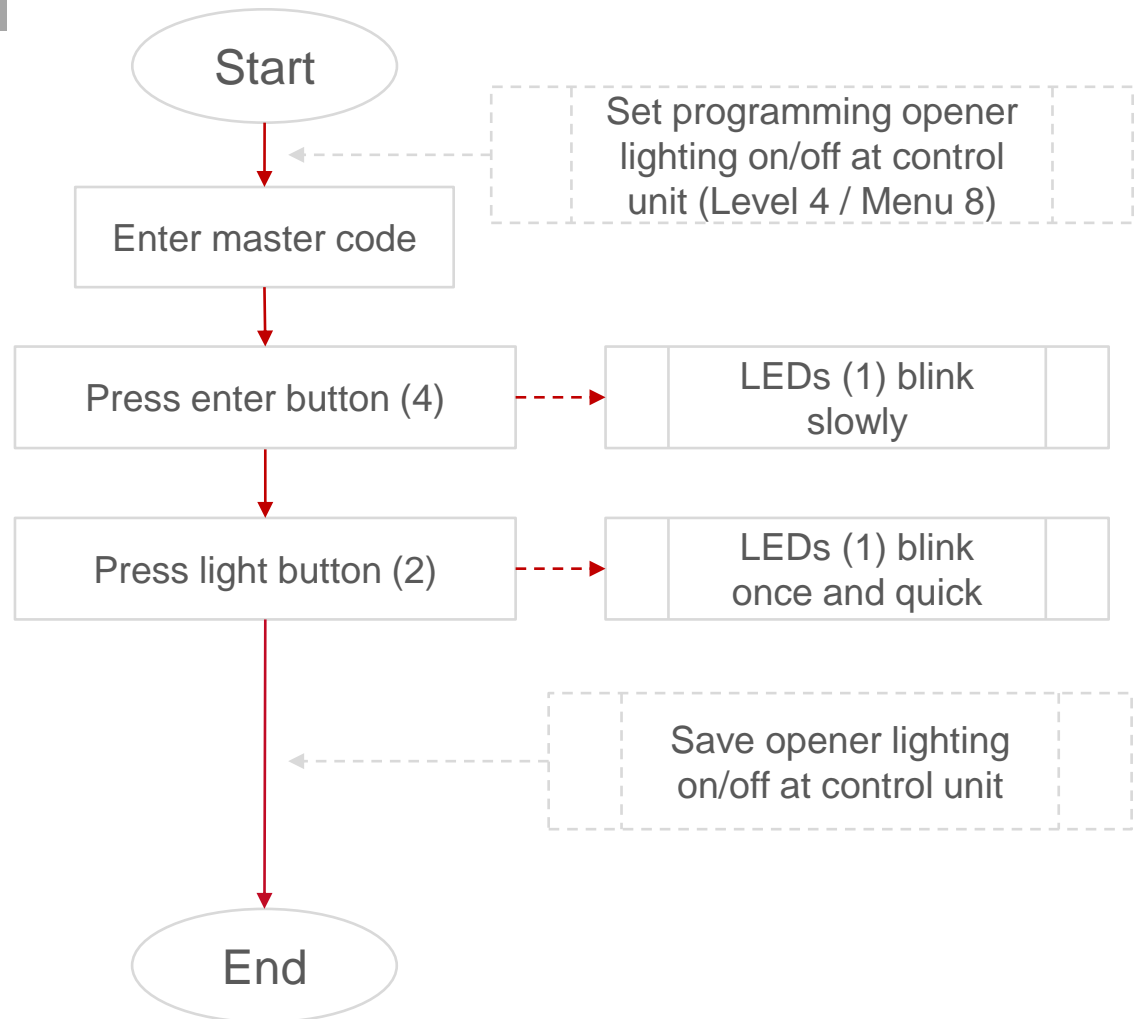
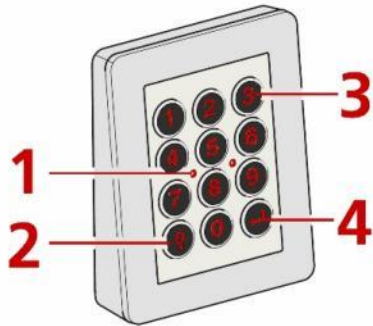

## Light button

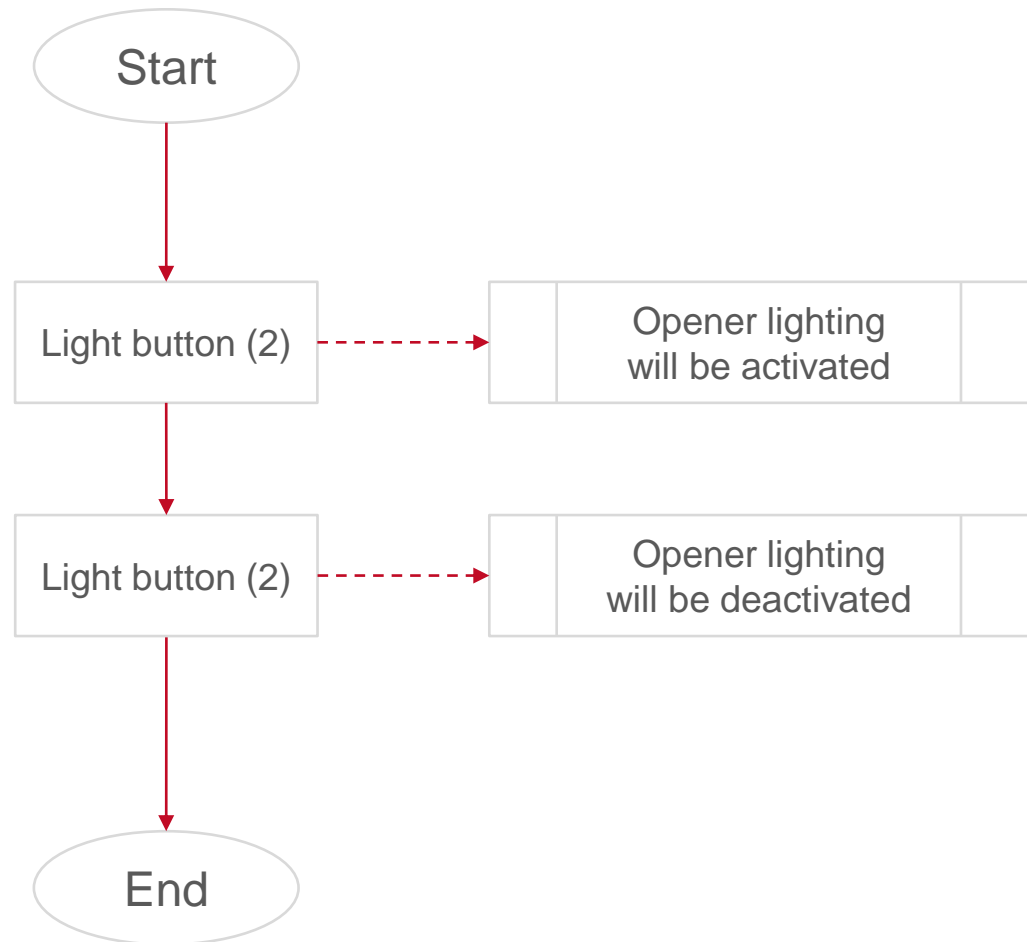
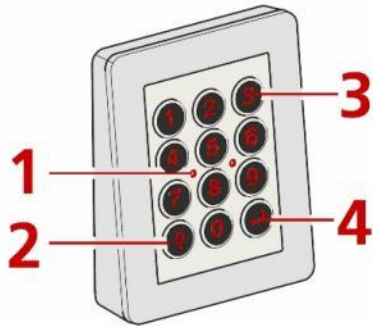

## Reset

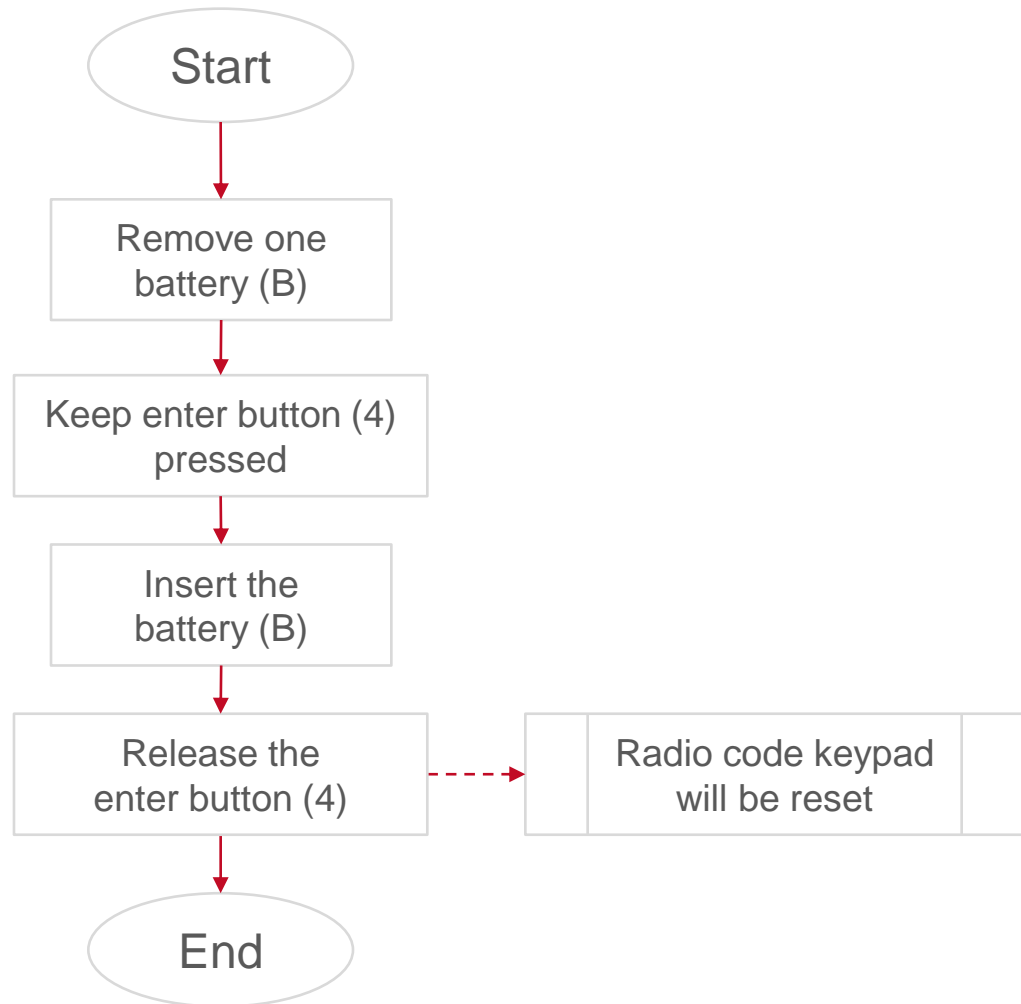
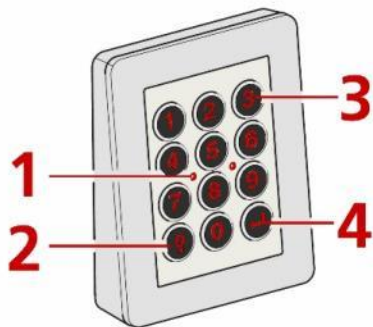
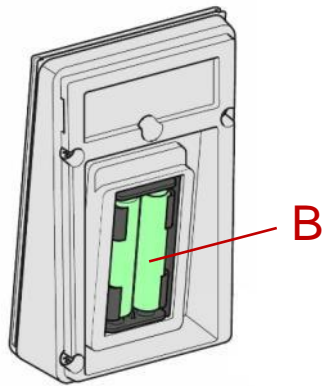

## Functional diagram radio fingerprint reader

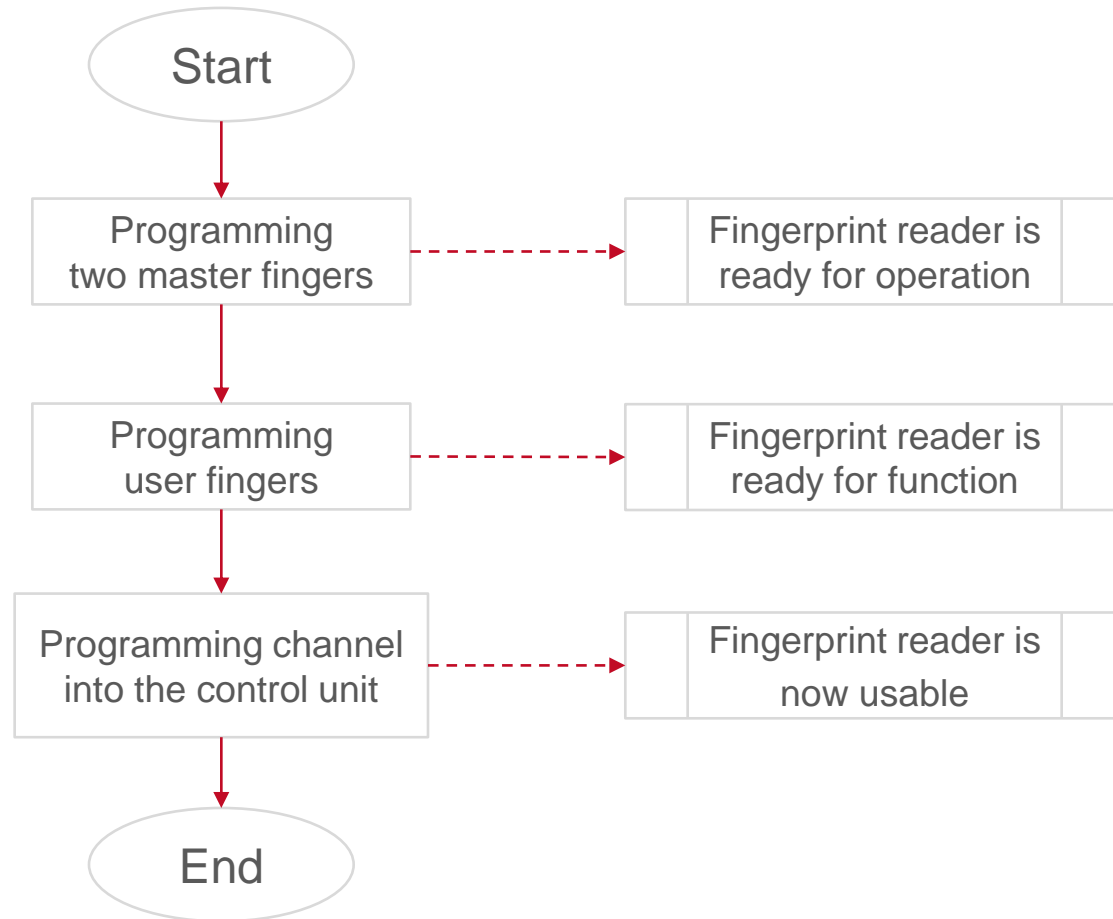

## Programming | Master fingers

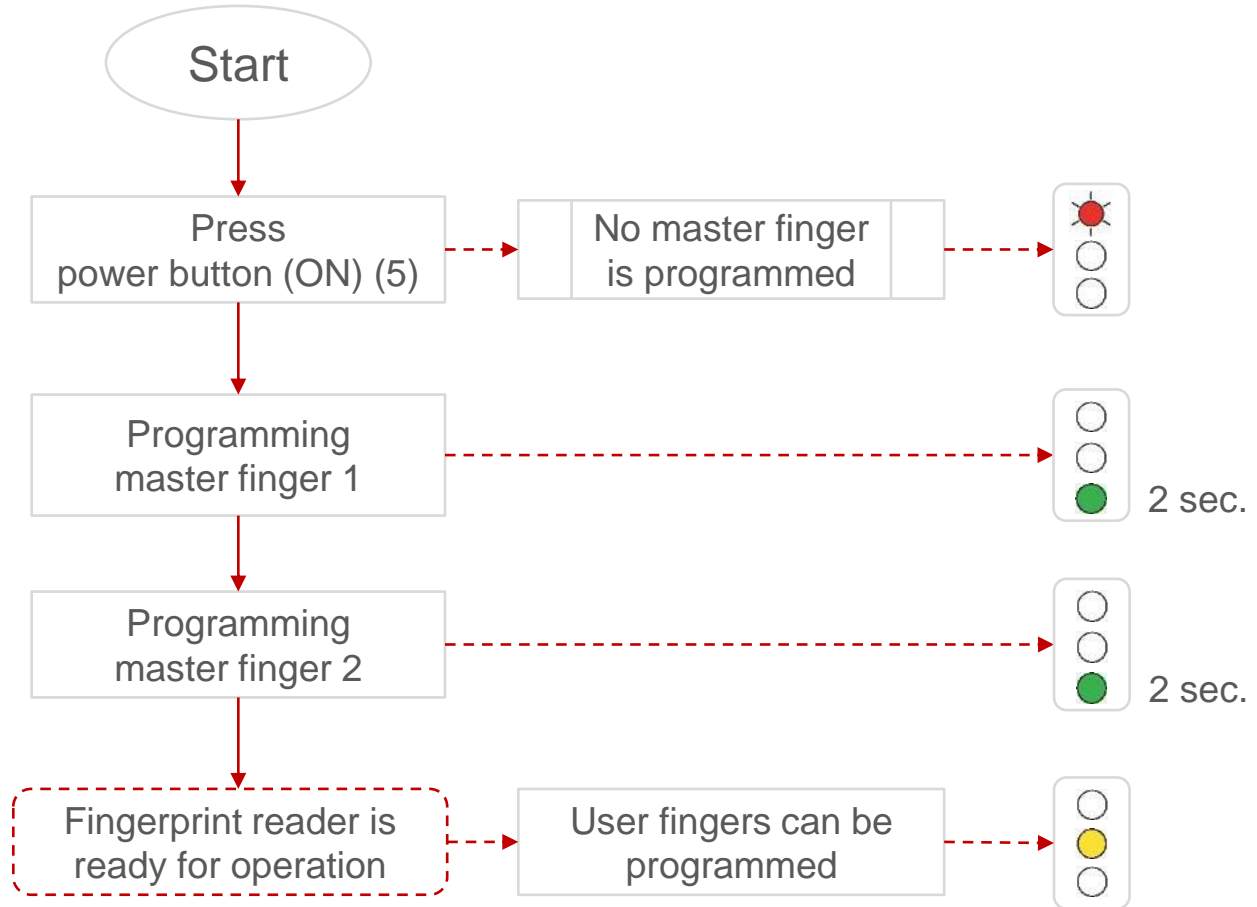
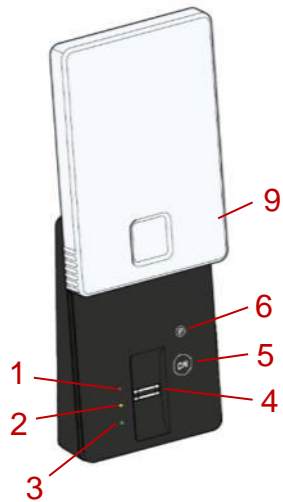

## Programming | User-fingers

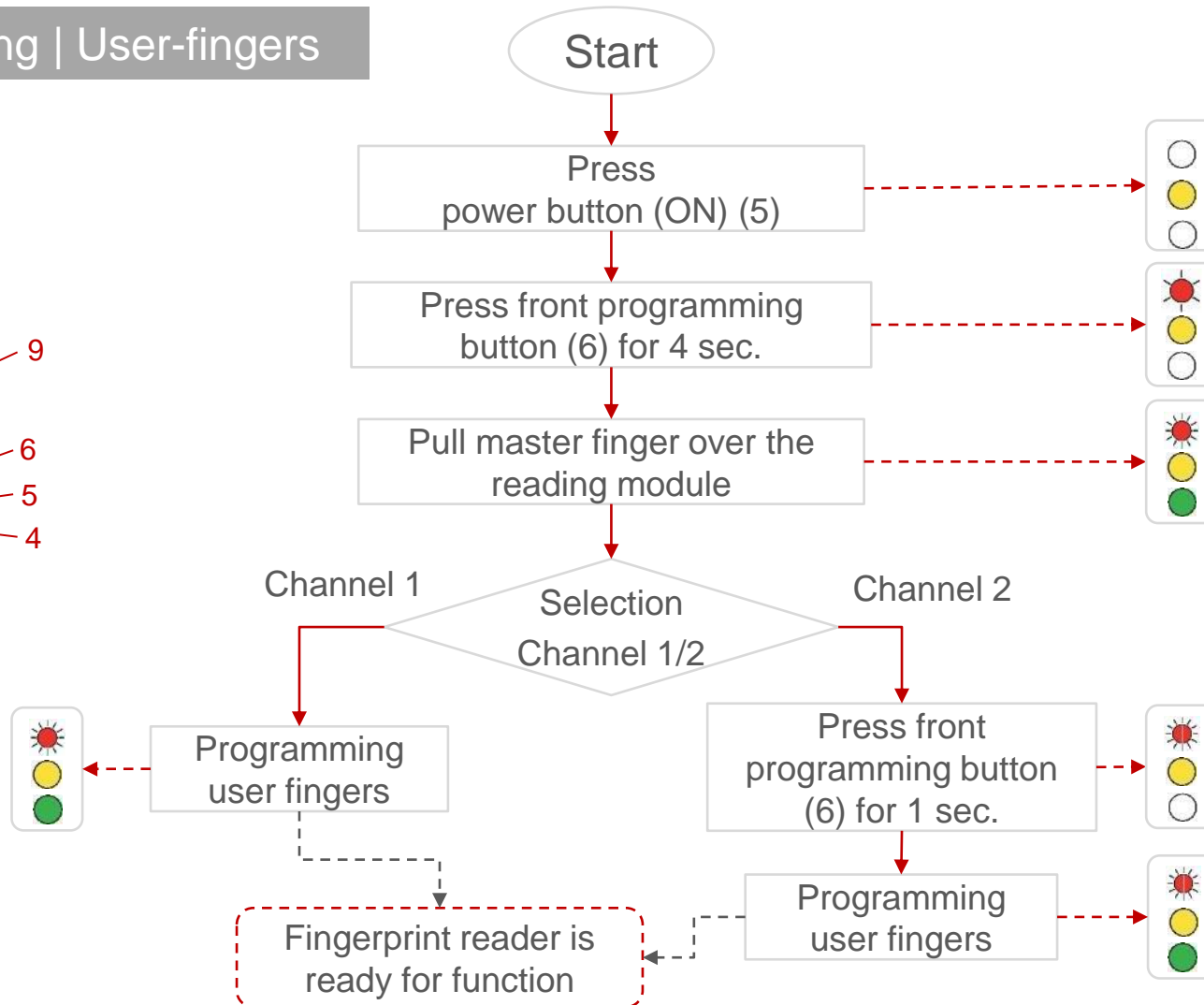
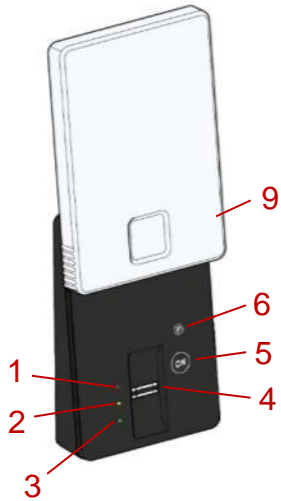

## Programming | Fingerprint reader

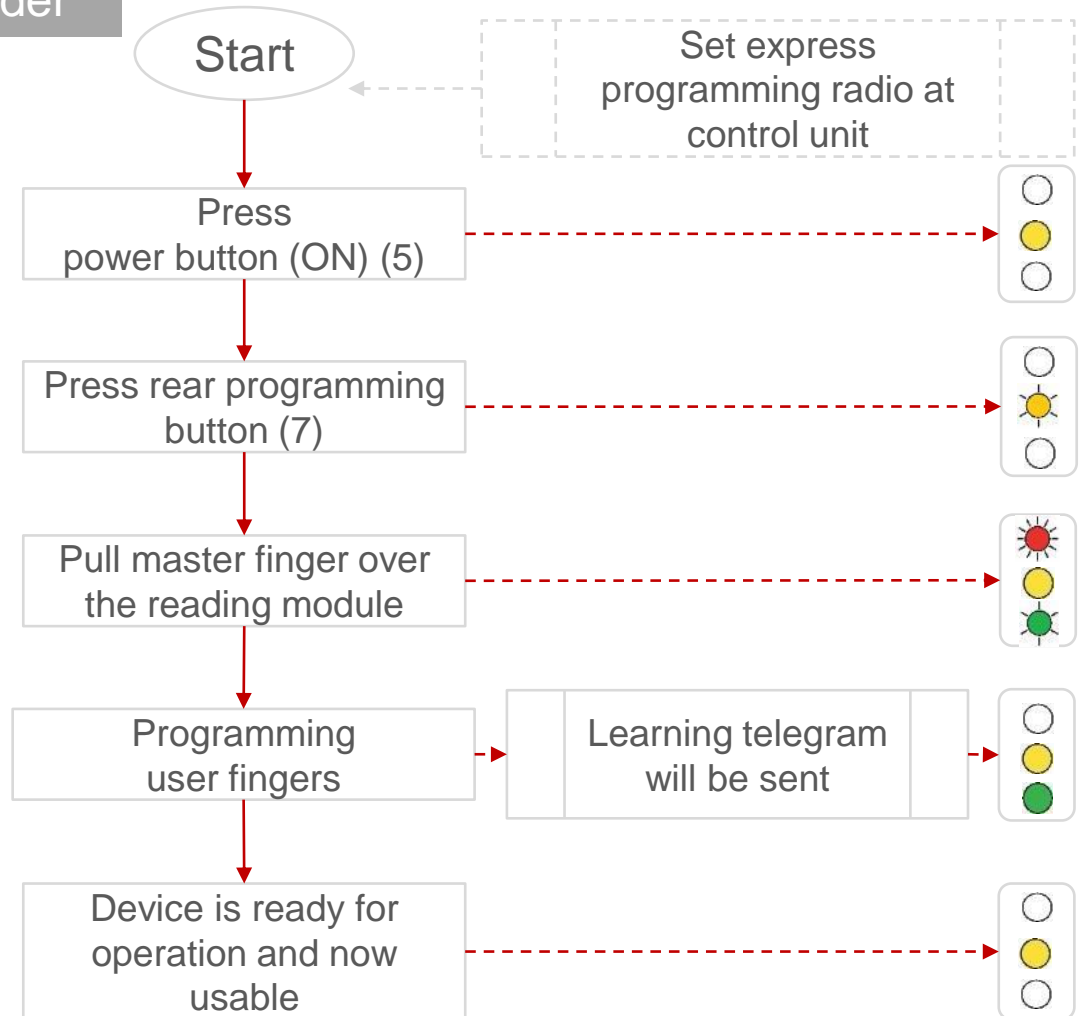
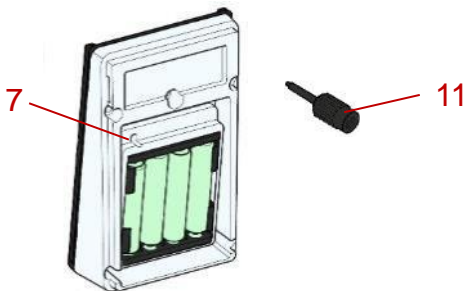
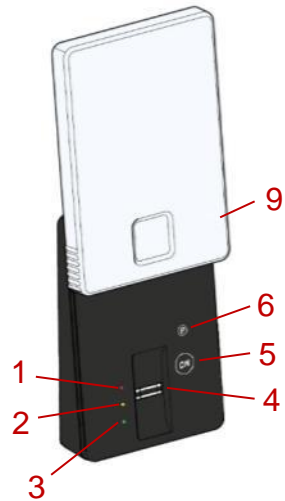



## Trigger function

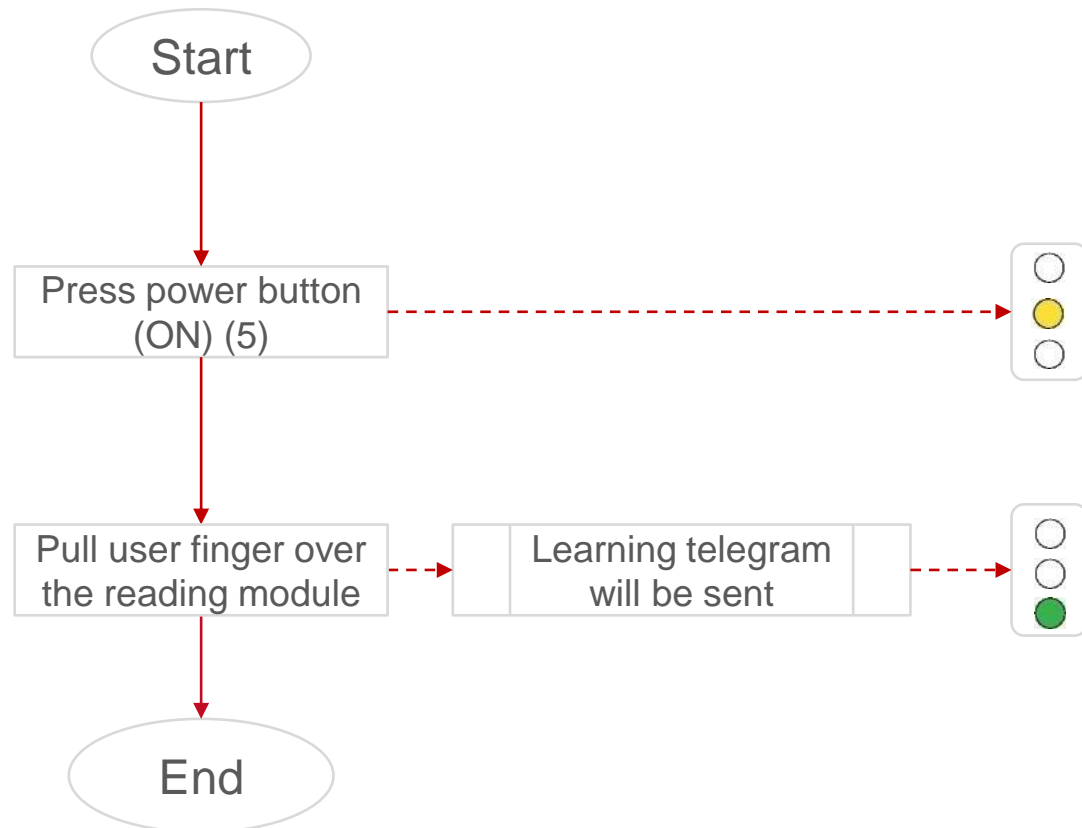
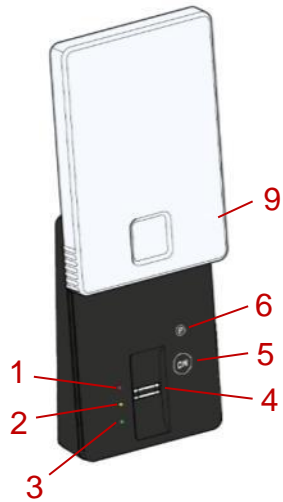

## Delete user finger

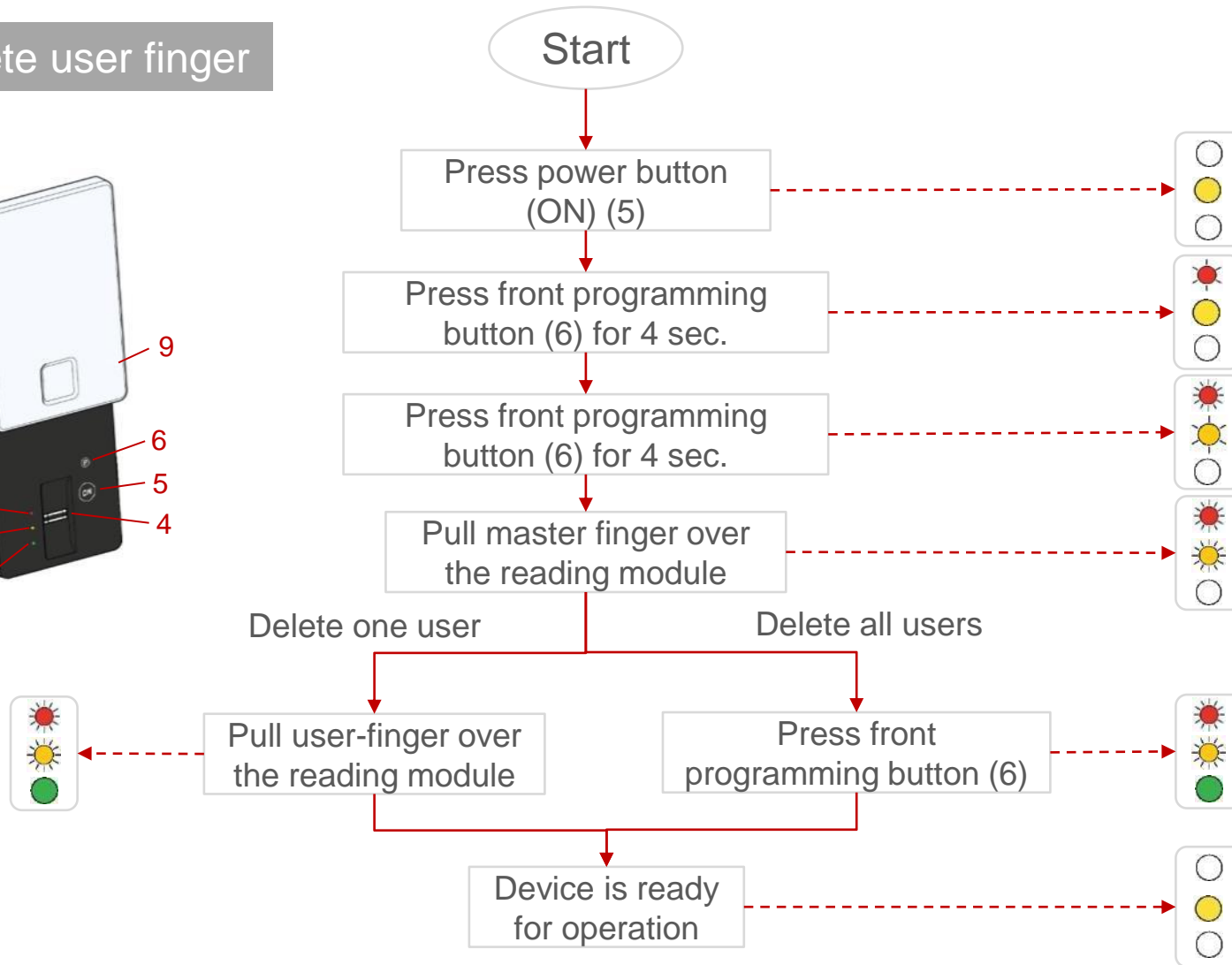
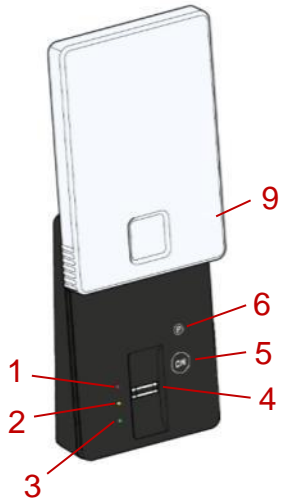

## Reset

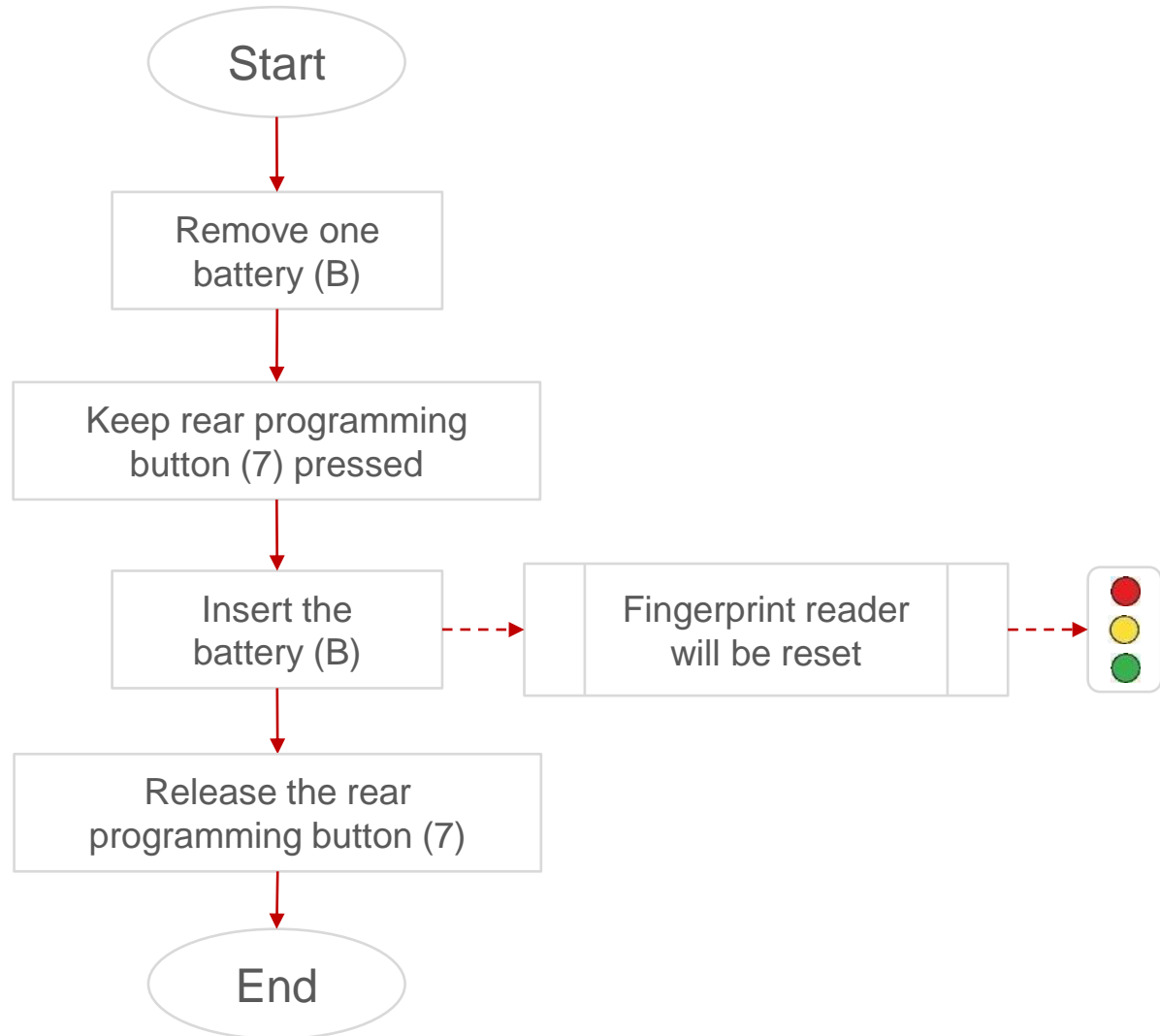
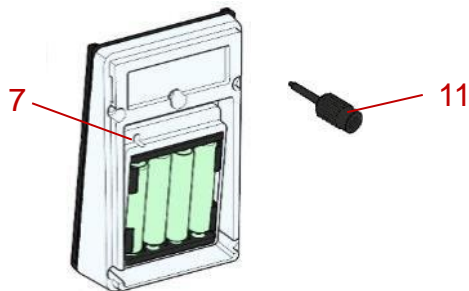
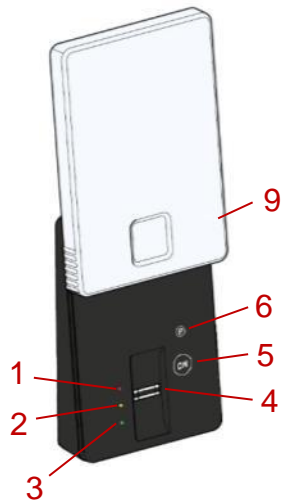

Have you any questions about **bi-linked**?

Thank you very much  
for your attention.