

Garagentorantriebe | Garage door openers



Produkthandbuch | Product handbook

Terms of payment

Prices are in Euro, ex works ex VAT. Freight, postage and costs for packaging will be added to the price.

Payment: Payment in advance, net.

This list supersedes and invalidates all previous dealer price lists.

Garage door openers



Please find our warranty conditions on our website under 'Service'.

Opener systems for garage doors	5
Opener system for underground and collective garages	12
Opener rails	14
Accessories	16

Radio accessories bi-linked

Hand transmitter	50
Wall transmitter	52
Module receivers	53
Universal receivers	53
Miscellaneous	55

Radio accessories Multi-Bit

Hand transmitter	56
Wall transmitter	59
Module aerials	61
Universal receivers	61
Universal transmitter	65
Miscellaneous	66

General accessories

Push buttons	68
Key switches	71
Transponder systems	72
Timer	73
Induction loops	74
Signal lights	75
Photocells	78

Comfort 360

Opener systems for garage doors

Marantec
Antriebstechnik



blueline

[EOS] EASY
OPERATING
SYSTEM

MSBUS



Comfort 360

ARTICLE	ARTICLE NO.	PRICE EACH
Comfort 360	115 328	253.00 €

PACKAGE

- Motor unit with integrated control unit
- Digital 921 module receiver, 868 MHz bi-linked
- Digital 663 mini hand transmitter 3-channel, 868 MHz bi-linked
- Digital 572 micro hand transmitter 2-channel, 868 MHz bi-linked
- Universal mounting kit for up-and-over doors and sectional doors
- Power cord with Europlug, 1.500 mm

ELECTRICAL DETAILS

Nominal voltage	230 V AC
Nominal frequency	50/60 Hz
Power consumption	1.1 A
Power input in operation	0.25 KW
Power input stand-by	approx. 0.6 W
Operation mode (duty cycle)	S2-2 min
Motor voltage	24 V DC
Control voltage	24 V DC
Protection category	(motor unit) IP 20
Protection class	II

MECHANICAL DETAILS

Push and pull force	max. 650 N
Door travel speed	max. 220 mm/s
Opening time (door-specific)	approx. 9.5 s

GENERAL DETAILS

Measurements (WxHxD)	(motor unit) 360x135x335 mm (packing) 375x150x500 mm
Weight (total)	approx. 7.4 kg
Range of temperature	-20 °C to +60 °C
Illuminant	2 10-LED-modules

FUNCTION

- Economy mode blueLine
- High speed function speed
- Electronic travel cut-out
- Soft start/soft stop/soft run
- Electronic push-open security
- Anti-blocking device
- Excess travel stop
- Release using pull rope (inside)
- Motor head rotatable by +/- 90°
- Marantec EOS programming with LC-display
- Direction of rotation programmable
- Back jump (stress relief of the closing edge)
- Automatic closing function
(only usable in combination with a photocell)
- Door open duration and warning time programmable
- Lighting duration programmable and switchable via radio
- Automatic cut-out OPEN and CLOSE separately programmable
- Intermediate position OPEN and CLOSE separately programmable
- Door travel speed OPEN and CLOSE separately programmable
- Soft run position OPEN and CLOSE separately programmable
- Soft run speed OPEN and CLOSE separately programmable
- Door frame function (suppression of photocells in the door-frame)
- Programmable impulse input and output
- Servicing counter (interval programmable) and door cycle counter
- Fault messages with memory
- Multistage reset function (control unit, safety, remote etc.)
- Connection (conventional) for push button, photocell and hold circuit
- Connection (MS-Bus) for expansion boards
- Connection (MS-Bus) for hand programming device and expansion modules
- Connection for battery backup (back-up 100 integrable)
- Output 24 V DC, max. 50 mA

APPLICATION

- Opener system for garage doors - private use
- For up-and-over doors up to a door width of 3,500 mm and a door weight of 110 kg
- For single-walled sectional doors up to a door width of 5,000 mm and a door weight of 110 kg
- For double-walled sectional doors up to a door width of 3,000 mm and a door weight of 110 kg
- For retractable up-and-over doors and canopy doors up to a door width of 3,500 mm, a door height of 2,250 mm and a door weight of 110 kg
- In combination with Marantec opener rails

Garage door openers

Radio accessories bi-linked

Radio accessories Multi-Bit

General accessories

Comfort 370

Opener systems for garage doors



blueline

EOS EASY
OPERATING
SYSTEM

MSBUS



Comfort 370

ARTICLE	ARTICLE NO.	PRICE EACH
Comfort 370	115 329	283.00 €

PACKAGE

- Motor unit with integrated control unit
- Digital 921 module receiver, 868 MHz bi-linked
- Digital 663 mini hand transmitter 3-channel, 868 MHz bi-linked
- Digital 572 micro hand transmitter 2-channel, 868 MHz bi-linked
- Universal mounting kit for up-and-over doors and sectional doors
- Power cord with Europlug, 1.500 mm

ELECTRICAL DETAILS

Nominal voltage	230 V AC
Nominal frequency	50/60 Hz
Power consumption	1.1 A
Power input in operation	0.25 KW
Power input stand-by	approx. 0.6 W
Operation mode (duty cycle)	S2-2 min
Motor voltage	24 V DC
Control voltage	24 V DC
Protection category	(motor unit) IP 20
Protection class	II

MECHANICAL DETAILS

Push and pull force	max. 850 N
Door travel speed	max. 235 mm/s
Opening time (door-specific)	approx. 9.0 s

GENERAL DETAILS

Measurements (WxHxD)	(motor unit) 360x135x335 mm (packing) 375x150x500 mm
Weight (total)	approx. 7.4 kg
Range of temperature	-20 °C to +60 °C
Illuminant	2 10-LED-modules

FUNCTION

- Economy mode blueLine
- High speed function speed
- Electronic travel cut-out
- Soft start/soft stop/soft run
- Electronic push-open security
- Anti-blocking device
- Excess travel stop
- Release using pull rope (inside)
- Motor head rotatable by +/- 90°
- Marantec EOS programming with LC-display
- Direction of rotation programmable
- Back jump (stress relief of the closing edge)
- Automatic closing function
(only usable in combination with a photocell)
- Door open duration and warning time programmable
- Lighting duration programmable and switchable via radio
- Automatic cut-out OPEN and CLOSE separately programmable
- Intermediate position OPEN and CLOSE separately programmable
- Door travel speed OPEN and CLOSE separately programmable
- Soft run position OPEN and CLOSE separately programmable
- Soft run speed OPEN and CLOSE separately programmable
- Door frame function (suppression of photocells in the door-frame)
- Programmable impulse input and output
- Servicing counter (interval programmable) and door cycle counter
- Fault messages with memory
- Multistage reset function (control unit, safety, remote etc.)
- Connection (conventional) for push button, photocell and hold circuit
- Connection (MS-Bus) for expansion boards
- Connection (MS-Bus) for hand programming device and expansion modules
- Connection for battery backup (back-up 100 integrable)
- Output 24 V DC, max. 50 mA

APPLICATION

- Opener system for garage doors - private use
- For up-and-over doors up to a door width of 5,000 mm and a door weight of 185 kg
- For single-walled sectional doors up to a door width of 5,500 mm and a door weight of 185 kg
- For double-walled sectional doors up to a door width of 5,500 mm and a door weight of 185 kg
- For retractable up-and-over doors and canopy doors up to a door width of 5,000 mm, a door height of 2,250 mm and a door weight of 185 kg
- In combination with Marantec opener rails

Comfort 380

Opener systems for garage doors

Marantec
Antriebstechnik



blueline

[EOS] EASY
OPERATING
SYSTEM

MSBUS



Comfort 380

ARTICLE	ARTICLE NO.	PRICE EACH
Comfort 380	115 330	343.00 €

PACKAGE

- Motor unit with integrated control unit
- Digital 921 module receiver, 868 MHz bi-linked
- Digital 663 mini hand transmitter 3-channel, 868 MHz bi-linked
- Digital 572 micro hand transmitter 2-channel, 868 MHz bi-linked
- Universal mounting kit for up-and-over doors and sectional doors
- Power cord with Europlug, 1.500 mm

ELECTRICAL DETAILS

Nominal voltage	230 V AC
Nominal frequency	50/60 Hz
Power consumption	1.1 A
Power input in operation	0.25 KW
Power input stand-by	approx. 0.6 W
Operation mode (duty cycle)	S2-5 min
Motor voltage	24 V DC
Control voltage	24 V DC
Protection category	(motor unit) IP 20
Protection class	II

MECHANICAL DETAILS

Push and pull force	max. 1,100 N
Door travel speed	max. 180 mm/s
Opening time (door-specific)	approx. 12 s

GENERAL DETAILS

Measurements (WxHxD)	(motor unit) 360x135x335 mm (packing) 375x150x500 mm
Weight (total)	approx. 7.5 kg
Range of temperature	-20 °C to +60 °C
Illuminant	2 10-LED-modules

FUNCTION

- Economy mode blueLine
- High speed function speed
- Electronic travel cut-out
- Soft start/soft stop/soft run
- Electronic push-open security
- Anti-blocking device
- Excess travel stop
- Release using pull rope (inside)
- Motor head rotatable by +/- 90°
- Marantec EOS programming with LC-display
- Direction of rotation programmable
- Back jump (stress relief of the closing edge)
- Automatic closing function
(only usable in combination with a photocell)
- Door open duration and warning time programmable
- Lighting duration programmable and switchable via radio
- Automatic cut-out OPEN and CLOSE separately programmable
- Intermediate position OPEN and CLOSE separately programmable
- Door travel speed OPEN and CLOSE separately programmable
- Soft run position OPEN and CLOSE separately programmable
- Soft run speed OPEN and CLOSE separately programmable
- Door frame function (suppression of photocells in the door-frame)
- Programmable impulse input and output
- Servicing counter (interval programmable) and door cycle counter
- Fault messages with memory
- Multistage reset function (control unit, safety, remote etc.)
- Connection (conventional) for push button, photocell and hold circuit
- Connection (MS-Bus) for expansion boards
- Connection (MS-Bus) for hand programming device and expansion modules
- Connection for battery backup (back-up 100 integrable)
- Output 24 V DC, max. 50 mA

APPLICATION

- Opener system for garage doors - private use
- For up-and-over doors up to a door width of 6,000 mm and a door weight of 220 kg
- For single-walled sectional doors up to a door width of 6,000 mm and a door weight of 220 kg
- For double-walled sectional doors up to a door width of 6,000 mm and a door weight of 220 kg
- For retractable up-and-over doors and canopy doors up to a door width of 6,000 mm, a door height of 2,250 mm and a door weight of 220 kg
- In combination with Marantec opener rails

Garage door openers

Radio accessories bi-linked

Radio accessories Multi-Bit

General accessories

Comfort 260

Opener systems for garage doors

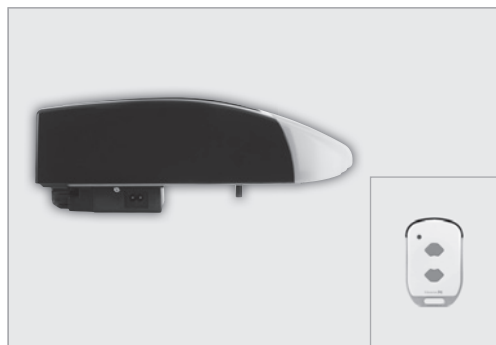

Comfort 260

ARTICLE	ARTICLE NO.	PRICE EACH
Comfort 260	115 325	197.00 €

PACKAGE

- Motor unit with integrated control unit
- Digital 921 module receiver, 868 MHz bi-linked
- Digital 572 micro hand transmitter 2-channel, 868 MHz bi-linked
- Universal mounting kit for up-and-over doors and sectional doors
- Power cord with Europlug, 1.500 mm

ELECTRICAL DETAILS

Nominal voltage	230 V AC
Nominal frequency	50/60 Hz
Power consumption	1.1 A
Power input in operation	0.25 KW
Power input stand-by	approx. 4 W
Operation mode (duty cycle)	S2-2 min
Motor voltage	24 V DC
Control voltage	24 V DC
Protection category	(motor unit) IP 20
Protection class	II

MECHANICAL DETAILS

Push and pull force	max. 550 N
Door travel speed	max. 160 mm/s
Opening time (door-specific)	approx. 14 s

GENERAL DETAILS

Measurements (WxHxD)	(motor unit) 190x125x360 mm (packing) 245x145x500 mm
Weight (total)	approx. 6.4 kg
Range of temperature	-20 °C to +60 °C
Illuminant	8-LED-module

FUNCTION

- Economy mode
- Electronic travel cut-out
- Soft start/soft stop/soft run
- Electronic push-open security
- Anti-blocking device
- Excess travel stop
- Release using pull rope (inside)
- Motor head rotatable by +/- 90°
- Marantec EOS programming with LC-display
- Direction of rotation programmable
- Back jump (stress relief of the closing edge)
- Automatic closing function (only usable in combination with a photocell)
- Door open duration and warning time programmable
- Lighting duration programmable and switchable via radio
- Automatic cut-out OPEN and CLOSE separately programmable
- Intermediate position OPEN and CLOSE separately programmable
- Door travel speed OPEN and CLOSE separately programmable
- Soft run position OPEN and CLOSE separately programmable
- Soft run speed OPEN and CLOSE separately programmable
- Door frame function (suppression of photocells in the door-frame)
- Programmable impulse input and output
- Servicing counter (interval programmable) and door cycle counter
- Fault messages with memory
- Multistage reset function (control unit, safety, remote etc.)
- Connection (conventional) for push button, photocell and hold circuit
- Connection (MS-Bus) for expansion boards
- Connection (MS-Bus) for hand programming device and expansion modules
- Connection for battery backup
- Output 24 V DC, max. 50 mA

APPLICATION

- Opener system for garage doors - private use
- For up-and-over doors up to a door width of 3,500 mm and a door weight of 90 kg
- For single-walled sectional doors up to a door width of 5,000 mm and a door weight of 90 kg
- For double-walled sectional doors up to a door width of 3,000 mm and a door weight of 90 kg
- For retractable up-and-over doors and canopy doors up to a door width of 3,500 mm, a door height of 2,250 mm and a door weight of 90 kg
- In combination with Marantec opener rails

Comfort 270

Opener systems for garage doors

Marantec
Antriebstechnik

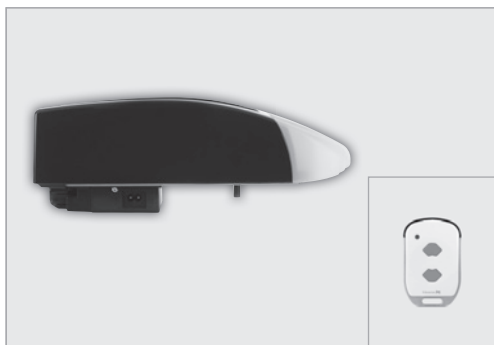

MSBUS



Comfort 270

ARTICLE	ARTICLE NO.	PRICE EACH
Comfort 270	115 326	223.00 €

PACKAGE

- Motor unit with integrated control unit
- Digital 921 module receiver, 868 MHz bi-linked
- Digital 572 micro hand transmitter 2-channel, 868 MHz bi-linked
- Universal mounting kit for up-and-over doors and sectional doors
- Power cord with Europlug, 1.500 mm

ELECTRICAL DETAILS

Nominal voltage	230 V AC
Nominal frequency	50/60 Hz
Power consumption	1.1 A
Power input in operation	0.25 KW
Power input stand-by	approx. 4 W
Operation mode (duty cycle)	S2-2 min
Motor voltage	24 V DC
Control voltage	24 V DC
Protection category	(motor unit) IP 20
Protection class	II

MECHANICAL DETAILS

Push and pull force	max. 750 N
Door travel speed	max. 160 mm/s
Opening time (door-specific)	approx. 14 s

GENERAL DETAILS

Measurements (WxHxD)	(motor unit) 190x125x360 mm (packing) 245x145x500 mm
Weight (total)	approx. 6.5 kg
Range of temperature	-20 °C to +60 °C
Illuminant	8-LED-module

FUNCTION

- Economy mode
- Electronic travel cut-out
- Soft start/soft stop/soft run
- Electronic push-open security
- Anti-blocking device
- Excess travel stop
- Release using pull rope (inside)
- Motor head rotatable by +/- 90°
- Marantec EOS programming with LC-display
- Direction of rotation programmable
- Back jump (stress relief of the closing edge)
- Automatic closing function (only usable in combination with a photocell)
- Door open duration and warning time programmable
- Lighting duration programmable and switchable via radio
- Automatic cut-out OPEN and CLOSE separately programmable
- Intermediate position OPEN and CLOSE separately programmable
- Door travel speed OPEN and CLOSE separately programmable
- Soft run position OPEN and CLOSE separately programmable
- Soft run speed OPEN and CLOSE separately programmable
- Door frame function (suppression of photocells in the door-frame)
- Programmable impulse input and output
- Servicing counter (interval programmable) and door cycle counter
- Fault messages with memory
- Multistage reset function (control unit, safety, remote etc.)
- Connection (conventional) for push button, photocell and hold circuit
- Connection (MS-Bus) for expansion boards
- Connection (MS-Bus) for hand programming device and expansion modules
- Connection for battery backup
- Output 24 V DC, max. 50 mA

APPLICATION

- Opener system for garage doors - private use
- For up-and-over doors up to a door width of 5,000 mm and a door weight of 165 kg
- For single-walled sectional doors up to a door width of 5,500 mm and a door weight of 165 kg
- For double-walled sectional doors up to a door width of 5,500 mm and a door weight of 165 kg
- For retractable up-and-over doors and canopy doors up to a door width of 5.000 mm, a door height of 2,250 mm and a door weight of 165 kg
- In combination with Marantec opener rails

Garage door openers

Radio accessories bi-linked

Radio accessories Multi-Bit

General accessories

Comfort 280

Opener systems for garage doors

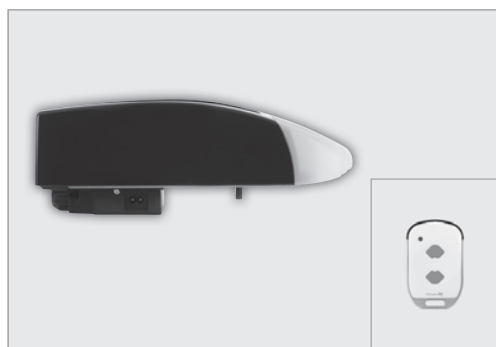

Comfort 280

ARTICLE	ARTICLE NO.	PRICE EACH
Comfort 280	115 327	261.00 €

PACKAGE

- Motor unit with integrated control unit
- Digital 921 module receiver, 868 MHz bi-linked
- Digital 572 micro hand transmitter 2-channel, 868 MHz bi-linked
- Universal mounting kit for up-and-over doors and sectional doors
- Power cord with Europlug, 1.500 mm

ELECTRICAL DETAILS

Nominal voltage	230 V AC
Nominal frequency	50/60 Hz
Power consumption	1.1 A
Power input in operation	0.25 KW
Power input stand-by	approx. 4 W
Operation mode (duty cycle)	S2-2 min
Motor voltage	24 V DC
Control voltage	24 V DC
Protection category	(motor unit) IP 20
Protection class	II

MECHANICAL DETAILS

Push and pull force	max. 1,000 N
Door travel speed	max. 160 mm/s
Opening time (door-specific)	approx. 14 s

GENERAL DETAILS

Measurements (WxHxD)	(motor unit) 190x125x360 mm (packing) 245x145x500 mm
Weight (total)	approx. 6.6 kg
Range of temperature	-20 °C to +60 °C
Illuminant	8-LED-module

FUNCTION

- Economy mode
- Electronic travel cut-out
- Soft start/soft stop/soft run
- Electronic push-open security
- Anti-blocking device
- Excess travel stop
- Release using pull rope (inside)
- Motor head rotatable by +/- 90°
- Marantec EOS programming with LC-display
- Direction of rotation programmable
- Back jump (stress relief of the closing edge)
- Automatic closing function
(only usable in combination with a photocell)
- Door open duration and warning time programmable
- Lighting duration programmable and switchable via radio
- Automatic cut-out OPEN and CLOSE separately programmable
- Intermediate position OPEN and CLOSE separately programmable
- Door travel speed OPEN and CLOSE separately programmable
- Soft run position OPEN and CLOSE separately programmable
- Soft run speed OPEN and CLOSE separately programmable
- Door frame function (suppression of photocells in the door-frame)
- Programmable impulse input and output
- Servicing counter (interval programmable) and door cycle counter
- Fault messages with memory
- Multistage reset function (control unit, safety, remote etc.)
- Connection (conventional) for push button, photocell and hold circuit
- Connection (MS-Bus) for expansion boards
- Connection (MS-Bus) for hand programming device and expansion modules
- Connection for battery backup
- Output 24 V DC, max. 50 mA

APPLICATION

- Opener system for garage doors - private use
- For up-and-over doors up to a door width of 6,000 mm and a door weight of 200 kg
- For single-walled sectional doors up to a door width of 6,000 mm and a door weight of 200 kg
- For double-walled sectional doors up to a door width of 6,000 mm and a door weight of 200 kg
- For retractable up-and-over doors and canopy doors up to a door width of 6,000 mm, a door height of 2,250 mm and a door weight of 200 kg
- In combination with Marantec opener rails

Comfort 260 accu

Opener systems for garage doors

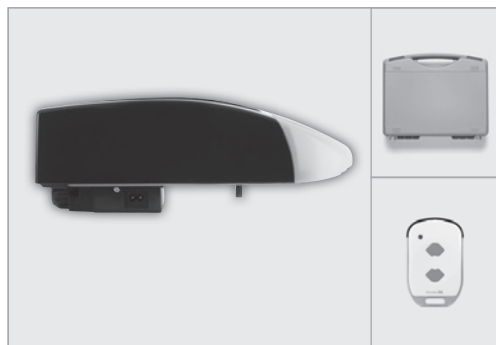

[EOS] EASY
OPERATING
SYSTEM



Comfort 260 accu

ARTICLE	ARTICLE NO.	PRICE EACH
Comfort 260 accu	118 816	438.00 €

PACKAGE

- Motor unit with integrated control unit, pre-cabled 5,000 mm
- Accu 700 accumulator unit with charging regulator
- Charger
- Digital 911 module receiver, 868 MHz bi-linked
- Digital 572 micro hand transmitter 2-channel, 868 MHz bi-linked
- Universal mounting kit for up-and-over doors and sectional doors

ELECTRICAL DETAILS

Nominal voltage	24 V DC
Accumulator capacity	7.2 Ah
Power input in operation	0.12 KW
Power input in stand-by	0.05 W
Operation mode (duty cycle)	S2–2 min
Motor voltage	24 V DC
Control voltage	24 V DC
Protection category	(motor unit) IP 20
Protection class	(accumulator unit) IP 20
	III

MECHANICAL DETAILS

Push and pull force	max. 550 N
Door travel speed	max. 160 mm/s
Opening time (door specific)	14 s

GENERAL DETAILS

Measurements (WxHxD)	(motor unit) 190x125x360 mm (accumulator unit) 280x230x80 mm
Weight (total)	(motor unit) 6.4 kg (accumulator unit) 6.0 kg
Range of temperature	(motor unit) –20 °C to +60 °C (accumulator unit) –15 °C to +45 °C
Illuminant	8-LED-module

FUNCTION

- Economy mode
- Electronic travel cut-out
- Soft start/soft stop/soft run
- Electronic push-open security
- Anti-blocking device
- Excess travel stop
- Release using pull rope (inside)
- Motor head rotatable by +/- 90°
- Marantec EOS programming with LC-display
- Direction of rotation programmable
- Back jump (stress relief of the closing edge)
- Automatic closing function
(only usable in combination with a photocell)
- Door open duration and warning time programmable
- Lighting duration programmable
- Automatic cut-out OPEN and CLOSE separately programmable
- Intermediate position OPEN and CLOSE separately programmable
- Door travel speed OPEN and CLOSE separately programmable
- Soft run position OPEN and CLOSE separately programmable
- Soft run speed OPEN and CLOSE separately programmable
- Door frame function (suppression of photocells in the door-frame)
- Programmable impulse input
- Servicing counter (interval programmable) and door cycle counter
- Fault messages with memory
- Multistage reset function (control unit, safety, remote etc.)
- Connection (conventional) for push button, photocell and hold circuit
- Output 24 V DC, max. 50 mA

APPLICATION

- Opener system for garage doors - private use
- For up-and-over doors up to a door width of 3,500 mm and a door weight of 90 kg
- For single-walled sectional doors up to a door width of 5,000 mm and a door weight of 90 kg
- For double-walled sectional doors up to a door width of 3,000 mm and a door weight of 90 kg
- For retractable up-and-over doors and canopy doors up to a door width of 3,500 mm, a door height of 2,250 mm and a door weight of 90 kg
- Approx. 30 days of usage at 4 cycles per day (depending on e.g. ambient temperature etc.)
- In combination with Marantec opener rails

Comfort 257.2

Opener systems for underground and collective garages



EOS EASY
OPERATING
SYSTEM

MSBUS

Comfort 257.2

ARTICLE	ARTICLE NO.	PRICE EACH
Comfort 257.2 with small control unit housing	90 583	495.00 €
with large control unit housing	96 557	539.00 €

PACKAGE

- Motor unit, pre-cabled
- Separate control unit Control vario, pre-cabled
- Universal mounting kit for up-and-over doors and sectional doors

ELECTRICAL DETAILS

Nominal voltage	230 V AC
Nominal frequency	50/60 Hz
Power consumption	0.7 A
Power input in operation	0.26 KW
Power input stand-by	3.6 W
Operation mode (duty cycle)	S2–5 min
Motor voltage	24 V DC
Control voltage	24 V DC
Protection category	(motor unit) IP 20 (control unit) IP 54
Protection class	II

MECHANICAL DETAILS

Push and pull force	1,000 N
Door travel speed	140 mm/s
Opening time (door-specific)	approx. 15 s

GENERAL DETAILS

Measurements (WxHxD)	(motor unit) 220x125x395 mm (control unit, small) 240x150x80 mm (control unit, large) 240x300x80 mm
Weight with control unit, small (total)	8.6 kg
Weight with control unit, large (total)	9.1 kg
Range of temperature	–20 °C to +60 °C
Illuminant (energy-saving bulb)	11 W/E14

FUNCTION

- Economy mode
- Electronic travel cut-out
- Soft start/soft stop/soft run
- Electronic push-open security
- Anti-blocking device
- Excess travel stop
- Release using pull rope (inside)
- Marantec EOS programming via LED
- Automatic closing function
- Door open duration and warning time programmable
- Lighting duration programmable
- Automatic cut-out OPEN and CLOSE separately programmable
- Intermediate position OPEN and CLOSE separately programmable
- Door travel speed OPEN and CLOSE separately programmable
- Soft run position OPEN and CLOSE separately programmable
- Soft run speed OPEN and CLOSE separately programmable
- Door frame function (suppression of photocells in the door-frame)
- Programmable impulse input and output
- Servicing counter (interval programmable) and door cycle counter
- Fault indication
- Reset function
- Connection (conventional) for push button and photocell
- Connection potential-free end position information
- Connection for signal light, programmable
- Connection wiping impulse
- Connection (MS-Bus) for expansion modules
- Connection for closing edge safety device
- Output 24 V DC, max. 50 mA

APPLICATION

- Opener system for underground and collective garages
- For up-and over doors up to a door width of 6,000 mm and a door weight of 200 kg
- For single-walled sectional doors up to a door width of 6,000 mm and a door weight of 200 kg
- For double-walled sectional doors up to a door width of 6,000 mm and a door weight of 200 kg
- In combination with Marantec opener rails

Opener rails

Opener systems for garage doors



Toothed drive belt, 1-part (0.8 mm)

ARTICLE	ARTICLE NO.	PRICE EACH
SZ 11-SL, 1-part	104 282	115.00 €
Total length	3,080 mm	
Length of travel	2,475 mm	
Packing length	3,140 mm	
Weight	4.7 kg	

ARTICLE	ARTICLE NO.	PRICE EACH
SZ 12-SL, 1-part	104 283	156.00 €
Total length	3,330 mm	
Length of travel	2,725 mm	
Packing length	3,380 mm	
Weight	5.0 kg	

ARTICLE	ARTICLE NO.	PRICE EACH
SZ 13-SL, 1-part	105 010	196.00 €
Total length	4,090 mm	
Length of travel	3,485 mm	
Packing length	4,140 mm	
Weight	6.2 kg	

ARTICLE	ARTICLE NO.	PRICE EACH
SZ S, 1-part special length	103 535	on request
Total length max. 6,500 mm		

PACKAGE

- Micro-profiled opener rail with 0.8 mm profile thickness, 1-part

FUNCTION / APPLICATION

- To transmit the power from the opener system to the door
- SafeLock system: Punching holes in the rail profile for extending with Special 108 (except special length rails)
- The rail length depends on the door height and on the door brand
- For the opener systems
Comfort 260, 270, 280, 360, 370, 380, 260 accu, 257.2



Toothed drive belt, 2-part (0.8 mm)

ARTICLE	ARTICLE NO.	PRICE EACH
SZ 11-SL, 2-part	115 165	115.00 €
Total length	3,080 mm	
Length of travel	2,475 mm	
Packing length	1,600 mm	
Weight	5.4 kg	

ARTICLE	ARTICLE NO.	PRICE EACH
SZ 12-SL, 2-part	115 167	156.00 €
Total length	3,330 mm	
Length of travel	2,725 mm	
Packing length	1,725 mm	
Weight	5.9 kg	

ARTICLE	ARTICLE NO.	PRICE EACH
SZ 13-SL, 2-part	115 168	196.00 €
Total length	4,090 mm	
Length of travel	3,485 mm	
Packing length	2,100 mm	
Weight	7.0 kg	

ARTICLE	ARTICLE NO.	PRICE EACH
SZ S, 1-part special length	103 537	on request
Total length max. 8,000 mm		

PACKAGE

- Micro-profiled opener rail with 0.8 mm profile thickness, 2-part
- Rail connector
- Mounting material

FUNCTION / APPLICATION

- To transmit the power from the opener system to the door
- SafeLock system: Punching holes in the rail profile for extending with Special 108 (except special length rails)
- The rail length depends on the door height and on the door brand
- For the opener systems
Comfort 260, 270, 280, 360, 370, 380, 260 accu, 257.2

Opener rails

Opener systems for garage doors



Toothed drive belt, 1-part (1.2 mm)

ARTICLE	ARTICLE NO.	PRICE EACH
SZ 11-S, 1-part	114 582	139.00 €
Total length	3,080 mm	
Length of travel	2,475 mm	
Packing length	3,140 mm	
Weight	4.7 kg	

ARTICLE	ARTICLE NO.	PRICE EACH
SZ 12-S, 1-part	114 583	184.00 €
Total length	3,330 mm	
Length of travel	2,725 mm	
Packing length	3,380 mm	
Weight	5.0 kg	

ARTICLE	ARTICLE NO.	PRICE EACH
SZ 13-S, 1-part	114 584	229.00 €
Total length	4,090 mm	
Length of travel	3,485 mm	
Packing length	4,140 mm	
Weight	6.2 kg	

ARTICLE	ARTICLE NO.	PRICE EACH
SZ S, 1-part special length	103 621	on request
Total length max. 6,500 mm		

PACKAGE

- Micro-profiled opener rail with 1.2 mm profile thickness and ball bearing, 1-part

FUNCTION / APPLICATION

- To transmit the power from the opener system to the door
- SafeLock system: Punching holes in the rail profile for extending with Special 108 (except special length rails)
- The rail length depends on the door height and on the door brand
- For the opener systems
Comfort 260, 270, 280, 360, 370, 380, 260 accu, 257.2

Accessories

Opener systems for garage doors

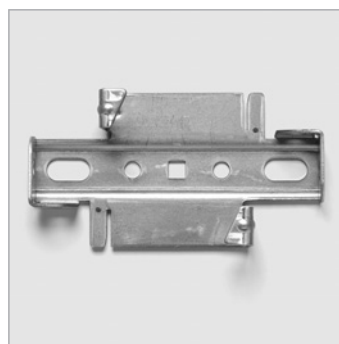

Connection cross bar

ARTICLE	ARTICLE NO.	PRICE EACH
Connection cross bar	87 577	47.00 €
Extension for connection cross bar	97 105	70.00 €

PACKAGE

Article no. 87 577:

- Connection cross bar
- Mounting material
- Sales unit: 10 no.

Article no. 97 105:

- Extension
- Mounting material
- Sales unit: 10 no.

FUNCTION / APPLICATION

Article no. 87 577:

- Easy mounting by means of connection cross bar (alternative to a complex ceiling suspension at the motor unit)
- Height adjustment of 60 to 85 mm between opener rail and fixation at the cross bar
- For the Marantec opener rails

Article no. 97 105:

- Extension of the connection cross bar by 30 to 50 mm

TECHNICAL DETAILS / SPECIFICATIONS

Suspension cramp

ARTICLE	ARTICLE NO.	PRICE EACH
Suspension cramp for fixing the opener rails	90 870	34.00 €

PACKAGE

· Suspension cramp

· Sales unit: 10 no.

FUNCTION / APPLICATION

· For an additional fixing of opener rails with special length

· For the Marantec opener rails

TECHNICAL DETAILS / SPECIFICATIONS

Accessories

Opener systems for garage doors



Cable clip

ARTICLE	ARTICLE NO.	PRICE EACH
Plastic clip for the fixation of cables to the opener rail	76 728	19.00 €

PACKAGE

- Plastic clip
- Sales unit: 50 no.

FUNCTION / APPLICATION

- For the fixation of system and round cables to the opener rail
- For the Marantec opener rails

TECHNICAL DETAILS / SPECIFICATIONS



Mounting aid

ARTICLE	ARTICLE NO.	PRICE EACH
Mounting aid	66 427	38.00 €

PACKAGE

- Mounting aid
- Sales unit: 1 no.

FUNCTION / APPLICATION

- The mounting aid can be extended and fixed
- For a safe, quick and simple mounting
- For the Marantec opener rails

TECHNICAL DETAILS / SPECIFICATIONS

Length	1,600 to 2,900 mm
Max. load	50 kg

Accessories

Opener systems for garage doors



Special 101

ARTICLE	ARTICLE NO.	PRICE EACH
Connecting door bracket for sectional doors	564 611	34.00 €

PACKAGE

- Connecting door bracket, 2-part
- Curved door link
- Mounting material
- Sales unit: 1 no.

FUNCTION / APPLICATION

- Connection between door leaf and opener system
- Optimal push and pull force distribution
- For sectional doors with a section height from 300 to 531 mm

TECHNICAL DETAILS / SPECIFICATIONS



Special 111

ARTICLE	ARTICLE NO.	PRICE EACH
Connecting door bracket for sectional doors	47 574	22.00 €

PACKAGE

- Connecting door bracket, 2-part
- Curved door link
- Mounting material
- Sales unit: 1 no.

FUNCTION / APPLICATION

- Connection between door leaf and opener system, adjustable
- Optimal push and pull force distribution
- For sectional doors with a section height from 300 to 562 mm

TECHNICAL DETAILS / SPECIFICATIONS



Special 103

ARTICLE	ARTICLE NO.	PRICE EACH
Fitting for side hinged double doors	564 867	176.00 €

PACKAGE

- Fitting for side hinged double door
- Mounting material
- Sales unit: 1 no.

FUNCTION / APPLICATION

- Connection between door wing and opener system
- Door wings will be opened to the outside
- For garages with side hinged double doors

TECHNICAL DETAILS / SPECIFICATIONS

Measurements (L) 2,600 mm



152 114



150 082, 564 868, 564 871

Special 104

ARTICLE	ARTICLE NO.	PRICE EACH
Linking bar extension		
Extension max. Length		
240 mm 260 mm	152 114	4.00 €
1,060 mm 1,080 mm	150 082	41.00 €
2,625 mm 2,645 mm	564 868	59.00 €
3,500 mm 3,520 mm	564 871	77.00 €

PACKAGE

- Linking bar extension
- Mounting material
- Sales unit: 1 no.

FUNCTION / APPLICATION

- Relocation of the push and pull points, whenever the opener rail cannot be mounted to the lintel or above the door leave
- For up-and-over doors and sectional doors

TECHNICAL DETAILS / SPECIFICATIONS

Accessories

Opener systems for garage doors



Special 105

ARTICLE	ARTICLE NO.	PRICE EACH
Connecting door bracket for side sectional doors	8 055 637	102.00 €

PACKAGE

- Connecting door bracket
- Mounting material
- Sales unit: 1 no.

FUNCTION / APPLICATION

- Connection between door leaf and opener system
- For best power transmission in any door position
- Multi-joint function
- For side sectional doors

TECHNICAL DETAILS / SPECIFICATIONS

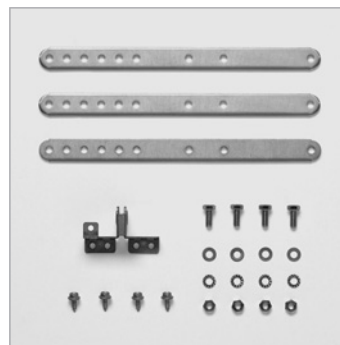

Special 106

ARTICLE	ARTICLE NO.	PRICE EACH
Connecting door bracket for side sectional doors	68 990	14.00 €

PACKAGE

- Connecting door bracket
- 3 door brackets, straight
- Mounting material
- Sales unit: 1 no.

FUNCTION / APPLICATION

- Connection between door leaf and opener system, adjustable
- Door lever tab, length adjustable, with console arm
- For side sectional doors

TECHNICAL DETAILS / SPECIFICATIONS

Accessories

Opener systems for garage doors



Special 108

ARTICLE	ARTICLE NO.	PRICE EACH
Push-open security device for opener rails	103 808	16.00 €

PACKAGE

- Pawl
- Rubber buffer
- Mounting plate
- Mounting material
- Sales unit: 1 no.

FUNCTION / APPLICATION

- Increased safety against pushing the door open
- In case of violent opening of the door the installed pawl locks into a punching hole of the opener rail to prevent the door opening
- To function properly, a distance between the ceiling and opener rail of at least 10 mm must be maintained
- In case of low headroom, where the angle between connection door bracket and opener rail is lower than 20°, a different connection door bracket has to be used, e.g. Special 101 or Special 111
- For the Marantec opener rails with SafeLock system (SL)

TECHNICAL DETAILS / SPECIFICATIONS

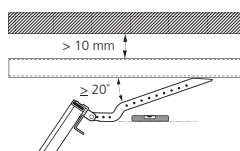

Special 201

ARTICLE	ARTICLE NO.	PRICE EACH
Unlocking kit for door lock	564 458	34.00 €

PACKAGE

- Unlocking kit
- Door connection bracket
- Mounting material
- Sales unit: 1 no.

FUNCTION / APPLICATION

- Unlocks the locking leverage
- For Hörmann up-and-over door N 80
- For doors with side bolt lock

TECHNICAL DETAILS / SPECIFICATIONS

Accessories

Opener systems for garage doors



Special 202

ARTICLE	ARTICLE NO.	PRICE EACH
Unlocking kit for door lock	564 459	35.00 €

PACKAGE

- Unlocking kit
- Door connection bracket
- Mounting material
- Sales unit: 1 no.

FUNCTION / APPLICATION

- The floor lock will be lifted before the start of the door by means of an angle lever
- For up-and-over doors/retractable up-and-over doors with centered door lock
- For doors with centered floor lock

TECHNICAL DETAILS / SPECIFICATIONS



Special 301

ARTICLE	ARTICLE NO.	PRICE EACH
Emergency release for up-and-over doors and retractable up-and-over doors	564 452	36.00 €

PACKAGE

- Interior handle
- Bowden cable
- Mounting material
- Sales unit: 1 no.

FUNCTION / APPLICATION

- After unlocking the opener carriage will be mechanically unlocked by means of a bowden cable via the exterior door handle, e.g. in case of power failure
- For up-and-over doors/retractable up-and-over doors

TECHNICAL DETAILS / SPECIFICATIONS

Length of bowden cable 3,000 mm



Special 302

ARTICLE	ARTICLE NO.	PRICE EACH
Emergency release for Hörmann sectional doors	564 453	35.00 €

PACKAGE

- Bowden cable
- Mounting material
- Sales unit: 1 no.

FUNCTION / APPLICATION

- After unlocking the opener carriage will be mechanically unlocked by means of a bowden cable via the exterior door handle, e.g. in case of power failure
- For Hörmann sectional doors

TECHNICAL DETAILS / SPECIFICATIONS

Length of bowden cable 4,500 mm



Special 303

ARTICLE	ARTICLE NO.	PRICE EACH
Emergency release for side sectional doors	154 517	68.00 €

PACKAGE

- Safety cylinder lock with 2 keys
- Lock insert
- Bowden cable
- Mounting material
- Sales unit: 1 no.

FUNCTION / APPLICATION

- The cylinder lock will be retrofitted into the door. A bowden cable connects the lock and the release of the opener system
- The opener system will be released by unlocking and pulling out the cylinder, e.g. in case of power failure
- Lock with safety cylinder
- For side sectional doors

TECHNICAL DETAILS / SPECIFICATIONS

Length of bowden cable 6,000 mm

Accessories

Opener systems for garage doors



Special 304

ARTICLE	ARTICLE NO.	PRICE EACH
Emergency release for sectional doors and swing gates		
700 mm	46 858	31.00 €
1,700 mm	60 798	37.00 €
2,500 mm	76 019	43.00 €

PACKAGE

- Safety cylinder lock with 2 keys
- Lock insert
- Bowden cable
- Mounting material
- Sales unit: 1 no.

FUNCTION / APPLICATION

- The cylinder lock will be retrofitted into the door. A bowden cable connects the lock and the release of the opener system
- The opener system will be released by unlocking and pulling out the cylinder, e.g. in case of power failure
- Lock with safety cylinder
- For sectional doors and opener systems for swing gates Comfort 515, 515 L, 516, 516 L

TECHNICAL DETAILS / SPECIFICATIONS

Length of bowden cable	700 mm
	1,700 mm
	2,500 mm



Special 305

ARTICLE	ARTICLE NO.	PRICE EACH
Emergency release for sectional doors and swing gates		
700 mm	96 290	26.00 €
1,700 mm	96 303	31.00 €
2,500 mm	96 307	36.00 €

PACKAGE

- Cylinder lock with 2 keys
- Bowden cable
- Mounting material
- Sales unit: 1 no.

FUNCTION / APPLICATION

- The cylinder lock will be retrofitted into the door. A bowden cable connects the lock and the release of the opener system
- The opener system will be released by unlocking and pulling out the cylinder, e.g. in case of power failure
- Lock with standard profile half cylinder
- For door profiles with a thickness of max. 50 mm
- For sectional doors and opener systems for swing gates Comfort 515, 515 L, 516, 516 L

TECHNICAL DETAILS / SPECIFICATIONS

Length of bowden cable	700 mm
	1,700 mm
	2,500 mm

Accessories

Opener systems for garage doors



Special 306

ARTICLE	ARTICLE NO.	PRICE EACH
Emergency release for sectional doors	99 469	22.00 €

PACKAGE

- Cylinder lock with 2 keys
- Pull rope
- Mounting material
- Sales unit: 1 no.

FUNCTION / APPLICATION

- The cylinder lock will be retrofitted into the door. A pull rope connects the lock and the release of the opener system
- The opener system will be released by unlocking and pulling out the cylinder, e.g. in case of power failure
- Lock with standard profile half cylinder
- For door profiles with a thickness of max. 50 mm
- For sectional doors

TECHNICAL DETAILS / SPECIFICATIONS

Length of pull rope 3,000 mm

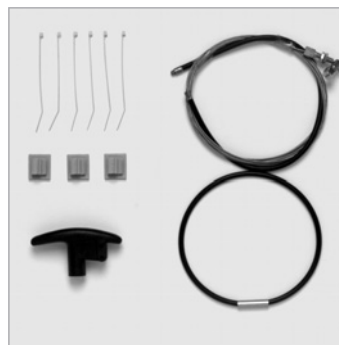

Special 311

ARTICLE	ARTICLE NO.	PRICE EACH
Emergency release for up-and-over doors	152 115	17.00 €

PACKAGE

- Emergency release
- Inside handle
- Mounting material
- Sales unit: 1 no.

FUNCTION / APPLICATION

- After unlocking the opener carriage will be mechanically unlocked by means of a bowden cable via the exterior door handle, e.g. in case of power failure
- For up-and-over doors

TECHNICAL DETAILS / SPECIFICATIONS

Length of bowden cable 3,050 mm

Accessories

Opener systems for garage doors



Special 312

ARTICLE	ARTICLE NO.	PRICE EACH
Emergency release for Novoferm sectional doors	8 053 605	35.00 €

PACKAGE

- Bowden cable
- Mounting material
- Sales unit: 1 no.

FUNCTION / APPLICATION

- After unlocking the opener carriage will be mechanically unlocked by means of a bowden cable via the exterior door handle, e.g. in case of power failure
- For Novoferm sectional doors

TECHNICAL DETAILS / SPECIFICATIONS

Length of bowden cable 4,500 mm

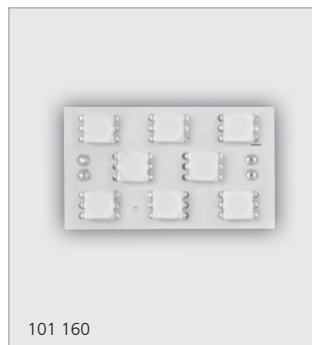

101 160



101 161

EL 200, 300

ARTICLE	ARTICLE NO.	PRICE EACH
Expansion LED lighting EL 200	101 160	8.00 €
EL 300	101 161	16.00 €

PACKAGE

- Article no. 101 160:
- 8-LED-module
 - Connecting cable
 - Sales unit: 1 no.

- Article no. 101 161:
- 2 10-LED-modules
 - 2 connecting cables
 - Sales unit: 1 no.

FUNCTION / APPLICATION

- Improvement of the opener lighting by using additional modules
- For the opener systems Comfort 260, 270, 280 (EL 200)
- For the opener systems Comfort 360, 370, 380 (EL 300)

TECHNICAL DETAILS / SPECIFICATIONS



Accu 700, Retrofit kit solar module

ARTICLE	ARTICLE NO.	PRICE EACH
Accu 700 exchange unit	87 785	241.00 €
Retrofit kit solar module	83 252	275.00 €

PACKAGE

- Article no. 87 785:
- Accumulator unit with integrated charge regulator
 - Mounting material
 - Sales unit: 1 no.

- Article no. 83 252:
- Solar module incl. connection cable, 7,500 mm
 - Mounting material
 - Sales unit: 1 no.

FUNCTION / APPLICATION

- Article no. 87 785:
- Comfortable change of a discharged accumulator without longer interruption of the power supply
 - For power supply of accu-opener systems
 - Days of usage depending on e.g. opener system, ambient temperature etc.

- Article no. 83 252:
- Charging of the accumulator unit by using the sunlight
 - Charging depends on e.g. alignment, cloudage etc.
 - Certified quality according to IEC 61646 (e.g. hailstones max. Ø 25 mm and 83 km/h)

TECHNICAL DETAILS / SPECIFICATIONS

Measurements (WxHxD)	(87 785) 280x230x80 mm (83 252) 430x400x300 mm
Weight	(87 785) 6.0 kg (83 252) 8.5 kg
Accumulator capacity	7.2 Ah
Temperature range	(87 785) -15 °C to +45 °C (83 252) -20 °C to +60 °C
Protection category	(87 785) IP 20 (83 252) IP 65

back-up 100

ARTICLE	ARTICLE NO.	PRICE EACH
Battery backup, 1.2 Ah	101 312	119.00 €

PACKAGE

- Accumulator unit with integrated charge regulator
- Sales unit: 1 no.

FUNCTION / APPLICATION

- For emergency power supply of the opener systems Comfort 360, 370, 380 (integrable in the housing)
- Service life (battery backup mode) at an ambient temperature of +20 °C
 - Max. 8 cycles within 24 hours

TECHNICAL DETAILS / SPECIFICATIONS

Measurements (WxHxD)	70x80x250 mm
Battery capacity	1.2 Ah
Range of temperature	-15 °C to +45 °C
Protection category	IP 20

Accessories

Opener systems for garage doors



back-up 200

ARTICLE	ARTICLE NO.	PRICE EACH
Battery backup, 2.2 Ah	88 951	205.00 €

PACKAGE

- Accumulator unit with integrated charge regulator
- Connecting cable, 1,000 mm
- Sales unit: 1 no.

FUNCTION / APPLICATION

- For emergency power supply of the opener systems
- Retrofittable for opener systems with connection for battery backup
- Service life (battery backup mode) at an ambient temperature of +20 °C
 - Max. 20 cycles within 2 days (blueline)

TECHNICAL DETAILS / SPECIFICATIONS

Measurements (WxHxD)	230x280x80 mm
Weight	3.3 kg
Battery capacity	2.2 Ah
Range of temperature	-15 °C to +45 °C
Protection category	IP 20



back-up 700

ARTICLE	ARTICLE NO.	PRICE EACH
Battery backup, 7.2 Ah	87 786	241.00 €

PACKAGE

- Accumulator unit with integrated charge regulator
- Connecting cable, 1,000 mm
- Sales unit: 1 no.

FUNCTION / APPLICATION

- For emergency power supply of the opener systems
- Retrofittable for opener systems with connection for battery backup
- Service life (battery backup mode) at an ambient temperature of +20°C
 - Max. 70 cycles within 7 days (blueline)
 - Max. 30 cycles within 3 days (Control x.51, x.52, x.82, vario)

TECHNICAL DETAILS / SPECIFICATIONS

Measurements (WxHxD)	230x280x80 mm
Weight	6.0 kg
Battery capacity	7.2 Ah
Range of temperature	-15 °C to +45 °C
Protection category	IP 20



back-up charge regulator

ARTICLE	ARTICLE NO.	PRICE EACH
back-up charge regulator	97 362	46.00 €

PACKAGE

- Charge regulator unit incl. 15 A fuse
- Sales unit: 1 no.

FUNCTION / APPLICATION

- For connection of lead storage batteries with a battery capacity from 1.2 Ah to 7.2 Ah and a nominal voltage of 24 V or 2x12 V connected in series
- Retrofittable for opener systems with connection for battery backup

TECHNICAL DETAILS / SPECIFICATIONS

Measurements (WxHxD)	(charge regulator) 70x70x40 mm
Nominal voltage	24 V DC
Charging rate	300 mA
Charging method	IU0U characteristic
Battery capacity max.	7.2 Ah
Protection category	IP 00 (only for dry premises)
Range of temperature	-20 °C to +60 °C



Relay retrofit kit in housing

ARTICLE	ARTICLE NO.	PRICE EACH
Relay retrofit kit in housing	85 236	77.00 €

PACKAGE

- Relay retrofit kit in housing
- System cable, 2,100 mm
- Mounting material
- Sales unit: 1 no.

FUNCTION / APPLICATION

- For travel limit information OPEN/CLOSE and external light
- For the opener systems
Comfort 260, 270, 280, 360, 370, 380
in combination with expansion board EP 141

TECHNICAL DETAILS / SPECIFICATIONS

Max. contact rating	230 V AC/60 W
Cabling	system cabling

Accessories

Opener systems for garage doors

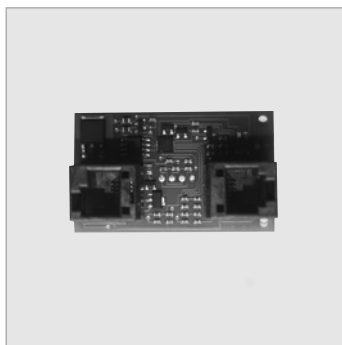

EP 141

ARTICLE	ARTICLE NO.	PRICE EACH
Expansion board command units	100 750	22.00 €

PACKAGE

- Expansion board
- Holder
- Connection cable, 200 mm
- Sales unit: 1 no.

FUNCTION / APPLICATION

- Connection for Marantec command units with system cabling
- For the opener systems Comfort 260, 270, 280, 360, 370, 380

TECHNICAL DETAILS / SPECIFICATIONS

Measurements (WxHxD) 30x50x20 mm
Cabling system cabling MS-Bus



EP 143

ARTICLE	ARTICLE NO.	PRICE EACH
Expansion board closing edge safety device	100 751	29.00 €

PACKAGE

- Expansion board
- Holder
- Connection cable, 200 mm
- Sales unit: 1 no.

FUNCTION / APPLICATION

- Connection for closing edge safety devices optosensor Opto 300, Fraba or contact bar 8.2 kΩ with conventional cabling
- For the opener systems Comfort 260, 270, 280, 360, 370, 380

TECHNICAL DETAILS / SPECIFICATIONS

Measurements (WxHxD) 30x50x20 mm
Cabling system cabling MS-Bus



EP 161

ARTICLE	ARTICLE NO.	PRICE EACH
Expansion board signal light LED 24 V DC	100 752	20.00 €

PACKAGE

- Expansion board
- Holder
- Connection cable, 250 mm
- Sales unit: 1 no.

FUNCTION / APPLICATION

- Programmable relay output and power output for the direct connection of a signal light LED 24 V DC
- Programmable input
- For the opener systems Comfort 260, 270, 280, 360, 370, 380

TECHNICAL DETAILS / SPECIFICATIONS

Measurements (WxHxD)	30x50x20 mm
Output	24 V DC/0.2 A max.
Cabling	MS-Bus



EP 163

ARTICLE	ARTICLE NO.	PRICE EACH
Expansion board relay	100 753	20.00 €

PACKAGE

- Expansion board
- Holder
- Connection cable, 250 mm
- Sales unit: 1 no.

FUNCTION / APPLICATION

- Programmable relay output
- Programmable input
- For the opener systems Comfort 260, 270, 280, 360, 370, 380

TECHNICAL DETAILS / SPECIFICATIONS

Measurements (WxHxD)	30x50x20 mm
Max. contact rating	230 V AC/60 W
Cabling	MS-Bus

Accessories

Opener systems for garage doors



EM 131

ARTICLE	ARTICLE NO.	PRICE EACH
Expansion module traffic control	88 386	150.00 €

PACKAGE

- Expansion module
- Connection cable, 200 mm
- Sales unit: 1 no.

FUNCTION / APPLICATION

- Traffic control with connections for traffic lights red/green and push buttons entrance/exit
- Radio operation only in combination with Digital 168, 179, 921, 941
- For mounting on a DIN rail
- For the opener system Comfort 257.2

TECHNICAL DETAILS / SPECIFICATIONS

Measurements (WxHxD)	85x126x46 mm
Cabling	system cabling MS-Bus

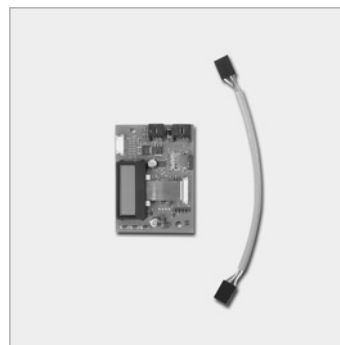

EM 151

ARTICLE	ARTICLE NO.	PRICE EACH
Expansion module clear text display language: German	91 264	114.00 €

PACKAGE

- Expansion module
- Connection cable
- Sales unit: 1 no.

FUNCTION / APPLICATION

- LC-display for integration into the control unit housing
- To support during the programming and to show the status/error messages by means of clear text display
- For the opener system Comfort 257.2

TECHNICAL DETAILS / SPECIFICATIONS

Measurements (WxHxD)	(circuit board) 82x60x11 mm (display) 38x11x10 mm
----------------------	------------------------------------------------------



EM 171

ARTICLE	ARTICLE NO.	PRICE EACH
Expansion module relay	96 658	77.00 €

PACKAGE

- Expansion module
- Connection cable, 140 mm
- Sales unit: 1 no.

FUNCTION / APPLICATION

- Two programmable relay outputs:
 - Signal light, lighting
 - Door position OPEN/CLOSE
 - Intermediate position OPEN/CLOSE
 - Wiping impulse
 - Control of door lock systems
 - Error, maintenance display
 - Evaluation of radio command
- For mounting on a DIN rail
- For the opener systems Comfort 260, 270, 280, 360, 370, 380
- For the opener system Comfort 257.2

TECHNICAL DETAILS / SPECIFICATIONS

Measurements (WxHxD) 48x126x46 mm
Cabling system cabling MS-Bus



EM 181

ARTICLE	ARTICLE NO.	PRICE EACH
Expansion module Opto 100	90 588	77.00 €

PACKAGE

- Expansion module
- Connection cable, 140 mm
- Sales unit: 1 no.

FUNCTION / APPLICATION

- Connection for photocell with system plug
- Connection for closing edge safety device optosensor Opto 100 with system cabling
- For mounting on a DIN rail
- For the opener systems Comfort 260, 270, 280, 360, 370, 380
- For the opener system Comfort 257.2

Example: New opener system
with Bus technology (replacement)
at a door with existing safety technology
with system cabling

TECHNICAL DETAILS / SPECIFICATIONS

Measurements (WxHxD) 48x126x46 mm
Cabling system cabling MS-Bus

Accessories

Opener systems for garage doors



EM 182

ARTICLE	ARTICLE NO.	PRICE EACH
Expansion module Opto 300	96 659	77.00 €

PACKAGE

- Expansion module
- Connection cable, 140 mm
- Sales unit: 1 no.

FUNCTION / APPLICATION

- Connection for photocell with unipolar 2-wire technique
- Connection for closing edge safety device optosensor Opto 300 or contact bar 8.2 kΩ with conventional cabling
- Connection for safety circuit
- For mounting on a DIN rail
- For the opener systems Comfort 260, 270, 280, 360, 370, 380
- For the opener system Comfort 257.2

TECHNICAL DETAILS / SPECIFICATIONS

Measurements (WxHxD)	48x126x46 mm
Cabling	system cabling MS-Bus



EM 183

ARTICLE	ARTICLE NO.	PRICE EACH
Expansion module Opto 300 – OPEN	88 370	77.00 €

PACKAGE

- Expansion module
- Connection cable, 140 mm
- Sales unit: 1 no.

FUNCTION / APPLICATION

- Connection for photocell with unipolar 2-wire technique
- Connection for closing edge safety device optosensor Opto 300 or contact bar 8.2 kΩ with conventional cabling in direction OPEN
- Connection for safety circuit
- For mounting on a DIN rail
- For the opener systems Comfort 260, 270, 280, 360, 370, 380
- For the opener system Comfort 257.2

TECHNICAL DETAILS / SPECIFICATIONS

Measurements (WxHxD)	48x126x46 mm
Cabling	system cabling MS-Bus



Expansion housing

ARTICLE	ARTICLE NO.	PRICE EACH
Expansion housing small	96 538	53.00 €
Expansion housing large	96 539	63.00 €

PACKAGE

- Expansion housing with pre-assembled DIN rail
- Connecting cable, 9,500 mm
- Mounting material
- Sales unit: 1 no.

FUNCTION / APPLICATION

- Article no. 96 538:
- Housing for the support of max. 2 expansion modules
- Article no. 96 539:
- Housing for the support of max. 5 expansion modules

TECHNICAL DETAILS / SPECIFICATIONS

Measurements (WxHxD)	(96 538) 240x146x77 mm (96 539) 240x300x77 mm
Protection category	IP 65
Cabling	system cabling MS-Bus

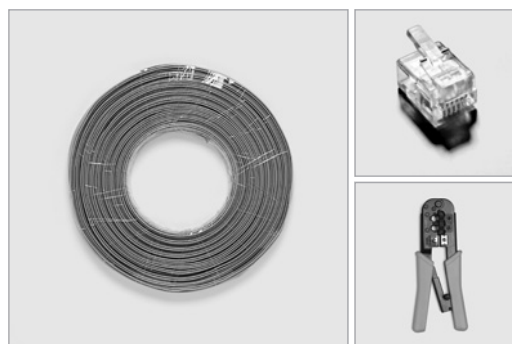

System cable, System plug, Special pliers

ARTICLE	ARTICLE NO.	PRICE EACH
System cable 4-pole	8 050 843	38.00 €
System cable 6-pole	61 202	44.00 €
System plug 4-pole MS-Bus	96 186	29.00 €
System plug 4-pole	152 921	23.00 €
System plug 6-pole	564 186	26.00 €
Special pliers	96 185	83.00 €

PACKAGE

- Article no. 8 050 843, 61 202:
- System cable, 50,000 mm
 - Sales unit: 1 roll
- Article no. 96 186, 152 921, 564 186:
- System plug
 - Sales unit: 50 no.
- Article no. 96 185:
- Special pliers
 - Sales unit: 1 no.

FUNCTION / APPLICATION

- For the Marantec system cabling

TECHNICAL DETAILS / SPECIFICATIONS

Measurements (WxHxD)	(96 185) 70x25x200 mm
----------------------	-----------------------

Accessories

Opener systems for garage doors



Special 411

ARTICLE	ARTICLE NO.	PRICE EACH
Wicket door contact	152 839	84.00 €

PACKAGE
<ul style="list-style-type: none">· Wicket door contact· Coiled cable· Mounting material· Sales unit: 1 no.

FUNCTION / APPLICATION
<ul style="list-style-type: none">· Electrical locking of the control function· If the wicket door is open, the opener system can no longer be actuated· For up-and-over doors· For the opener systems Comfort 260, 270, 280, 360, 370, 380 in combination with expansion board EP 141

TECHNICAL DETAILS / SPECIFICATIONS	
Cabling	system cabling

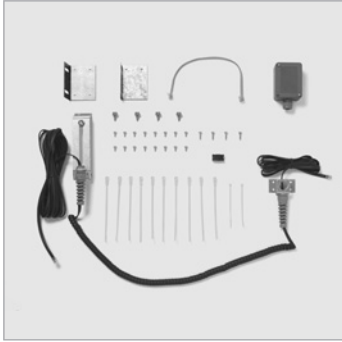

Special 412

ARTICLE	ARTICLE NO.	PRICE EACH
Junction unit for wicket door contact	8 053 964	55.00 €

PACKAGE
<ul style="list-style-type: none">· Junction box· Coiled cable· Mounting material· Sales unit: 1 no.

FUNCTION / APPLICATION
<ul style="list-style-type: none">· Electrical locking of the control function· If the wicket door is open, the opener system can no longer be actuated· For Hörmann sectional doors· Only in combination with Special 420· For the opener systems Comfort 260, 270, 280, 360, 370, 380 in combination with expansion board EP 141

TECHNICAL DETAILS / SPECIFICATIONS	
Cabling	system cabling



Special 420

ARTICLE	ARTICLE NO.	PRICE EACH
Wicket door contact		
1,800 mm	8 053 212	35.00 €
2,700 mm	8 053 214	35.00 €
3,700 mm	8 053 215	35.00 €
4,700 mm	8 053 216	35.00 €
6,400 mm	8 053 217	35.00 €

PACKAGE

- Wicket door contact
- Mounting material
- Sales unit: 1 no.

FUNCTION / APPLICATION

- Electrical locking of the control function
- If the wicket door is open, the opener system can no longer be actuated
- For sectional doors
- For the opener systems
Comfort 260, 270, 280, 360, 370, 380
in combination with Special 412 and expansion board EP 141
- For the opener system Comfort 257.2
in combination with Special 802 x.plus, 803 x.plus

TECHNICAL DETAILS / SPECIFICATIONS

Length of system cable	1,800 mm
	2,700 mm
	3,700 mm
	4,700 mm
	6,400 mm
Cabling	system cabling

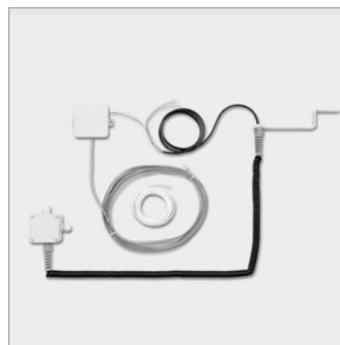

Protect-Switch 190

ARTICLE	ARTICLE NO.	PRICE EACH
Junction unit for wicket door contact on site	106 011	50.00 €

PACKAGE

- Coiled cable, 1,600 mm uncoiled with junction box
- Connecting box
- Connecting cable, 10,000 mm
- Mounting material
- Sales unit: 1 no.

FUNCTION / APPLICATION

- Electrical locking of the control function
- If the wicket door is open, the opener system can no longer be actuated
- For wicket door contact on site with conventional wiring
- For the opener systems
Comfort 260, 270, 280, 360, 370, 380, 260 accu

TECHNICAL DETAILS / SPECIFICATIONS

Measurements (WxHxD)	(junction box) 70x70x50 mm (connecting box) 85x85x37 mm
Protection category	(junction box) IP 65 (connecting box) IP 55
Cabling	conventional

Accessories

Opener systems for garage doors



Bottom door profile (1 chamber)

ARTICLE	ARTICLE NO.	PRICE EACH
Bottom door profile, per meter	152 658	10.00 €

PACKAGE

- Bottom door profile
- Sales unit: 1 no.

FUNCTION / APPLICATION

- Impact protection and energy buffer in combination with up-and-over doors and non retractable up-and-over doors
- Only in combination with the support profile (bottom door profile)

TECHNICAL DETAILS / SPECIFICATIONS

Measurements	mm
Weight (1,000 mm)	0.5 kg
Colour	black



Bottom door profile (2 chambers)

ARTICLE	ARTICLE NO.	PRICE EACH
Bottom door profile, per meter	63 823	10.00 €

PACKAGE

- Bottom door profile
- Sales unit: 1 no.

FUNCTION / APPLICATION

- For the opener systems Comfort:
Impact protection and energy buffer in combination with sectional doors and sliding gates
- For the opener systems Dynamic, STA 1:
Floor seal and support for optosensors
- Only in combination with the support profile (bottom door profile)

TECHNICAL DETAILS / SPECIFICATIONS

Measurements	mm
Weight (1,000 mm)	0.9 kg
Colour	black

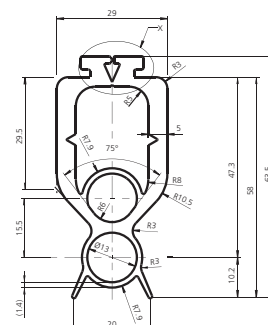



Adapter sleeve set 11/22 mm

ARTICLE	ARTICLE NO.	PRICE EACH
Adapter sleeve set 11/22 mm	79 835	14.00 €

PACKAGE

- 2 adapter sleeves 11/22 mm
- Sales unit: 1 no.

FUNCTION / APPLICATION

- For optosensors with Ø 11 mm
- To adapt to bottom door profiles with Ø 20 mm

TECHNICAL DETAILS / SPECIFICATIONS

Measurements (Ø) (interior) 11 mm
(exterior) 22 mm



Support profile (bottom door profile)

ARTICLE	ARTICLE NO.	PRICE EACH
Support profile 2,000 mm	99 590	22.00 €
10x 6,000 mm	99 591	398.00 €

PACKAGE

- Support profile
- Sales unit: 1 no. (99 590)
- Sales unit: 10 no. (99 591)

FUNCTION / APPLICATION

- Support for the bottom door profiles

TECHNICAL DETAILS / SPECIFICATIONS

Measurements mm
Weight (1,000 mm) 0.18 kg
Material aluminium

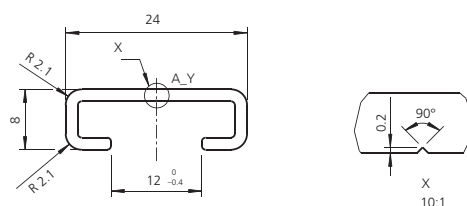

Accessories

Opener systems for garage doors



Special 712

ARTICLE	ARTICLE NO.	PRICE EACH
Closing edge safety device optosensor	103 374	163.00 €

PACKAGE

- Coiled cable 5x0.25 mm², 3,000 mm uncoiled with junction box
- Optosensor set Rx 500 mm/Tx 6,500 mm with adapter sleeves 11/15 and 11/22 mm
- EP 143 expansion board
- Connecting box
- Connecting cable, 7,500 mm
- Sales unit: 1 no.

FUNCTION / APPLICATION

- Obstacle detection in direction CLOSE
- To protect against personal injuries and material damages
- To cover squeezing and shearing points
- Connection with conventional cabling for door locking switch, wicket door contact, optosensors
- Only in combination with a bottom door profile and support profile
- For the opener systems
Comfort 260, 270, 280, 360, 370, 380

TECHNICAL DETAILS / SPECIFICATIONS

Measurements (WxHxD)	(junction box) 70x70x50 mm
Protection category	(junction box) IP 65
Cabling	(junction box) conventional (EP 143) system cabling MS-Bus



81 626



81 625

Special 802 x.plus, 803 x.plus

ARTICLE	ARTICLE NO.	PRICE EACH
Junction unit door leaf with system cabling		
Special 802 x.plus, one side	81 626	85.00 €
Special 803 x.plus, both sides	81 625	101.00 €

PACKAGE

- Coiled cable with junction box
- 2nd junction box (Special 803 x.plus only)
- Mounting material
- Sales unit: 1 no.

FUNCTION / APPLICATION

- Connection door leaf hold circuit with conventional cabling for cable slack device and door locking switch
- System plug connection for door leaf connecting cable, wicket door contact and optosensors
- For the opener system Comfort 257.2

TECHNICAL DETAILS / SPECIFICATIONS

Measurements (WxHxD)	(junction box) 170x70x40 mm
Protection category	IP 65
Cabling	conventional system cabling

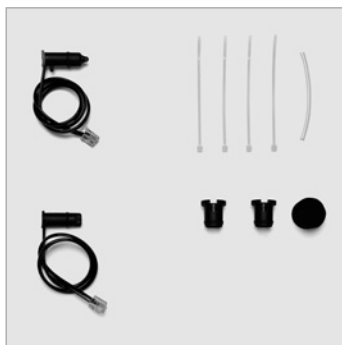

Optosensor sets with system cabling

ARTICLE	ARTICLE NO.	PRICE EACH
Optosensor set		
Rx 500 mm/Tx 500 mm-11/15 mm	85 200	29.00 €
Rx 500 mm/Tx 500 mm-11/22 mm	85 507	44.00 €

PACKAGE

- Optosensor receiver Rx, 500 mm
- Optosensor transmitter Tx, 500 mm
- 2 adapter sleeves 11/15 or 11/22 mm
- Vent hose and sealing plug
- Sales unit: 1 no.

FUNCTION / APPLICATION

- In combination with junction unit Special 803 x.plus
- For the opener system Comfort 257.2

TECHNICAL DETAILS / SPECIFICATIONS

Measurements (Ø)	(optosensor) 11 mm
Protection category	IP 65
Cabling	system cabling



Optosensor sets with system cabling

ARTICLE	ARTICLE NO.	PRICE EACH
Optosensor set		
Rx 500 mm/Tx 3,500 mm	85 201	30.00 €
Rx 500 mm/Tx 4,500 mm	85 202	31.00 €
Rx 500 mm/Tx 5,500 mm	85 203	32.00 €
Rx 500 mm/Tx 6,500 mm	85 204	33.00 €
Rx 500 mm/Tx 7,500 mm	85 205	34.00 €
Rx 500 mm/Tx 8,500 mm	85 206	35.00 €
Rx 500 mm/Tx 9,500 mm	85 207	36.00 €
Rx 500 mm/Tx 10,500 mm	85 208	38.00 €

PACKAGE

- Optosensor receiver Rx, 500 mm
- Optosensor transmitter Tx (depending on version)
- 2 adapter sleeves 11/15 mm
- Vent hose and sealing plug
- Sales unit: 1 no.

FUNCTION / APPLICATION

- In combination with junction unit Special 802 x.plus
- For the opener system Comfort 257.2

TECHNICAL DETAILS / SPECIFICATIONS

Measurements (Ø)	(optosensor) 11 mm
Protection category	IP 65
Cabling	system cabling

Accessories

Opener systems for garage doors



Door leaf connecting cable with system cabling 4-pole

ARTICLE	ARTICLE NO.	PRICE EACH
Door leaf connecting cable 4-pole		
Length Door width		
4,000 mm 3,300 mm	98 060	5.00 €
4,500 mm 3,800 mm	98 061	6.00 €
5,000 mm 4,300 mm	98 062	7.00 €
5,500 mm 4,800 mm	98 063	8.00 €
6,000 mm 5,300 mm	98 064	10.00 €
7,500 mm 6,800 mm	98 066	11.00 €
8,500 mm 7,800 mm	98 067	12.00 €
9,500 mm 8,800 mm	98 068	14.00 €

PACKAGE

- System cable 4-pole with 2 system plugs, pre-assembled
- Sales unit: 1 no.

FUNCTION / APPLICATION

- In combination with junction unit Special 803 x.plus
- For the opener system Comfort 257.2

TECHNICAL DETAILS / SPECIFICATIONS

Cabling system cabling



Door leaf connecting cable with system cabling 4-pole

ARTICLE	ARTICLE NO.	PRICE EACH
Door leaf connecting cable 4-pole, 50,000 mm	8 050 843	19.00 €

PACKAGE

- System cable 4-pole, 50,000 mm without system plugs
- Sales unit: 1 roll

FUNCTION / APPLICATION

- In combination with junction unit Special 803 x.plus
- For the opener system Comfort 257.2

TECHNICAL DETAILS / SPECIFICATIONS

Cabling system cabling

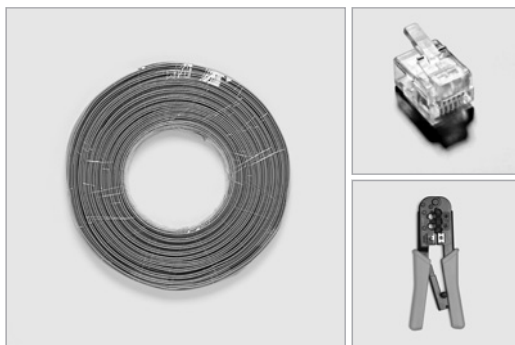

System cable, System plug, Special pliers

ARTICLE	ARTICLE NO.	PRICE EACH
System cable 4-pole	8 050 843	38.00 €
System cable 6-pole	61 202	44.00 €
System plug 4-pole MS-Bus	96 186	29.00 €
System plug 4-pole	152 921	23.00 €
System plug 6-pole	564 186	26.00 €
Special pliers	96 185	83.00 €

PACKAGE

- Article no. 8 050 843, 61 202:
 - System cable, 50,000 mm
 - Sales unit: 1 roll
- Article no. 96 186, 152 921, 564 186:
 - System plug
 - Sales unit: 50 no.
- Article no. 96 185:
 - Special pliers
 - Sales unit: 1 no.

FUNCTION / APPLICATION

- For the Marantec system cabling

TECHNICAL DETAILS / SPECIFICATIONS

Measurements (WxHxD) (96 185) 70x25x200 mm



Special 804 x.plus

ARTICLE	ARTICLE NO.	PRICE EACH
Junction unit door leaf with conventional cabling	77 416	70.00 €

PACKAGE

- Coiled cable with junction box
- Mounting material
- Sales unit: 1 no.

FUNCTION / APPLICATION

- Connection with conventional cabling for door leaf connecting cable, cable slack device, door locking switch, wicket door contact, optosensors, contact bar 8.2 kΩ
- For the opener system Comfort 257.2

TECHNICAL DETAILS / SPECIFICATIONS

Measurements (WxHxD) (junction box) 170x70x40 mm
 Protection category IP 65
 Cabling conventional

Accessories

Opener systems for garage doors



Expansion housing 2nd door side

ARTICLE	ARTICLE NO.	PRICE EACH
Expansion housing 2nd door side	77 615	18.00 €

PACKAGE

- Junction box incl. luster terminal
- Mounting material
- Sales unit: 1 no.

FUNCTION / APPLICATION

- Junction box 2nd door side for junction unit Special 804 x.plus
- For the opener system Comfort 257.2

TECHNICAL DETAILS / SPECIFICATIONS

Measurements (WxHxD)	(junction box) 170x70x40 mm
Protection category	IP 65
Cabling	conventional

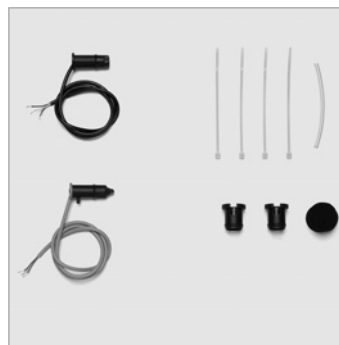

Optosensor set conventional

ARTICLE	ARTICLE NO.	PRICE EACH
Optosensor set Rx 500 mm/Tx 500 mm	85 213	29.00 €

PACKAGE

- Optosensor receiver Rx, 500 mm
- Optosensor transmitter Tx, 500 mm
- 2 adapter sleeves 11/15 mm
- Vent hose and sealing plug
- Sales unit: 1 no.

FUNCTION / APPLICATION

- In combination with junction unit Special 804 x.plus and the expansion housing 2nd door side
- For the opener system Comfort 257.2

TECHNICAL DETAILS / SPECIFICATIONS

Measurements (Ø)	(optosensor) 11 mm
Protection category	IP 65
Cabling	conventional

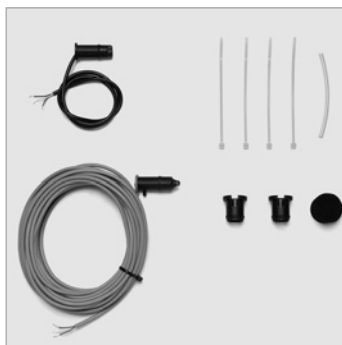

Optosensor sets conventional

ARTICLE	ARTICLE NO.	PRICE EACH
Optosensor set		
Rx 500 mm/Tx 6,500 mm	85 214	33.00 €
Rx 500 mm/Tx 10,500 mm	85 215	35.00 €

PACKAGE

- Optosensor receiver Rx, 500 mm
- Optosensor transmitter Tx (depending on version)
- 2 adapter sleeves 11/15 mm
- Vent hose and sealing plug
- Sales unit: 1 no.

FUNCTION / APPLICATION

- In combination with junction unit Special 804 x.plus
- For the opener system Comfort 257.2

TECHNICAL DETAILS / SPECIFICATIONS

Measurements (Ø)	(optosensor) 11 mm
Protection category	IP 65
Cabling	conventional



Door leaf connecting cable conventional

ARTICLE	ARTICLE NO.	PRICE EACH
Door leaf connecting cable conv.		
Length	Door width	
7,500 mm	6,800 mm	81 649
		14.00 €

PACKAGE

- Connecting cable 6x0.25 mm², 7,500 mm
- Sales unit: 1 no.

FUNCTION / APPLICATION

- In combination with junction unit Special 804 x.plus and the expansion housing 2nd door side
- For the opener system Comfort 257.2

TECHNICAL DETAILS / SPECIFICATIONS

Cabling	conventional
---------	--------------

Accessories

Opener systems for garage doors



Door leaf connecting cable conventional

ARTICLE	ARTICLE NO.	PRICE EACH
Door leaf connecting cable conv., 100,000 mm	99 276	126.00 €

PACKAGE

- Connecting cable 6x0.25 mm², 100,000 mm
- Sales unit: 1 roll

FUNCTION / APPLICATION

- In combination with junction unit Special 804 x.plus and the expansion housing 2nd door side
- For the opener system Comfort 257.2

TECHNICAL DETAILS / SPECIFICATIONS

Cabling conventional



Special 804 x.plus

ARTICLE	ARTICLE NO.	PRICE EACH
Junction unit door leaf with conventional cabling	77 416	70.00 €

PACKAGE

- Coiled cable with junction box
- Mounting material
- Sales unit: 1 no.

FUNCTION / APPLICATION

- Connection with conventional cabling for door leaf connecting cable, cable slack device, door locking switch, wicket door contact, optosensors, contact bar 8.2 kΩ
- For the opener system Comfort 257.2

TECHNICAL DETAILS / SPECIFICATIONS

Measurements (WxHxD) (junction box) 170x70x40 mm
Protection category IP 65
Cabling conventional



Contact bar 8.2 k Ω (44 mm) with sealing lip

ARTICLE	ARTICLE NO.	PRICE EACH
Contact bar profile (44 mm) with sealing lip, length upon customer request, per meter	65 294	67.00 €
Packaging of an end bar	65 285	135.00 €

PACKAGE

- Contact bar profile (65 294)
- Sales unit: 1 no.
- Packaging:
 - Pre-assembling of a contact bar 8.2 k Ω with connection cable 2,000 mm, terminating resistor and 2 stop buffers (65 285)
 - Connection box with cable bushing

FUNCTION / APPLICATION

- The contact bar profile will be assembled to a ready-for-connection end bar
- Packaging includes the accessories and the assembling to a complete contact bar
- Only in combination with the support profile (contact bar)
- In combination with junction unit Special 804 x.plus
- For the opener system Comfort 257.2

TECHNICAL DETAILS / SPECIFICATIONS

Measurements mm
Weight (1.000 mm) 0.8 kg
Colour black

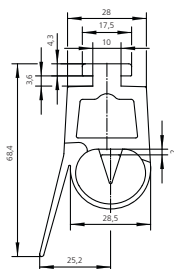

Contact bar 8.2 k Ω (68 mm) with sealing lip

ARTICLE	ARTICLE NO.	PRICE EACH
Contact bar profile (68 mm) with sealing lip, length upon customer request, per meter	65 292	89.00 €
Packaging of an end bar	65 286	135.00 €

PACKAGE

- Contact bar profile (65 292)
- Sales unit: 1 no.
- Packaging:
 - Pre-assembling of a contact bar 8.2 k Ω with connection cable 2,000 mm, terminating resistor and 2 stop buffers (65 286)
 - Connection box with cable bushing

FUNCTION / APPLICATION

- The contact bar profile will be assembled to a ready-for-connection end bar
- Packaging includes the accessories and the assembling to a complete contact bar
- Only in combination with the support profile (contact bar)
- In combination with junction unit Special 804 x.plus
- For the opener system Comfort 257.2

TECHNICAL DETAILS / SPECIFICATIONS

Measurements mm
Weight (1.000 mm) 1.0 kg
Colour black

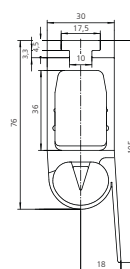

Accessories

Opener systems for garage doors



Support profile

ARTICLE	ARTICLE NO.	PRICE EACH
Support profile 2,000 mm	99 592	26.00 €
10x 4,000 mm	99 593	432.00 €

PACKAGE

- Support profile
- Sales unit: 1 no. (99 592)
- Sales unit: 10 no. (99 593)

FUNCTION / APPLICATION

- Support for the contact bars

TECHNICAL DETAILS / SPECIFICATIONS

Measurements mm
Weight (1,000 mm) 0.27 kg
Material aluminium

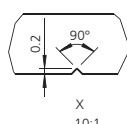
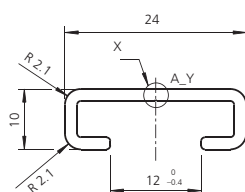

Special 639 MS-Bus

ARTICLE	ARTICLE NO.	PRICE EACH
Non-contact closing edge safety device	101 344	232.00 €

PACKAGE

- Non-contact closing edge safety device Rx 1,000 mm/Tx 1,000 mm
- EP 141 Expansion board
- Coiled cable 5x0.25 mm², 5,000 mm uncoiled with junction box
- 2nd junction box
- Door leaf connection cable conventional, 10,000 mm
- Mounting material
- Sales unit: 1 no.

FUNCTION / APPLICATION

- Optical safety device for protection against personal injuries and material damage
- If the light beam will be interrupted in direction CLOSE the opener system stops and reverses
- Non-contact detection of the closing edge
- For the opener systems Comfort 260, 270, 280, 360, 370, 380

TECHNICAL DETAILS / SPECIFICATIONS

Measurements (WxHxD) (junction box) 70x70x50 mm
Nominal voltage 24 V DC
Power consumption 60 mW
Protection category (junction box) IP 54
(Rx, Tx) IP 54
Range of temperature (Rx, Tx) -10 °C to +55 °C
Cabling (Rx, Tx) conventional
(EP 141) system cabling MS-Bus
Range 6 m

Radio accessories bi-linked

Hand transmitter



Digital 564, 663

ARTICLE	ARTICLE NO.	PRICE EACH
Mini hand transmitter 4-channel Digital 564, uni-directional, 868 MHz	101 106	49.00 €
Digital 564, uni-directional, 433 MHz	101 105	49.00 €
Mini hand transmitter 3-channel Digital 663, bi-directional, 868 MHz	101 117	58.00 €
Digital 663, bi-directional, 433 MHz	101 116	58.00 €

PACKAGE

- Hand transmitter incl. battery
- Wall support (white)
- Sun visor clip
- Sales unit: 1 no.

FUNCTION / APPLICATION

- Digital 564:
- 4 function buttons for free configuration
 - Electronic button lock programmable
 - Signalization via red LED
 - For all Marantec opener systems and other's opener systems (in combination with the respective bi-linked receiver)

- Digital 663:
- 3 function buttons for free configuration
 - 1 button for requesting the door position
 - Automatic feedback of the travel direction after button press
 - Electronic button lock programmable
 - Multicoloured signalization via LED
 - For all Marantec opener systems and other's opener systems (in combination with the respective bi-linked receiver)

TECHNICAL DETAILS / SPECIFICATIONS

Measurements (WxHxD)	39x92x12 mm
Weight	0.04 kg
Battery type	CR 2032, 3 V
Range of temperature	-20 °C to +60 °C
Radio technology	bi-linked
Way of communication	(Digital 564) uni-directional (Digital 663) bi-directional

Digital 572

ARTICLE	ARTICLE NO.	PRICE EACH
Micro hand transmitter 2-channel uni-directional, 868 MHz	101 115	45.00 €
uni-directional, 433 MHz	101 114	45.00 €

PACKAGE

- Hand transmitter incl. battery
- Sales unit: 1 no.

FUNCTION / APPLICATION

- 2 function buttons for free configuration
- Electronic button lock programmable
- Signalization via red LED
- For all Marantec opener systems and other's opener systems (in combination with the respective bi-linked receiver)

TECHNICAL DETAILS / SPECIFICATIONS

Measurements (WxHxD)	39x60x12 mm
Weight	0.03 kg
Battery type	CR 2032, 3 V
Range of temperature	-20 °C to +60 °C
Radio technology	bi-linked
Way of communication	uni-directional

Radio accessories bi-linked

Hand transmitter



Digital 633

ARTICLE	ARTICLE NO.	PRICE EACH
Design hand transmitter 3-channel bi-directional, 868 MHz	101 127	58.00 €
bi-directional, 433 MHz	101 125	58.00 €

PACKAGE

- Hand transmitter incl. battery
- Wall support (magnetic)
- Sales unit: 1 no.

FUNCTION / APPLICATION

- 3 function buttons for free configuration
- 1 button for requesting the door position
- Automatic feedback of the travel direction after button press
- Electronic button lock programmable
- Multicoloured signalization via LED
- For all Marantec opener systems and other's opener systems (in combination with the respective bi-linked receiver)

TECHNICAL DETAILS / SPECIFICATIONS

Measurements (WxHxD)	48x48x13 mm
Weight	0.03 kg
Battery type	CR 2032, 3 V
Range of temperature	-20 °C to +60 °C
Radio technology	bi-linked
Way of communication	bi-directional



Digital 506

ARTICLE	ARTICLE NO.	PRICE EACH
Maxi hand transmitter 10-channel uni-directional, 868 MHz	114 484	59.00 €
uni-directional, 433 MHz	114 485	59.00 €

PACKAGE

- Hand transmitter incl. battery
- Wall support (black)
- Sales unit: 1 no.

FUNCTION / APPLICATION

- 10 function buttons for free configuration
- Electronic button lock programmable
- Signalization via red LED
- For all Marantec opener systems and other's opener systems (in combination with the respective bi-linked receiver)

TECHNICAL DETAILS / SPECIFICATIONS

Measurements (WxHxD)	39x112x17 mm
Weight	0.04 kg
Battery type	CR 2032, 3 V
Range of temperature	-20 °C to +60 °C
Radio technology	bi-linked
Way of communication	uni-directional

Radio accessories bi-linked

Wall transmitter

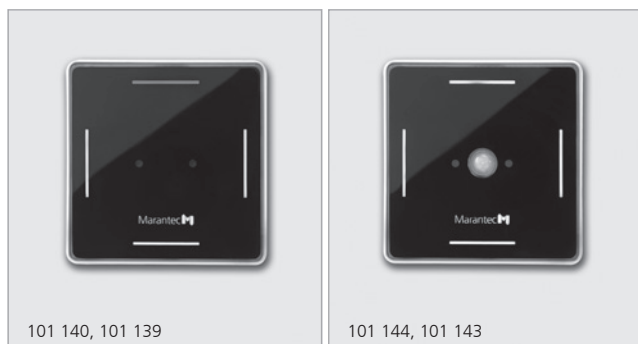

Digital 644, 645

ARTICLE	ARTICLE NO.	PRICE EACH
Remote interior push button 2-channel Digital 644, bi-directional, 868 MHz	101 140	49.00 €
Digital 644, bi-directional, 433 MHz	101 139	49.00 €
Remote interior push button 2-channel Digital 645, bi-directional, 868 MHz	101 144	59.00 €
Digital 645, bi-directional, 433 MHz	101 143	59.00 €

PACKAGE

- Remote interior push button incl. 2 batteries
- Mounting material
- Sales unit: 1 no.

FUNCTION / APPLICATION

- 2 function buttons for free configuration
- 1 button for switching the holiday mode (hand transmitter rejection)
- Multicoloured signalization via LED
- Connection with conventional cabling for external push buttons for direct switching of each function button
- For all Marantec opener systems and other's opener systems (in combination with the respective bi-linked receiver)

Digital 644 additionally:

- 1 button for requesting/monitoring the door position
- Automatic feedback of the travel direction after button press

Digital 645 additionally:

- 1 button for switching the opener lighting (ON/OFF)
- Integrated motion detector for switching the opener lighting (lighting duration), detects moving heat sources until 2.5 m distance and in a max. grid of 4x4 m

TECHNICAL DETAILS / SPECIFICATIONS

Measurements (WxHxD)

Battery type

Protection category

Range of temperature

Sensor type

Radio technology

Way of communication

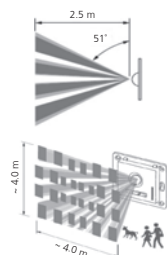

82x83x26 mm

CR 2032, 3 V

IP 20

-20 °C to +60 °C

(Digital 645) PIR

bi-linked

bi-directional

Digital 525, 526

ARTICLE	ARTICLE NO.	PRICE EACH
Radio code keypad 4-channel Digital 525, uni-directional, 868 MHz	101 149	72.00 €
Digital 525, uni-directional, 433 MHz	101 148	72.00 €
Radio code keypad 4-channel Digital 526, uni-directional, 868 MHz	101 163	87.00 €
Digital 526, uni-directional, 433 MHz	101 162	87.00 €

PACKAGE

- Radio code keypad incl. 2 batteries
- Mounting material
- Sales unit: 1 no.

FUNCTION / APPLICATION

- Operation by entering a 4-digit code
- 3 free programmable user codes for free configuration of functions
- 1 free programmable user code, 3 times usable, for the temporary use of an already configured function
- 1 changeable master code for managing the device
- 1 function button for free configuration
- Signalization via red LEDs
- For all Marantec opener systems and other's opener systems (in combination with the respective bi-linked receiver)

Digital 526 additionally:

- Sliding cover protects the keypad against dirt

TECHNICAL DETAILS / SPECIFICATIONS

Measurements (WxHxD)

Battery type

Protection category

Range of temperature

Radio technology

Way of communication

(Digital 525) 80x102x35 mm

(Digital 526 closed) 81x118x35 mm

(Digital 526 opened) 81x189x35 mm

AAA, 1.5 V

IP 54

-20 °C to +60 °C

bi-linked

uni-directional

Radio accessories bi-linked

Wall transmitter / Module receivers

Marantec
Antriebstechnik



Digital 528

ARTICLE	ARTICLE NO.	PRICE EACH
Radio fingerprint reader 2-channel uni-directional, 868 MHz	101 168	160.00 €
uni-directional, 433 MHz	101 167	160.00 €

PACKAGE

- Radio fingerprint reader incl. 4 batteries
- Mounting material
- Sales unit: 1 no.

FUNCTION / APPLICATION

- Operation by pulling a finger over the sensor
- 20 user fingers can be stored to perform a function
- 2 channels for free configuration of functions
- 2 master fingers must be stored for managing the device
- Multicoloured signalization via LEDs
- Sliding cover protects the keypad against dirt
- For all Marantec opener systems and other's opener systems (in combination with the respective bi-linked receiver)

TECHNICAL DETAILS / SPECIFICATIONS

Measurements (WxHxD)	(closed) 81x118x35 mm (opened) 81x195x35 mm
Battery type	AAA, 1.5 V
Protection category	IP 54
Range of temperature	-20 °C to +60 °C
Sensor type	line scan sensor
Radio technology	bi-linked
Way of communication	uni-directional



101 180, 101 179



101 185

Digital 921, 941

ARTICLE	ARTICLE NO.	PRICE EACH
Module receiver		
Digital 921, bi-directional, 868 MHz	101 180	55.00 €
Digital 921, bi-directional, 433 MHz	101 179	55.00 €
Module receiver with magnet stand aerial		
Digital 941, bi-directional, 868 MHz	101 185	65.00 €
Digital 941, bi-directional, 433 MHz	101 184	65.00 €

PACKAGE

- Digital 921:
- Module receiver
 - Sales unit: 1 no.
- Digital 941:
- Module receiver with connection for the magnet stand aerial
 - Magnet stand aerial with connecting cable, 5,000 mm
 - Sales unit: 1 no.

FUNCTION / APPLICATION

- Receiving and transmitting of radio signals to the control unit
 - For the opener systems for garage doors
Comfort 260, 270, 280, 360, 370, 380, 260 accu (from control box revision R10)
 - For all opener systems for swing and sliding gates with the control units Control x.52, x.82
- Digital 941 additionally:
- Improvement of the range by choosing an ideal position for the magnet stand aerial

TECHNICAL DETAILS / SPECIFICATIONS

Measurements (ØxH)	(magnet stand aerial) 27x95 mm
Nominal voltage	5 V DC
Power consumption	approx. 2.0 mA
Protection category	(module receiver) IP 00 (magnet stand aerial) IP 65
Range of temperature	-20 °C to +60 °C
Radio technology	bi-linked
Way of communication	bi-directional
Memory capacity	200

Garage door openers

Radio accessories bi-linked

Radio accessories Multi-Bit

General accessories

Radio accessories bi-linked

Universal receivers

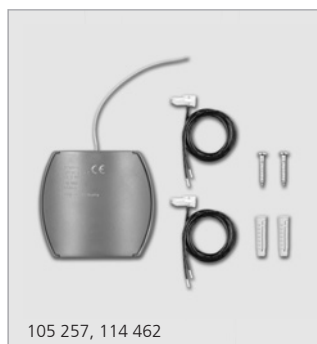

Digital 992

ARTICLE	ARTICLE NO.	PRICE EACH
Universal receiver 2-channel, IP 20 uni-directional, 868 MHz	105 257	49.00 €
uni-directional, 433 MHz	114 462	49.00 €
Universal receiver 2-channel, IP 65 uni-directional, 868 MHz	116 881	77.00 €
uni-directional, 433 MHz	116 913	77.00 €

PACKAGE

- Universal receiver
- 2 connection cables for external switches, 400 mm
- Mounting material
- Sales unit: 1 no.

FUNCTION / APPLICATION

- 2 radio channels for free configuration
- IMPULSE or ON/OFF function separately selectable for each channel
- Connection for external push buttons for direct switching of each relay
- For all Marantec opener systems and other's opener systems

TECHNICAL DETAILS / SPECIFICATIONS

Measurements (WxHxD)	(IP 20) 70x64x35 mm (IP 65) 70x113x35 mm
Nominal voltage	12 to 24 V AC/DC
Power consumption	approx. 50 mA
Protection category	(105 257, 114 462) IP 20 (116 881, 116 913) IP 65
Range of temperature	-20 °C to +60 °C
Radio technology	bi-linked
Way of communication	uni-directional
Memory capacity	100 each channel
Outputs	2 potential-free relay contacts
Max. contact rating	24 V AC/1 A/24 VA 30 V DC/1 A/30 W
Cabling	conventional



Frequency detector

ARTICLE	ARTICLE NO.	PRICE EACH
Frequency detector	61 828	74.00 €

PACKAGE

- Frequency detector incl. battery
- Sales unit: 1 no.

FUNCTION / APPLICATION

- Identification of parasitic frequencies in the ranges of 868 MHz and 433 MHz

TECHNICAL DETAILS / SPECIFICATIONS

Measurements (WxHxD)	80x110x23 mm
Battery type	9 V block battery

Radio accessories Multi-Bit

Hand transmitter



Digital 302, 304

ARTICLE	ARTICLE NO.	PRICE EACH
Mini hand transmitter 2-channel		
Digital 302, uni-directional, 868 MHz	64 173	41.00 €
Digital 302, uni-directional, 433 MHz	64 176	41.00 €
Mini hand transmitter 4-channel		
Digital 304, uni-directional, 868 MHz	64 037	42.00 €
Digital 304, uni-directional, 433 MHz	64 133	42.00 €

PACKAGE

- Transmitter incl. battery
- Wall support (anthracite)
- Sun visor clip
- Coding plug
- Sales unit: 1 no.

FUNCTION / APPLICATION

- Digital 302:
- 2 function buttons for free configuration
 - Signalization via red LED
 - For all Marantec opener systems and other's opener systems (in combination with the respective Multi-Bit receiver)

- Digital 304:
- 2 function buttons for free configuration
 - Signalization via red LED
 - For all Marantec opener systems and other's opener systems (in combination with the respective Multi-Bit receiver)

TECHNICAL DETAILS / SPECIFICATIONS

Measurements (WxHxD)	38x72x12 mm
Weight	0.02 kg
Battery type	CR 2032, 3 V
Range of temperature	-20 °C to +60 °C
Radio technology	Multi-Bit
Way of communication	uni-directional

Wall support

ARTICLE	ARTICLE NO.	PRICE EACH
Wall support	65 310	18.00 €

PACKAGE

- Wall support
- Sales unit: 5 no.

FUNCTION / APPLICATION

- Wall support for mini hand transmitters Digital 302, 304

TECHNICAL DETAILS / SPECIFICATIONS

Measurements (WxHxD)	48x65x17 mm
Colour	anthracite

Radio accessories Multi-Bit

Hand transmitter



Digital 313, 321

ARTICLE	ARTICLE NO.	PRICE EACH
Micro hand transmitter 3-channel		
Digital 313, uni-directional, 868 MHz	64 180	44.00 €
Digital 313, uni-directional, 433 MHz	64 183	44.00 €
Micro hand transmitter 1-channel		
Digital 321, uni-directional, 868 MHz	76 852	43.00 €
Digital 321, uni-directional, 433 MHz	76 955	43.00 €

PACKAGE

- Transmitter incl. battery
- Button cover
- Key ring (Digital 313 only)
- Coding plug
- Sales unit: 1 no.

FUNCTION / APPLICATION

- Digital 313:
- 3 function buttons for free configuration
 - Signalization via red LED
 - For all Marantec opener systems and other's opener systems (in combination with the respective Multi-Bit receiver)

- Digital 321:
- 1 function button for free configuration
 - Signalization via red LED
 - For all Marantec opener systems and other's opener systems (in combination with the respective Multi-Bit receiver)

TECHNICAL DETAILS / SPECIFICATIONS

Measurements (WxHxD)	34x50x12 mm
Weight	0.02 kg
Battery type	CR 2032, 3 V
Range of temperature	-20 °C to +60 °C
Radio technology	Multi-Bit
Way of communication	uni-directional

Digital 323

ARTICLE	ARTICLE NO.	PRICE EACH
Transmitter for the cigarette lighter 3-channel		
uni-directional, 868 MHz	80 474	65.00 €
uni-directional, 433 MHz	81 788	65.00 €

PACKAGE

- Transmitter
- Coding cable
- Sales unit: 1 no.

FUNCTION / APPLICATION

- 3 function buttons for free configuration
- Signalization via red LED
- For all Marantec opener systems and other's opener systems (in combination with the respective Multi-Bit receiver)
- For the connection at the cigarette lighter or 12 V connection in a vehicle

TECHNICAL DETAILS / SPECIFICATIONS

Measurements (ØxD)	37x64 mm
Nominal voltage	12 V DC
Range of temperature	-20 °C to +60 °C
Radio technology	Multi-Bit
Way of communication	uni-directional

Radio accessories Multi-Bit

Hand transmitter



Digital 306

ARTICLE	ARTICLE NO.	PRICE EACH
Maxi hand transmitter 10-channel uni-directional, 868 MHz	82 499	65.00 €
uni-directional, 433 MHz	82 501	65.00 €

PACKAGE

- Hand transmitter incl. battery
- Wall support (anthracite)
- Coding plug
- Sales unit: 1 no.

FUNCTION / APPLICATION

- 10 function buttons for free configuration
- Signalization via red LED
- For all Marantec opener systems and other's opener systems (in combination with the respective Multi-Bit receiver)

TECHNICAL DETAILS / SPECIFICATIONS

Measurements (WxHxD)	38x110x14 mm
Weight	0.04 kg
Battery type	CR 2032, 3 V
Temperature range	-20 °C to +60 °C
Radio technology	Multi-Bit
Way of communication	uni-directional



88 990, 88 734



89 214, 89 000

Digital 317, 318

ARTICLE	ARTICLE NO.	PRICE EACH
Multi-channel transmitter 999-channel Digital 317, uni-directional, 868 MHz	88 990	99.00 €
Digital 317, uni-directional, 433 MHz	88 734	99.00 €
Multi-channel transmitter 999-channel Digital 318, uni-directional, 868 MHz	89 214	99.00 €
Digital 318, uni-directional, 433 MHz	89 000	99.00 €

PACKAGE

- Transmitter incl. battery
- Coding cable
- Sales unit: 1 no.

FUNCTION / APPLICATION

- Digital 317:
- Operation by entering a channel number and the Enter button (IMPULSE)
 - 999 functions for free configuration
 - Signalization via LC-display
 - For all Marantec opener systems and other's opener systems (in combination with the respective Multi-Bit receiver)
- Digital 318:
- Operation by entering a channel number and a direction button (OPEN/STOP/CLOSE)
 - 999 functions for free configuration
 - Signalization via LC-display
 - For all Marantec opener systems and other's opener systems (in combination with the respective Multi-Bit receiver)

TECHNICAL DETAILS / SPECIFICATIONS

Measurements (WxHxD)	60x150x22 mm
Weight	0.11 kg
Battery type	CR 2032, 3 V
Range of temperature	0 °C to +50 °C
Radio technology	Multi-Bit
Way of communication	uni-directional

Radio accessories Multi-Bit

Hand transmitter / Wall transmitter



Wall support

ARTICLE	ARTICLE NO.	PRICE EACH
Wall support	72 819	10.00 €

PACKAGE

- Wall support
- Sales unit: 1 no.

FUNCTION / APPLICATION

- Wall support for multi-channel transmitters Digital 317, 318

TECHNICAL DETAILS / SPECIFICATIONS

Measurements (WxHxD) 70x160x30 mm



Command 131

ARTICLE	ARTICLE NO.	PRICE EACH
Radio interior push button 2-channel uni-directional, 868 MHz	64 812	47.00 €
uni-directional, 433 MHz	65 694	47.00 €

PACKAGE

- Radio interior push button incl. 2 batteries
- Coding cable
- Mounting material
- Sales unit: 1 no.

FUNCTION / APPLICATION

- 2 function buttons for free configuration
- Connection with conventional cabling for external push buttons for direct switching of each function button
- For all Marantec opener systems and other's opener systems (in combination with the respective Multi-Bit receiver)

TECHNICAL DETAILS / SPECIFICATIONS

Measurements (WxHxD) 80x80x27 mm
 Battery type CR 2032, 3 V
 Protection category IP 00 (only for dry premises)
 Radio technology Multi-Bit
 Way of communication uni-directional

Radio accessories Multi-Bit

Wall transmitter



Command 231

ARTICLE	ARTICLE NO.	PRICE EACH
Radio code keypad 4-channel uni-directional, 868 MHz	69 533	91.00 €
uni-directional, 433 MHz	69 534	91.00 €
Key lock to secure the radio code keypad	97 908	6.00 €

PACKAGE

- Command 231:
- Radio code keypad incl. 2 batteries
 - Mounting material
 - Sales unit: 1 no.

- Article no. 97 908:
- Key lock with 2 keys
 - Sales unit: 1 no.

FUNCTION / APPLICATION

- Operation by entering a 4-digit code
- 3 free programmable user codes for free configuration of functions
- 1 free programmable user code, 3 times usable, for the temporary use of an already configured function
- 1 function button for free configuration
- Signalization via red LED
- Hinged cover protects the keypad against dirt
- For all Marantec opener systems and other's opener systems (in combination with the respective Multi-Bit receiver)

TECHNICAL DETAILS / SPECIFICATIONS

Measurements (WxHxD)	70x110x48 mm
Battery type	CR 2032, 3 V
Protection category	IP 54
Radio technology	Multi-Bit
Way of communication	uni-directional



Command 222

ARTICLE	ARTICLE NO.	PRICE EACH
Radio code keypad 4-channel uni-directional, 868 MHz	72 873	143.00 €
uni-directional, 433 MHz	75 167	143.00 €

PACKAGE

- Radio code keypad incl. battery
- Coding cable
- Mounting material
- Sales unit: 1 no.

FUNCTION / APPLICATION

- Operation by entering a 4- to 8-digit code
- 3 free programmable user codes for free configuration of functions
- 1 changeable master code for managing the device
- 1 function button for free configuration
- Signalization via LED
- Metal buttons and safety screw securing against vandalism
- For all Marantec opener systems and other's opener systems (in combination with the respective Multi-Bit receiver)

TECHNICAL DETAILS / SPECIFICATIONS

Measurements (WxHxD)	60x142x30 mm
Nominal voltage	9 V block battery
Protection category	IP 65
Radio technology	Multi-Bit
Way of communication	uni-directional

Radio accessories Multi-Bit

Module aerials / Universal receivers

Marantec
Antriebstechnik



101 966, 102 049



102 053, 102 051

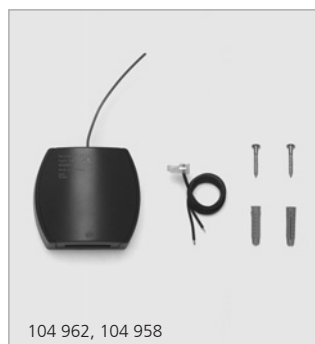

104 962, 104 958

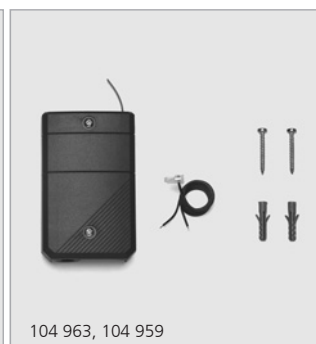

104 963, 104 959

Digital 168, 179

ARTICLE	ARTICLE NO.	PRICE EACH
Module aerial		
Digital 168, uni-directional, 868 MHz	101 966	56.00 €
Digital 168, uni-directional, 433 MHz	102 049	56.00 €
Module aerial with magnet stand aerial		
Digital 179, uni-directional, 868 MHz	102 053	67.00 €
Digital 179, uni-directional, 433 MHz	102 051	67.00 €

PACKAGE

Digital 168:

- Module aerial
- Sales unit: 1 no.

Digital 179:

- Module receiver with connection for the magnet stand aerial
- Magnet stand aerial with connecting cable, 5,000 mm
- Sales unit: 1 no.

FUNCTION / APPLICATION

- Receiving and transmitting of radio signals to the control unit
- For the opener systems for garage doors
Comfort 260, 270, 280, 360, 370, 380, 260 accu, 257.2

Digital 179 additionally:

- Improvement of the range by choosing an ideal position for the magnet stand aerial

TECHNICAL DETAILS / SPECIFICATIONS

Measurements (ØxH)	(magnet stand aerial) 27x95 mm
Nominal voltage	5 V DC
Power consumption	approx. 2.0 mA
Protection category	(module aerial) IP 00 (magnet stand aerial) IP 65
Range of temperature	-20 °C to +60 °C
Radio technology	Multi-Bit
Way of communication	uni-directional

Digital 339.2, 340.2

ARTICLE	ARTICLE NO.	PRICE EACH
Universal receiver 1-channel, IP 20		
Digital 339.2, uni-directional, 868 MHz	104 962	48.00 €
Digital 339.2, uni-directional, 433 MHz	104 958	48.00 €
Universal receiver 1-channel, IP 65		
Digital 340.2, uni-directional, 868 MHz	104 963	79.00 €
Digital 340.2, uni-directional, 433 MHz	104 959	79.00 €

PACKAGE

- Universal receiver
- Connection cable for external switches, 400 mm
- Mounting material
- Sales unit: 1 no.

FUNCTION / APPLICATION

- 1 radio channel for free configuration
- IMPULSE, continuous IMPULSE or ON/OFF function selectable
- Connection for external push buttons for direct switching of the relay
- For all Marantec opener systems and other's opener systems

TECHNICAL DETAILS / SPECIFICATIONS

Measurements (WxHxD)	(IP 20) 70x64x35 mm (IP 65) 70x113x35 mm
Nominal voltage	12 to 24 V AC/DC
Power consumption	approx. 50 mA
Protection category	(Digital 339.2) IP 20 (Digital 340.2) IP 65
Range of temperature	-20 °C to +60 °C
Radio technology	Multi-Bit
Way of communication	uni-directional
Output	1 potential-free relay contact
Max. contact rating	24 V AC/1 A/24 VA 30 V DC/1 A/30 W
Cabling	conventional

Garage door openers

Radio accessories bi-linked

Radio accessories Multi-Bit

General accessories

Radio accessories Multi-Bit

Universal receivers

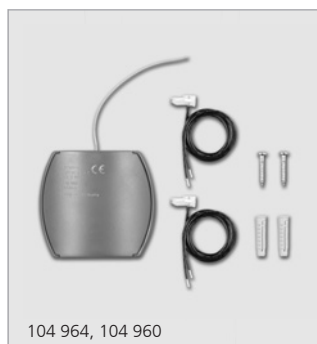

104 964, 104 960



104 966, 104 961



76 767, 76 768



76 769, 76 770

Digital 343.2, 344.2

ARTICLE	ARTICLE NO.	PRICE EACH
Universal receiver 2-channel, IP 20		
Digital 343.2, uni-directional, 868 MHz	104 964	56.00 €
Digital 343.2, uni-directional, 433 MHz	104 960	56.00 €
Universal receiver 2-channel, IP 65		
Digital 344.2, uni-directional, 868 MHz	104 966	88.00 €
Digital 344.2, uni-directional, 433 MHz	104 961	88.00 €

PACKAGE

- Universal receiver
- 2 connection cables for external switches, 400 mm
- Mounting material
- Sales unit: 1 no.

FUNCTION / APPLICATION

- 2 radio channels for free configuration
- IMPULSE, continuous IMPULSE or ON/OFF function separately selectable for each channel
- Connection for external push buttons for direct switching of each relay
- For all Marantec opener systems and other's opener systems

TECHNICAL DETAILS / SPECIFICATIONS

Measurements (WxHxD)	(IP 20) 70x64x35 mm (IP 65) 70x113x35 mm
Nominal voltage	12 to 24 V AC/DC
Power consumption	approx. 50 mA
Protection category	(Digital 343.2) IP 20 (Digital 344.2) IP 65
Range of temperature	-20 °C to +60 °C
Radio technology	Multi-Bit
Way of communication	uni-directional
Outputs	2 potential-free relay contacts
Max. contact rating	24 V AC/1 A/24 VA 30 V DC/1 A/30 W
Cabling	conventional

Digital 351, 352

ARTICLE	ARTICLE NO.	PRICE EACH
Universal receiver 3-channel, IP 32		
Digital 351, uni-directional, 868 MHz	76 767	143.00 €
Digital 351, uni-directional, 433 MHz	76 768	143.00 €
Universal receiver 3-channel, IP 65		
Digital 352, uni-directional, 868 MHz	76 769	181.00 €
Digital 352, uni-directional, 433 MHz	76 770	181.00 €

PACKAGE

- Universal receiver
- Module aerial
- Mounting material
- Sales unit: 1 no.

FUNCTION / APPLICATION

- 3 radio channels for free configuration
- IMPULSE, ON/OFF or timer function (1/3/8/45 min) separately selectable for each channel
- Awning function with radio channel 1 and 2 selectable
- Control of additional electric devices, e.g. light
- Connection for external push buttons for direct switching of each relay
- For all Marantec opener systems and other's opener systems

TECHNICAL DETAILS / SPECIFICATIONS

Measurements (WxHxD)	(IP 32) 150x113x50 mm (IP 65) 150x113x50 mm
Nominal voltage	230 V AC
Power consumption	12 to 24 V AC/DC approx. 20 mA approx. 400 mA
Protection category	(Digital 351) IP 32 (Digital 352) IP 65
Range of temperature	-20 °C to +60 °C
Radio technology	Multi-Bit
Way of communication	uni-directional
Outputs	3 potential-free relay contacts
Cabling	conventional



Digital 361

ARTICLE	ARTICLE NO.	PRICE EACH
Recess-mounted receiver 1-channel uni-directional, 868 MHz	65 654	51.00 €
Recess-mounted receiver 1-channel uni-directional, 433 MHz	65 655	51.00 €

PACKAGE

- Recess-mounted receiver
- Sales unit: 1 no.

FUNCTION / APPLICATION

- 1 radio channel for free configuration
- ON/OFF function
- Control of electric devices inside the house, e.g. lamps, fans etc.

TECHNICAL DETAILS / SPECIFICATIONS

Measurements (WxHxD)	45x45x25 mm
Nominal voltage	230 V AC
Power consumption	approx. 30 mA
Protection category	IP 40
Range of temperature	-20 °C to +60 °C
Radio technology	Multi-Bit
Way of communication	uni-directional
Cabling	conventional



Digital 371

ARTICLE	ARTICLE NO.	PRICE EACH
Impulse socket receiver 1-channel uni-directional, 868 MHz	65 652	67.00 €
Impulse socket receiver 1-channel uni-directional, 433 MHz (Plug systems also available for the countries GB, CH, B/F)	65 653	67.00 €

PACKAGE

- Socket receiver
- Connection cable, 10,000 mm
- Sales unit: 1 no.

FUNCTION / APPLICATION

- 1 radio channel for free configuration
- IMPULSE function
- Connection for external push buttons for direct switching of the relay
- For all Marantec opener systems and other's opener systems

TECHNICAL DETAILS / SPECIFICATIONS

Measurements (WxHxD)	50x120x75 mm
Nominal voltage	230 V AC
Power consumption	approx. 30 mA
Protection category	IP 20
Range of temperature	-10 °C to +40 °C
Radio technology	Multi-Bit
Way of communication	uni-directional
Cabling	conventional

Radio accessories Multi-Bit

Universal receivers



Digital 343.2

ARTICLE	ARTICLE NO.	PRICE EACH
Universal receiver 2-channel incl. system cable uni-directional, 868 MHz	104 965	59.00 €

PACKAGE

- Universal receiver with system cable, 500 mm
- 2 connection cables for external switches, 400 mm
- Sales unit: 1 no.

FUNCTION / APPLICATION

- 2 radio channels for free configuration
- IMPULSE, continuous IMPULSE or ON/OFF function separately selectable for each channel
- Connection for external push buttons for direct switching of each relay
- For all Marantec opener systems with system cabling for radio

TECHNICAL DETAILS / SPECIFICATIONS

Measurements (WxHxD)	70x64x35 mm
Nominal voltage	12 to 24 V AC/DC
Power consumption	approx. 50 mA
Protection category	IP 20
Range of temperature	-20 °C to +60 °C
Radio technology	Multi-Bit
Way of communication	uni-directional
Outputs	2 potential-free relay contacts
Max. contact rating	24 V AC/1 A/24 VA 30 V DC/1 A/30 W
Cabling	system cabling conventional

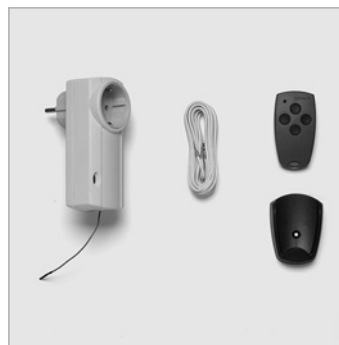

Retrofit kit Digital 371

ARTICLE	ARTICLE NO.	PRICE EACH
Retrofit kit uni-directional, 868 MHz	78 073	100.00 €

PACKAGE

- Digital 371 impulse socket receiver 1-channel, 868 MHz Multi-Bit
- Connection cable 10.000 mm
- Digital 304 mini hand transmitter 4-channel, 868 MHz Multi-Bit with battery
- Wall support (anthracite)
- Visor clip
- Coding plug
- Sales unit: 1 no.

FUNCTION / APPLICATION

- 1 radio channel for free configuration
- IMPULSE function
- Connection for external push buttons for direct switching of the relay
- For easy retrofitting of other's opener systems to Marantec hand transmitters and/or updating the radio frequencies
- For all Marantec opener systems and other's opener systems

TECHNICAL DETAILS / SPECIFICATIONS



Retrofit kit Digital 343.2

ARTICLE	ARTICLE NO.	PRICE EACH
Retrofit kit uni-directional, 868 MHz	78 074	95.00 €

PACKAGE

- Digital 343.2 universal receiver 2-channel, 8668 MHz Multi-Bit with system cable, 500 mm
- 2 connection cables for external switches, 400 mm
- Digital 304 mini hand transmitter 4-channel, 868 MHz Multi-Bit incl. battery
- Wall support (anthracite)
- Visor clip
- Coding plug
- Sales unit: 1 no.

FUNCTION / APPLICATION

- 2 radio channels for free configuration
- IMPULSE, continuous IMPULSE or ON/OFF function separately selectable for each channel
- Connection for external push buttons for direct switching of each relay
- For all Marantec opener systems and other's opener systems

TECHNICAL DETAILS / SPECIFICATIONS



Command 132

ARTICLE	ARTICLE NO.	PRICE EACH
Recess-mounted transmitter 4-channel uni-directional, 868 MHz	70 028	43.00 €
uni-directional, 433 MHz	70 710	43.00 €

PACKAGE

- Recess-mounted transmitter with battery
- Sales unit: 1 no.

FUNCTION / APPLICATION

- For cabling to standard push buttons/switches
- IMPULSE function for up to four receivers, ON/OFF function for up to two receivers
- Control of electric devices, e.g. lamps, fans etc. (in combination with the respective Multi-Bit receiver and external push button/switch)

TECHNICAL DETAILS / SPECIFICATIONS

Measurements (WxHxD)	36x30x10 mm
Battery type	CR 2032, 3 V
Protection category	IP 20
Range of temperature	-20 °C to +60 °C
Radio technology	Multi-Bit
Way of communication	uni-directional

Radio accessories Multi-Bit

Miscellaneous



Frequency detector

ARTICLE	ARTICLE NO.	PRICE EACH
Frequency detector	61 828	74.00 €

PACKAGE

- Frequency detector incl. battery
- Sales unit: 1 no.

FUNCTION / APPLICATION

- Identification of parasitic frequencies in the ranges of 868 MHz and 433 MHz

TECHNICAL DETAILS / SPECIFICATIONS

Measurements (WxHxD)	80x110x23 mm
Battery type	9 V block battery

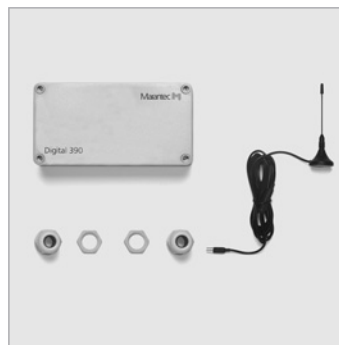

Digital 390

ARTICLE	ARTICLE NO.	PRICE EACH
Radio multiplexer uni-directional, 868 MHz	72 792	226.00 €

PACKAGE

- Radio multiplexer
- Magnet stand aerial
- Mounting material
- Sales unit: 1 no.

FUNCTION / APPLICATION

- Selective learning/deleting/blocking of up to 699 hand transmitter codes
- Reset of the complete memory
- Number code programmable
- History of the last 10 codes which have been sent
- Connection for additional devices by means of a programmable potential-free relay contact
- For the use in underground and collective garages

TECHNICAL DETAILS / SPECIFICATIONS

Measurements (WxHxD)	180x94x59 mm
Nominal voltage	230 V AC
Power consumption	approx. 13 mA
Protection category	IP 66
Range of temperature	-20 °C to +60 °C
Radio technology	Multi-Bit
Way of communication	uni-directional



Marantec Remote Management

ARTICLE	ARTICLE NO.	PRICE EACH
Hand transmitter registration	75 134	227.00 €

PACKAGE

- CD Rom
- Data management
- USB interface
- Programming cable
- Sales unit: 1 no.

FUNCTION / APPLICATION

- For registration, editing and transfer of hand transmitter codes

TECHNICAL DETAILS / SPECIFICATIONS

Measurements (WxHxD)	(data management) 57x28x18 mm
Length of USB cable	1,800 mm
Range of temperature	-20 °C to +60 °C
Radio technology	Multi-Bit

General accessories

Push buttons



Command 107

ARTICLE	ARTICLE NO.	PRICE EACH
Interior push button	100 768	13.00 €

PACKAGE

- Interior push button
- Connection cable, 9,000 mm
- Mounting material
- Sales unit: 1 no.

FUNCTION / APPLICATION

- 1 illuminated button with IMPULSE function
- 1 button for switching the holiday mode (hand transmitter rejection)
- 1 button for switching the opener lighting (ON/OFF)
- For the opener systems
Comfort 260, 270, 280, 360, 370, 380, 260 accu

TECHNICAL DETAILS / SPECIFICATIONS

Measurements (WxHxD)	74x125x17 mm
Protection category	IP 00 (only for dry premises)
Cabling	conventional



Command 108

ARTICLE	ARTICLE NO.	PRICE EACH
Hand programming device	101 159	49.00 €

PACKAGE

- Hand programming device with connection cable, 3,000 mm
- Sales unit: 1 no.

FUNCTION / APPLICATION

- Convenient programming and servicing
- Display and changing of all parameters in quick and special programming
- For the opener systems for garage doors
Comfort 260, 270, 280, 360, 370, 380
- For all opener systems for swing and sliding gates with the control units Control x.52, x.82

TECHNICAL DETAILS / SPECIFICATIONS

Measurements (WxHxD)	48x88x14 mm
Weight	0.08 kg
Cabling	system cabling MS-Bus

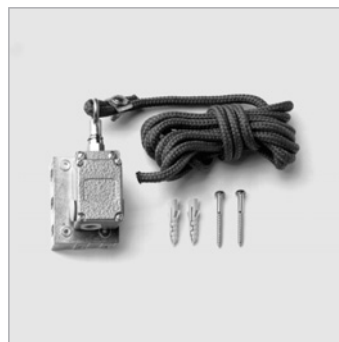
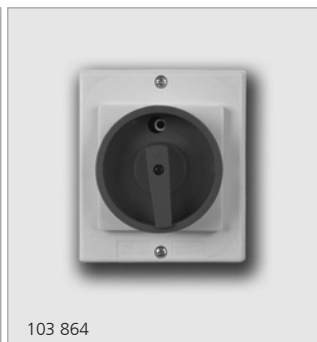

Emergency stop button, Main switch

ARTICLE	ARTICLE NO.	PRICE EACH
Emergency stop button	103 202	28.00 €
Main switch	103 864	75.00 €

PACKAGE

- Article no. 103 202:
- Emergency stop button
 - Sales unit: 1 no.
- Article no. 103 864:
- Main switch
 - Sales unit: 1 no.

FUNCTION / APPLICATION

- Article no. 103 202:
- For switching off the opener system in an emergency case
 - 1 normally closed contact
- Article no. 103 864:
- For switching off the opener system
 - 4-pole, 400 V/16 A

TECHNICAL DETAILS / SPECIFICATIONS

Measurements (WxHxD)	(103 202) 72x72x48 mm (103 864) 100x115x92 mm
Protection category	(103 202) IP 65 (103 864) IP 54
Cabling	conventional

Command 701

ARTICLE	ARTICLE NO.	PRICE EACH
Ceiling-mounted pull switch	151 050	71.00 €

PACKAGE

- Ceiling-mounted pull switch with pull rope, 3,500 mm
- Wall support
- Mounting material
- Sales unit: 1 no.

FUNCTION / APPLICATION

- Operation by pulling a rope
- IMPULSE function
- Wall or ceiling mounting
- For all opener systems with conventional cabling for push-buttons

TECHNICAL DETAILS / SPECIFICATIONS

Protection category	IP 65
Cabling	conventional

General accessories

Code keypads / Key switches

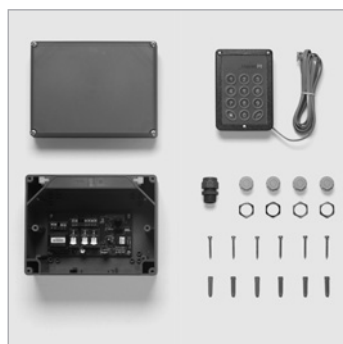

Command 202

ARTICLE	ARTICLE NO.	PRICE EACH
Code keypad 1-channel	70 955	203.00 €

PACKAGE

- Code keypad (exterior)
- Evaluation unit (interior)
- Connecting cable, 2,000 mm
- Mounting material
- Sales unit: 1 no.

FUNCTION / APPLICATION

- Operation by entering a code
- IMPULSE function
- STOP function
- 1 button for switching an external lighting (IMPULSE, ON/OFF or timer function 3 min)
- For all opener systems with conventional cabling for push-buttons

TECHNICAL DETAILS / SPECIFICATIONS

Measurements (WxHxD)	(code keypad) 90x130x12 mm (evaluation unit) 190x150x125 mm
Nominal voltage	230 V AC
Protection category	(code keypad) IP 65 (evaluation unit) IP 44
Cabling	(code keypad) system cabling (evaluation unit) conventional
Max. contact rating	(lighting) 230 V AC/60 W

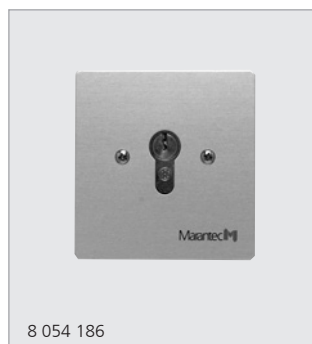

8 054 186



85 142

Command 314, 414

ARTICLE	ARTICLE NO.	PRICE EACH
Key switch		
Command 314, recess-mounted	8 054 186	42.00 €
Command 414, surface-mounted	85 142	52.00 €

PACKAGE

- Key switch with aluminium cover and installation box
- Connecting cable, 10,000 mm
- Profile half cylinder with 2 keys
- Mounting material
- Sales unit: 1 no.

FUNCTION / APPLICATION

- Operation by inserting and turning a key
- Two-sided key switch for operating up to 2 openers (IMPULSE) or 2 opener functions (OPEN/CLOSE)
- For all opener systems with conventional cabling for push buttons

TECHNICAL DETAILS / SPECIFICATIONS

Measurements Command 314:	
(WxH)	(front cover) 100x100 mm
(ØxD)	(housing) 60x70 mm
(ØxD)	(drill hole) approx. 65x75 mm
Measurements Command 414:	
(WxH)	(front cover) 80x80 mm
(WxHxD)	(housing) 84x84x70 mm
Protection category	IP 44
Cabling	conventional

General accessories

Key switches / Transponder systems



Command 312

ARTICLE	ARTICLE NO.	PRICE EACH
Key switch in post	152 832	179.00 €

PACKAGE

- Key switch in post
- Profile half cylinder with 2 keys
- Mounting material
- Sales unit: 1 no.

FUNCTION / APPLICATION

- Operation by inserting and turning a key
- Two-sided key switch for operating up to 2 openers (IMPULSE) or 2 opener functions (OPEN/CLOSE)
- For all opener systems with conventional cabling for push buttons

TECHNICAL DETAILS / SPECIFICATIONS

Measurements (WxHxD)	(housing) 100x1,090x120 mm
	(mounting area) 160x160 mm
Protection category	IP 44
Cabling	conventional

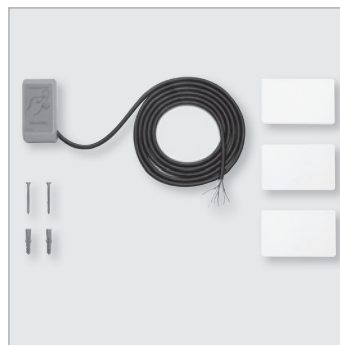

Command 802

ARTICLE	ARTICLE NO.	PRICE EACH
Transponder system	81 076	119.00 €

PACKAGE

- Reading module with integrated evaluation unit
- 3 transponder code cards
- Mounting material
- Sales unit: 1 no.

FUNCTION / APPLICATION

- Touchless operation by holding up a transponder to the reader
- 30 transponders can be stored
- IMPULSE or ON/OFF function selectable
- Selective programming and deleting of single transponders
- Connection for external push button
- For all opener systems with conventional cabling for push buttons

TECHNICAL DETAILS / SPECIFICATIONS

Measurements (WxHxD)	39x75x15 mm
Nominal voltage	24 V AC/DC
Power consumption	approx. 30 mA
Protection category	IP 54
Temperature range	-10 °C to +60 °C
Cabling	conventional
Reading module range	(code card) 70 mm
	(key ring) 50 mm

General accessories

Transponder systems



81 007

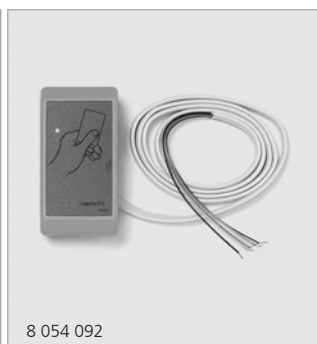

8 054 092

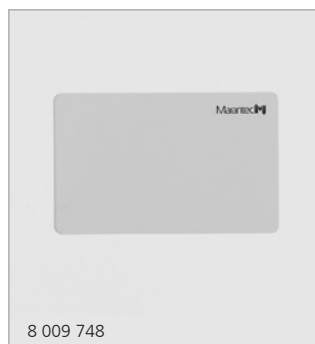

8 009 748



8 009 749

Command 812

ARTICLE	ARTICLE NO.	PRICE EACH
Transponder system	81 077	399.00 €
2nd reading module	8 054 092	131.00 €

PACKAGE

- Evaluation unit
- Reading module
- 3 transponder code cards
- Mounting material
- Sales unit: 1 no.

FUNCTION / APPLICATION

- Touchless operation by holding up a transponder to the reader
- 2.000 transponders can be stored
- IMPULSE or ON/OFF function selectable
- Usable as access control for 1 or 2 doors (2nd reading module necessary)
- Antipassback function selectable
- Selective programming and deleting of single transponders
- Emergency opening via external switch input
- Fire alarm input
- For all opener systems with conventional cabling for push buttons

TECHNICAL DETAILS / SPECIFICATIONS

Measurements (WxHxD)	(evaluation unit) 100x150x26 mm (reading module) 40x75x15 mm
Nominal voltage	24 V AC/DC
Protection category	(evaluation unit) IP 20 (reading module) IP 54
Temperature range	-10 °C to +60 °C
Cabling	conventional
Range	(code card) 70 mm (key ring) 50 mm

Transponder

ARTICLE	ARTICLE NO.	PRICE EACH
Transponder as code card	8 009 748	8.00 €
key ring	8 009 749	11.00 €

PACKAGE

- Article no. 8 009 748:
 - Transponder code card
 - Sales unit: 1 no.
- Article no. 8 009 749:
 - Transponder key ring
 - Sales unit: 1 no.

FUNCTION / APPLICATION

- For the operation of transponder systems

TECHNICAL DETAILS / SPECIFICATIONS

Measurements (WxHxD)	(code card) 85x54 mm (key ring) 33x43x4 mm
Weight	(code card) 0.006 kg (key ring) 0.008 kg

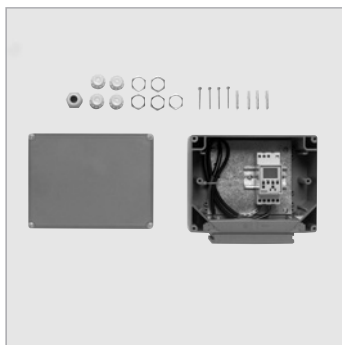

Week timer in housing

ARTICLE	ARTICLE NO.	PRICE EACH
Week timer in housing 1-channel	8 050 740	234.00 €

PACKAGE

- Week timer in housing
- Connection flange
- Mounting material
- Sales unit: 1 no.

FUNCTION / APPLICATION

- For keeping door or gate systems open by individually set times
- In combination with the programmable automatic closing timer of the opener systems

TECHNICAL DETAILS / SPECIFICATIONS

Measurements (WxHxD)	(housing) 196x150x124 mm
Nominal voltage	230 V AC
Protection category	IP 65
Cabling	conventional

General accessories

Induction loops



Control 403

ARTICLE	ARTICLE NO.	PRICE EACH
Loop detector for 2 loops without housing	104 057	263.00 €
in housing	104 058	311.00 €

PACKAGE

- Loop detector with 2 relay outputs
- Housing (104 058 only)
- Sales unit: 1 no.

FUNCTION / APPLICATION

- Touchless operation by driving over an induction loop
- Detection of the driving direction
- Automatic measurement and display of the loop inductivity
- Immediate fault detection on the illuminated LC-display
- Simple programming and simulation capability
- High operational safety even in case of power cuts for days
- Detection of vehicles with a max. speed of 50 km/h (with corresponding loop)
- For mounting on a DIN rail
- For all opener systems with conventional cabling for push-buttons

TECHNICAL DETAILS / SPECIFICATIONS

Measurements (WxHxD)	(104 057) 22.5x94x90 mm (104 058) 196x150x124 mm
Nominal voltage	100 to 240 V AC
Nominal frequency	50/60 Hz
Power consumption	0.023 to 0.012 A
Operation mode (duty cycle)	100 %
Protection category	(104 057) IP 20 (104 058) IP 65
Range of temperature	-20 °C to +60 °C
Loop inductivity	(max.) 20 to 1,000 µH (ideal) 80 to 300 µH
Cabling	conventional



Loop cable

ARTICLE	ARTICLE NO.	PRICE EACH
Loop cable	8 001 745	46.00 €

PACKAGE

- Loop cable type SIAF 1.5 mm², 50,000 mm
- Sales unit: 1 roll

FUNCTION / APPLICATION

- Specially insulated cable for underground applications
- Can be embedded with suitable sealing compound
- For loop detectors

TECHNICAL DETAILS / SPECIFICATIONS

Length	50,000 mm
Cabling	conventional



Control 950

ARTICLE	ARTICLE NO.	PRICE EACH
Signal light LED yellow without wall support	100 156	36.00 €
with wall support	100 157	43.00 €

PACKAGE

- Signal light incl. LED illuminant
- Mounting material
- Sales unit: 1 no.

FUNCTION / APPLICATION

- Signalling before or during the door travel
- Flashes or lights up – depending on the programming
- Energy-saving LED-technology
- Mounting of an external magnet stand aerial onto the wall bracket (100 157 only)

TECHNICAL DETAILS / SPECIFICATIONS

Measurements (ØxH)	(100 156) 65x85 mm
(WxHxD)	(100 157) 70x135x105 mm
Nominal voltage	18 to 30 V DC
Power consumption	0.12 A
Operation mode (duty cycle)	S2–5 min
Protection category	IP 54
Cabling	conventional
Illuminant	8-LED-module



Signal light 230 V

ARTICLE	ARTICLE NO.	PRICE EACH
Signal light yellow without wall support	81 917	36.00 €
with wall support	81 919	45.00 €

PACKAGE

- Signal light incl. illuminant
- Sales unit: 1 no.

FUNCTION / APPLICATION

- Signalling before or during the door travel
- Flashes or lights up – depending on the programming

TECHNICAL DETAILS / SPECIFICATIONS

Measurements (WxHxD)	(81 917) 57x82x36 mm
	(81 919) 57x98x68 mm
Nominal voltage	230 V AC
Protection category	IP 65
Cabling	conventional
Illuminant	7 W/B15d

General accessories

Signal lights



Light 100

ARTICLE	ARTICLE NO.	PRICE EACH
Traffic light LED		
Red	105 860	71.00 €
Yellow	105 863	71.00 €
Green	105 861	71.00 €

PACKAGE

- Traffic light pre-assembled and pre-cabled, 5,000 mm incl. LED illuminant
- Mounting material
- Sales unit: 1 no.

FUNCTION / APPLICATION

- Signalling before or during the door travel
- Flashes or lights up – depending on the programming
- Energy-saving LED-technology
- Rotatable by 180°

TECHNICAL DETAILS / SPECIFICATIONS

Measurements (WxHxD)	150x165x240 mm
(Ø)	130 mm
Nominal voltage	24 V DC
Power consumption	approx. 65 mA
Protection category	IP 65
Cabling	conventional
Illuminant	12-LED-module



Traffic light LED

ARTICLE	ARTICLE NO.	PRICE EACH
Traffic light LED		
Red	104 649	59.00 €
Yellow	104 651	59.00 €
Green	104 650	59.00 €

PACKAGE

- Traffic light unassembled
- LED illuminant
- Mounting material
- Sales unit: 1 no.

FUNCTION / APPLICATION

- Signalling before or during the door travel
- Flashes or lights up – depending on the programming
- Energy-saving LED-technology
- Rotatable by 180°

TECHNICAL DETAILS / SPECIFICATIONS

Measurements (WxHxD)	150x165x240 mm
(Ø)	130 mm
Nominal voltage	230 V AC
Protection category	IP 65
Cabling	conventional
Illuminant	3 W/E14
Beam angle	110°



Traffic light

ARTICLE	ARTICLE NO.	PRICE EACH
Traffic light, 1 bulb socket		
Red	104 646	41.00 €
Yellow	104 648	41.00 €
Green	104 647	41.00 €
Traffic light, 2 bulb sockets		
Red	104 652	43.00 €
Yellow	104 654	43.00 €
Green	104 653	43.00 €

PACKAGE

- Traffic light unassembled
- Illuminant
- Mounting material
- Sales unit: 1 no.

FUNCTION / APPLICATION

- Signalling before or during the door travel
- Flashes or lights up – depending on the programming
- Rotatable by 180°

TECHNICAL DETAILS / SPECIFICATIONS

Measurements (WxHxD)	150x165x240 mm
(Ø)	130 mm
Nominal voltage	230 V AC
Protection category	IP 65
Cabling	conventional
Illuminant	40 W/E14

General accessories

Photocells



Special 630 (Snapping)

ARTICLE	ARTICLE NO.	PRICE EACH
One-way photocell for door frame thickness 1 mm	86 424	47.00 €
for door frame thickness 2 mm	90 457	47.00 €

PACKAGE

- One-way photocell
- 2 connecting cables, 10,000 mm
- 4 cable connectors
- 2 snapping brackets
- Sales unit: 1 no.

FUNCTION / APPLICATION

- Optical safety device for protection against personal injuries and material damage
- If the light beam will be interrupted in direction CLOSE the opener system stops and reverses
- Fastening by snapping into the door frame (requirement: cut-out 8.4x80 mm)
- Function and pollution signalling by LED
- Photocell function for all Marantec opener systems
- Door frame function in combination with Marantec garage door openers

TECHNICAL DETAILS / SPECIFICATIONS

Measurements (WxHxD)	39x85x19 mm
Nominal voltage	24 V DC
Protection category	IP 54
Cabling	unipolar 2-wire technique
Range	8 m

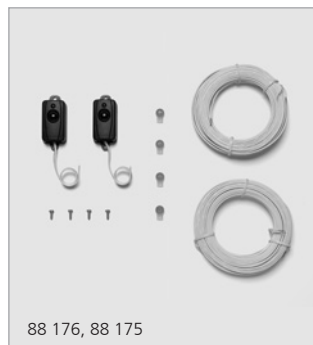

Special 630 (screwing)

ARTICLE	ARTICLE NO.	PRICE EACH
One-way photocell	88 176	47.00 €
Mounting bracket set	88 175	11.00 €

PACKAGE

- Article no. 88 176:
- One-way photocell
 - 2 connecting cables, 10,000 mm
 - 4 cable connectors
 - Mounting material
 - Sales unit: 1 no.

- Article no. 88 175:
- 2 mounting brackets
 - 2 snapping brackets
 - Mounting material
 - Sales unit: 1 no.

FUNCTION / APPLICATION

- Optical safety device for protection against personal injuries and material damage
- If the light beam will be interrupted in direction CLOSE the opener system stops and reverses
- Fastening by screwing
- Function and pollution signalling by LED
- Photocell function for all Marantec opener systems
- Door frame function in combination with Marantec garage door openers

TECHNICAL DETAILS / SPECIFICATIONS

Measurements (WxHxD)	39x85x19 mm
Nominal voltage	24 V DC
Protection category	IP 54
Cabling	unipolar 2-wire technique
Range	8 m

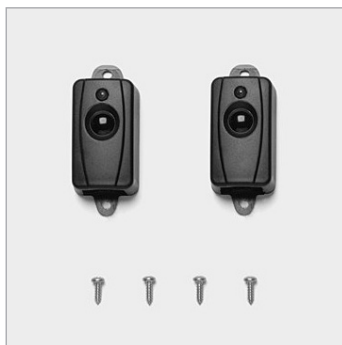

Special 630 R

ARTICLE	ARTICLE NO.	PRICE EACH
One-way photocell	118 811	49.00 €

PACKAGE

- One-way photocell
- Mounting material
- Sales unit: 1 no.

FUNCTION / APPLICATION

- Optical safety device for protection against personal injuries and material damage
- If the light beam will be interrupted in direction CLOSE the opener system stops and reverses
- Fastening by screwing
- Function and pollution signalling by LED
- Connection for a 2nd photocell by using series connection (2-channel operation)
- Adjustment of the range by setting a jumper
- Test function for testing the photocell
- Photocell function for all Marantec opener systems and other's opener systems

TECHNICAL DETAILS / SPECIFICATIONS

Measurements (WxHxD)	39x85x19 mm
Nominal voltage	12 to 24 V DC
Power consumption	max. 40 mA
Protection category	IP 54
Outputs	1 potential-free relay contact
Max. contact rating	30 V AC/0.3 A 30 V DC/0.3 A
Cabling	conventional
Range	8 m 5 to 20 m



Special 633, 633 L

ARTICLE	ARTICLE NO.	PRICE EACH
Special 633 One-way photocell without connecting cable	96 986	58.00 €
with connecting cable, 20,000 mm	96 984	66.00 €
Special 633 L One-way photocell without connecting cable	101 188	62.00 €
with connecting cable, 20,000 mm	101 182	71.00 €

PACKAGE

- One-way photocell
- 2 housings
- Connecting cable (depending on version)
- Mounting material
- Sales unit: 1 no.

FUNCTION / APPLICATION

- Optical safety device for protection against personal injuries and material damage
- If the light beam will be interrupted in direction CLOSE the opener system stops and reverses
- Fastening by screwing
- Horizontal adjustment of the light beam for more than 180°
- Function and pollution signalling by LED
- Photocell function for all Marantec opener systems

TECHNICAL DETAILS / SPECIFICATIONS

Measurements (WxHxD)	38x110x38 mm
Nominal voltage	24 V DC
Protection category	IP 65
Cabling	unipolar 2-wire technique
Range	(Special 633) 8 m (Special 633 L) 5 to 20 m

General accessories

Photocells



Special 633 R

ARTICLE	ARTICLE NO.	PRICE EACH
One-way photocell	101 197	60.00 €

PACKAGE

- One-way photocell
- 2 housings
- Mounting material
- Sales unit: 1 no.

FUNCTION / APPLICATION

- Optical safety device for protection against personal injuries and material damage
- If the light beam will be interrupted in direction CLOSE the opener system stops and reverses
- Fastening by screwing
- Horizontal adjustment of the light beam for more than 180°
- Function and pollution signalling by LED
- Connection for a 2nd photocell by using series connection (2-channel operation)
- Adjustment of the range by setting a jumper
- Test function for testing the photocell
- Photocell function for all Marantec opener systems and other's opener systems

TECHNICAL DETAILS / SPECIFICATIONS

Measurements (WxHxD)	38x110x38 mm
Nominal voltage	12 to 24 V DC
Power consumption	max. 40 mA
Protection category	IP 65
Outputs	1 potential-free relay contact
Max. contact rating	30 V AC/0.3 A 30 V DC/0.3 A
Cabling	conventional
Range	8 m 5 to 20 m



Protective covers Special 633

ARTICLE	ARTICLE NO.	PRICE EACH
Protective covers	104 186	18.00 €

PACKAGE

- 2 protective covers
- Mounting material
- Sales unit: 1 no.

FUNCTION / APPLICATION

- Protection for the photocell against vandalism and weather
- Fastening by screwing
- For the photocells Special 633, 633 L, 633 R

TECHNICAL DETAILS / SPECIFICATIONS

Measurements (WxHxD)	52x170x52 mm
Material	aluminium alloy



Special 635

ARTICLE	ARTICLE NO.	PRICE EACH
Two-way photocell	101 190	98.00 €

PACKAGE

- Two-way photocell incl. 2 batteries
- 2 housings
- Mounting material
- Sales unit: 1 no.

FUNCTION / APPLICATION

- Optical safety device for protection against personal injuries and material damage
- If the light beam will be interrupted in direction CLOSE the opener system stops and reverses
- Fastening by screwing
- Horizontal adjustment of the light beam for more than 180°
- Function and pollution signalling by LED
- Supply of the base unit by wire and of the satellite unit by standard batteries
- Service life (satellite) at an ambient temperature of +20°C - approx. 2 years at max. 6 cycles within 1 day
- Connection for a contact bar 8.2 kΩ at the satellite, e.g. main closing edge of a sliding gate
- Photocell function for all Marantec opener systems and other's opener systems

TECHNICAL DETAILS / SPECIFICATIONS

Measurements (WxHxD)	46x160x46 mm
Nominal voltage	(base) 12 to 24 V DC
Power consumption	(base) approx. 25 mA
Protection category	IP 65
Battery type	(satellite) AA, 1.5 V
Outputs	(satellite) 1 potential-free relay contact 30 V AC/0.3 A 30 V DC/0.3 A
Cabling	(base) unipolar 2-wire technique or conventional
Range	8 m



Special 613-2

ARTICLE	ARTICLE NO.	PRICE EACH
Reflection photocell	85 295	97.00 €
Mounting bracket set	85 314	24.00 €

PACKAGE

- Article no. 85 295:
- Reflection photocell
 - Connecting cable, 7,500 mm
 - Mounting material
 - Sales unit: 1 no.

- Article no. 85 314:
- Mounting bracket
 - Mounting material
 - Sales unit: 1 no.

FUNCTION / APPLICATION

- Optical safety device for protection against personal injuries and material damage
- If the light beam will be interrupted in direction CLOSE the opener system stops and reverses
- Function and pollution signalling by LED
- Photocell function for all Marantec opener systems

TECHNICAL DETAILS / SPECIFICATIONS

Measurements (WxHxD)	59x96x55 mm
Nominal voltage	24 V DC
Protection category	IP 65
Cabling	unipolar 2-wire technique
Range	8 m

General accessories

Photocells



85 297, 85 300



85 315



Special 614-2, 624-2

ARTICLE	ARTICLE NO.	PRICE EACH
Special 614-2 One-way photocell	85 297	97.00 €
Special 624-2 One-way photocell	85 300	97.00 €
Mounting bracket set	85 315	36.00 €

PACKAGE

- Article no. 85 297, 85 300:
- One-way photocell
 - Connecting cable, 20,000 mm
 - Mounting material
 - Sales unit: 1 no.

- Article no. 85 315:
- 2 mounting brackets
 - Mounting material
 - Sales unit: 1 no.

FUNCTION / APPLICATION

- Optical safety device for protection against personal injuries and material damage
- If the light beam will be interrupted in direction CLOSE the opener system stops and reverses
- Function and pollution signalling by LED
- Photocell function for all Marantec opener systems

TECHNICAL DETAILS / SPECIFICATIONS

Measurements (WxHxD)	59x96x35 mm
Nominal voltage	24 V DC
Protection category	IP 65
Cabling	unipolar 2-wire technique
Range	(Special 614-2) 8 m (Special 624-2) 5 to 14 m

Special 670

ARTICLE	ARTICLE NO.	PRICE EACH
Photocell expander	97 559	30.00 €

PACKAGE

- Photocell expander
- Sales unit: 1 no.

FUNCTION / APPLICATION

- Expansion unit for a second photocell
- For the connection of two photocells to one photocell exit

TECHNICAL DETAILS / SPECIFICATIONS

Measurements (WxHxD)	70x64x35 mm
Nominal voltage	12 to 24 V DC
Protection category	IP 20
Temperature range	-20 °C to +60 °C
Cabling	unipolar 2-wire technique

Sales Conditions and Terms of Delivery (valid from 11. August 2011)

§ 1 General Provisions

- Our terms of delivery vis-à-vis entrepreneurs shall be solely governed by the conditions hereunder. They are solely applicable. General Terms and Conditions which contradict or deviate from our terms of delivery shall not be recognised by us even if, despite this knowledge, there is no explicit contradiction and/or the delivery is executed without any reservation. At the latest with unreserved acceptance of our deliveries, the Purchaser shall accept our terms of delivery, unless he has submitted prior contradiction in writing.
- An entrepreneur – hereinafter referred to as Purchaser – is a natural or legal entity or a partnership in practice of their commercial or independent professional activities upon conclusion of a legal transaction.
- The terms of delivery uniquely apply between the Supplier and the Purchaser in conjunction with the Supplies and/or Services of the Supplier (hereinafter: Supplies); they shall also be applicable to all future Supplies. Any terms or conditions of the Supplier to the contrary that may have applied in the past hereby lose their validity.

§ 2 Offer, conclusion of contract and contract contents

- Our offers are subject to change. We can accept contract offers within four weeks.
- With the order, the Purchaser makes a binding statement that he wants to acquire the items which have been ordered.
- Technical particulars in words, figures, illustrations or images, e.g. in respect of the weight, measurements and performance of our products in brochures, publications and offers are, unless expressly stated otherwise, only approximate values. In particular, deviations based on changes in construction are reserved.
- The Supplier herewith reserves any industrial property rights and/or copyrights pertaining to its cost estimates, drawings and other documents (hereinafter referred to as "Documents"). The Documents shall not be made accessible to third parties without the Supplier's prior consent and shall, upon request, be returned without undue delay to the Supplier if the contract is not awarded to the Supplier.
- The contract shall be concluded by our written order confirmation and only with this content. Our written order confirmation alone is also definitive for the scope of the delivery. However, we are not obligated by any type of obvious written, computer or printing errors in the order confirmation.
- Partial deliveries are allowed, unless they are unreasonable to accept for the Purchaser.

§ 3 Prices and terms of payment

- Prices are ex works or ex stock plus the statutory value added tax. The prices are inclusive of packaging and freight costs with the exception of individual parts and spare parts in post or parcel delivery.
- Expenses that occur as a result of changes in the nature and scope of the delivery at the request of the Purchaser after our order confirmation and/or that arise due to the performance of supplemental or non-foreseeable official restrictions and requirements, shall also be separately invoiced at the offered purchase price.
- If increases in the cost of materials occur after the offer has been submitted or if taxes or levies are increased, then the Supplier is entitled to adjust his prices accordingly.
- If the Supplier is responsible for assembly and nothing else has been agreed, then the Purchaser shall bear the requisite secondary costs as well the agreed upon fees such as travel and transport costs.
- Cash discount requires specific written agreement.
- Unless otherwise agreed, the purchase price is due to be paid without deduction within 30 days from the invoicing. Otherwise the statutory payment default regulations shall apply.
- Payment orders, cheques or bills of exchange shall only be accepted subject to special agreement and only on account of payment but not instead of payment. The costs for bills, discounting and collection shall be borne by the Purchaser.
- The Purchaser may set off only those claims that are undisputed or against which no legal recourse is possible.
- Possibly discount and rebate agreement will result in reductions of payment.

§ 4 Periods of delivery

- The periods of delivery specified by the Supplier are calculated from the day of the technical clarification of the order (final clarification, e.g. of dimensions, accessory parts and special equipment) until the day of readiness or completion. The delivery periods and deadlines specified by the Supplier are non-binding, as long as they have not been expressly agreed as binding in writing.
- Times set for Supplies can only be observed if all documents to be supplied by the Purchaser, necessary permits and releases, especially concerning drawings, are received in time and if agreed terms of payment and other obligations of the Purchaser are fulfilled. Unless these conditions are fulfilled in time, times set shall be extended appropriately; this shall not apply where the Supplier is responsible for the delay.
- In the event of delivery delays due to force majeure and due to events which significantly impede delivery or make delivery impossible by the Supplier (particularly difficulties procuring materials, malfunctions, strikes, lock-out, regulatory action, etc.) for which the Supplier is not responsible, the Supplier shall be entitled to make delivery only after this problem has been rectified, even they happen to the Supplier's vendors or subcontractors, with an appropriate delay in the start-up time or shall be entitled to partially or completely withdraw from the not fulfilled part of the contract. In the event of such a withdrawal by the Purchaser, then he shall not be granted any claims for damages.
- The Purchaser can only set a period of grace for delivery/service, if the confirmed date of delivery has been exceeded by more than three weeks. This period of grace must be reasonable and amount to at least three weeks. Upon unsuccessful expiration of the period of grace, the Purchaser can withdraw from the contract. Claims for damages are excluded. This shall not apply if, in cases of intent, gross negligence or due to the injury to the life, body or health of a person or liability imperatively occurs in accordance with the Product Liability Act.
- The purchaser is obliged, upon request of the supplier, to declare within a reasonable term whether he withdraws from the said contract because of delay in delivery or insists on delivery.

§ 5 Passing of risk

- Delivery is made "ex works".
- The risk of accidental perishing and of accidental deterioration of goods passes to the Purchaser upon hand-over, in the case of contracts which provide for delivery by carrier upon handing over the goods to the haulage contractor.
- If the Purchaser is in default of acceptance, then the risk of accidental perishing and of accidental deterioration of goods passes to the Purchaser from the day of readiness for dispatch. Any storage costs incurred are to be borne by the Purchaser.
- The afore-mentioned provisions 1. – 3. shall also apply to partial deliveries.
- In the case of freight-less delivery, the means of transportation must be promptly unloaded by the Purchaser. Waiting times are to be borne by the Purchaser. Unloading inclusive of transportation to site of use or storage is the responsibility of the Purchaser who, in case of default, shall bear the costs and the danger of unloading, stacking, storing and/or return transportation. The recipient acting on behalf of the Purchaser at the site of unloading shall be authorised to accept the loading in a binding manner.

§ 6 Retention of title

- The delivered items (retained items) shall remain the property of the Supplier until all claims and demands have been fulfilled, irrespective of the legal grounds. If the combined value of the security interests of the Supplier exceeds the value of all secured claims by more than 10%, the Supplier shall release a corresponding part of the security interest if so requested by the Purchaser; the Supplier shall have the choice between various security interests at the time of release.

- The purchaser shall be entitled to resell the items delivered under retention of title in the course of ordinary business dealings subject to revocation at any time and as long as he does not default on payments. Our authorisation to collect the payment itself remains unaffected. Pledging them or using them as security singly or in the aggregate without the express written consent of the Supplier is not permitted, as long as the Supplier is still in possession of retention of title.
- If the Purchaser resells the retained goods, the Purchaser shall relinquish forthwith to the Supplier any future claims from the resale to its customers, together with all accessory rights – including any payment balance requests – without the requirement to issue any further declarations. If the Retained Goods are resold together with other items without a single price being agreed for the Retained Goods, the Purchaser shall relinquish to the Supplier that part of the total price requested that corresponds to the retained goods price invoiced by the Supplier.
- The Purchaser shall be entitled to process the Retained Goods or mix or combine them with other items. The processing activities shall be performed for the Supplier. The Purchaser shall keep the resulting new item for the Supplier with the due care and diligence of a proper businessman. The new item shall be deemed to be Retained Goods.
- The Supplier and Purchaser shall agree that if the Retained Goods are combined or mixed with other objects that do not belong to the Supplier, that the Supplier shall be awarded co-ownership in the new object at the proportionate amount which results from the ratio of the value of the combined or mixed Retained Goods to the value of the remaining goods at the date of performing any processing activities. The new item shall thus be deemed as Retained Goods.
- The Purchaser must provide for safe and proper storage of the objects in our possession and to insure them at his own expense against theft, fire and other damages. If the Purchaser raises claims against the insurer or other another third party due to damage, impairment, loss or decay of the item under retention or for other reasons, these claims shall be assigned with all ancillary rights in advance to the Supplier.
- The provision concerning the relinquishing of claims in accordance with No. 3 shall also apply to the new item. The relinquishing, however, only applies up to the value of the amount corresponding to the value of processed, combined or mixed Retained Goods that were invoiced by the Supplier.
- Subject to revocation at any time, the Purchaser is authorised to collect assigned claims arising from the resale. The Supplier is entitled to revoke the Purchaser's authorisation for the collection of claims if there is an important and sound reason to do so, in particular with regard to default in payment, suspension of payment, the petition to institute insolvency proceedings, the protest of bills, or in the event of substantiated indications of over-indebtedness or imminent insolvency on the part of the Purchaser. After prior warning – under observance of an adequate deadline – the Supplier, in addition, may disclose the assignment of securities, may utilise the assigned claims and may demand the Purchaser's disclosure of the assignment of security towards the customer.
- The Purchaser shall notify the Supplier forthwith of any pledges, seizures or other alienation or act of intervention by third parties. Should an authorised interest be substantiated, the Purchaser shall provide the Supplier with the required information and the required documents in order to assert a claim of the Suppliers rights. Furthermore, he must do everything to prevent compulsory enforcement from taking place.
- In the case of non-performance of contractual obligations by the Purchaser, especially with respect to default in payment, the Supplier shall be entitled to withdraw from the contract and to take back the Retained Goods. For the purpose of taking back the goods, the Purchaser allows the Supplier irrevocably to enter his business premises and warehouses unimpeded and to take the goods.

§ 7 Claims for defects

- The warranty rights of the Purchaser are conditional on the Buyer having duly performed the requisite duties of examination and notification of defects under Section 377 of the German Commercial Code (Handelsgesetzbuch). The Supplier must be notified in writing without undue delay specifically in respect of the nature and scope of any defects. The item is deemed approved if claims are not made in time or in the appropriate form. The Purchaser may not refuse to receive supplies due to minor defects.
- The Supplier is entitled, at his own choice, to supplement the performance in the form of a remedying of defects or by providing a replacement supply.
- Only the product description/order confirmation of the manufacturer is considered, in principle, to be agreed as the condition of the item purchased. Public statements, claims extolling its virtues or advertising by the manufacturer do not constitute any contractual representation as to the condition of the goods. Confirmation of its features requires an express written statement by the Supplier which goes beyond a mere description of the item.
- There shall be no claims based on Defect in cases of insignificant deviations from the agreed quality, of only minor impairment of usefulness, of non-reproducible software errors, of natural wear and tear or damage arising after the transfer of risk from faulty assembly or putting into service by the Purchaser to a third party or negligent handling, especially excessive strain, unsuitable equipment, chemical influence, or repairs to the delivered item by the Purchaser or a third party.
- The Supplier shall be liable subject to the statutory provisions, if the Purchaser asserts claims for damages that are based on intention or gross negligence or are based on the intention or gross negligence of an agent or vicarious agent of the Supplier. The liability of the Supplier for culpable injuries to the life, body or health of a person inclusive of their death and the imperative liability in accordance with the Product Liability Act shall not be affected.
- Claims for repair or replacement are subject to a statute of limitations of 12 months calculated from the start of the statutory statute of limitations; the same shall apply mutatis mutandis in the case of rescission and reduction. This shall not apply where longer periods are prescribed by law according to Sec. 438 para. 1 No. 2 (buildings and things used for building), Sec. 479 para. 1 (right of recourse). The same applies to the statute of limitations of claims for damages. In the case of claims for damages in accordance with the Product Liability Act, the statutory statute of limitations applies.
- The Purchaser's right of recourse against the Supplier pursuant to Sec. 478 BGB (recourse of the entrepreneur) is limited to cases where the Purchaser has not concluded an agreement with its customers exceeding the scope of the statutory provisions governing claims based on Defects. Moreover, No. 8 above shall apply mutatis mutandis to the scope of the right of recourse the Purchaser has against the Supplier pursuant to Sec. 478 para. 2 BGB.
- In addition, the Purchaser is not entitled to assign claims due to defects.
- By negotiating over complaints in relation to defects, the Supplier does not waive the objection that the complaints were not made in due time and/or to a sufficient degree. Those responsible for examining the defects are not entitled to confirm defects with effect against the Supplier.

§ 8 Other claims / statute of limitations

- The Purchaser has no claim for damages against the Supplier or his performing or vicarious agents based on whatever legal reason, including infringement of duties arising in connection with the contract or tort. We are therefore not liable for damages that have not been inflicted on the object of supply and for a loss in profit or other damages to Purchaser assets, e.g. for expenses necessary for purposes of supplementary performance.
- Liability due to culpable injury of life, body or health of a person inclusive of their death shall likewise remain unaffected as the provisions in respect of product liability law.

§ 9 Final provisions

- Legal relations and agreements existing in connection with this contract shall be governed by German substantive law, to the exclusion of the United Nations Convention on contracts for the International Sale of Goods (CISG).
- Any additional agreements and amendments require the written confirmation by the Supplier. This also applies in respect of any change in the written requirement.
- Sole venue for all disputes arising directly or indirectly out of the contract shall be the Supplier's place of business. However, the Supplier may also bring an action at the Purchaser's place of business.
- The legal invalidity of one or more provisions of this Agreement in no way affects the validity of the remaining provisions. This shall not apply if it would be unreasonable for one of the parties to be obligated to continue the contract.
- In case of litigation, the German version of these terms of delivery shall prevail.